



INSTRUCTIONS

-J01360

REV. 6-27-03

Kit Number 71514-98

CHROME IGNITION SWITCH COVER

General

This kit is designed for installation on 1995 to 2003 XL (Sportster®) model motorcycles.

Installation

1. See Figure 1. Remove ignition switch face nut. Remove throttle cables from clip on underside of existing ignition switch cover.
2. Remove front mounting bolt on fuel tank.
3. Remove ignition cover mounting screw and remove ignition switch cover.
4. Place chrome ignition switch cover in position and install original mounting screw. Tighten screw to 3-7 ft-lbs (4-9 Nm).
5. Reinstall front mounting bolt on fuel tank. Tighten bolt to 8-16 ft-lbs (11-22 Nm).
6. Tighten face nut to secure switch within cover. Place throttle cables into clip on underside of switch cover.

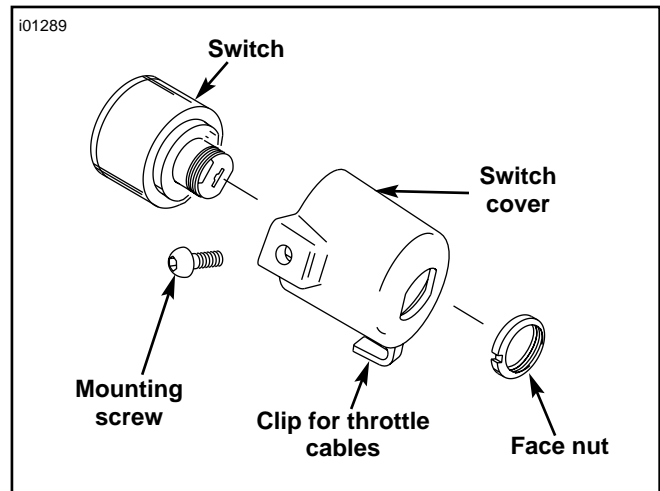

Figure 1.



INSTRUCTIONS

-J01360

REV. 6-27-03

Kit Number 71514-98

CHROME IGNITION SWITCH COVER

General

This kit is designed for installation on 1995 to 2003 XL (Sportster®) model motorcycles.

Installation

1. See Figure 1. Remove ignition switch face nut. Remove throttle cables from clip on underside of existing ignition switch cover.
2. Remove front mounting bolt on fuel tank.
3. Remove ignition cover mounting screw and remove ignition switch cover.
4. Place chrome ignition switch cover in position and install original mounting screw. Tighten screw to 3-7 ft-lbs (4-9 Nm).
5. Reinstall front mounting bolt on fuel tank. Tighten bolt to 8-16 ft-lbs (11-22 Nm).
6. Tighten face nut to secure switch within cover. Place throttle cables into clip on underside of switch cover.

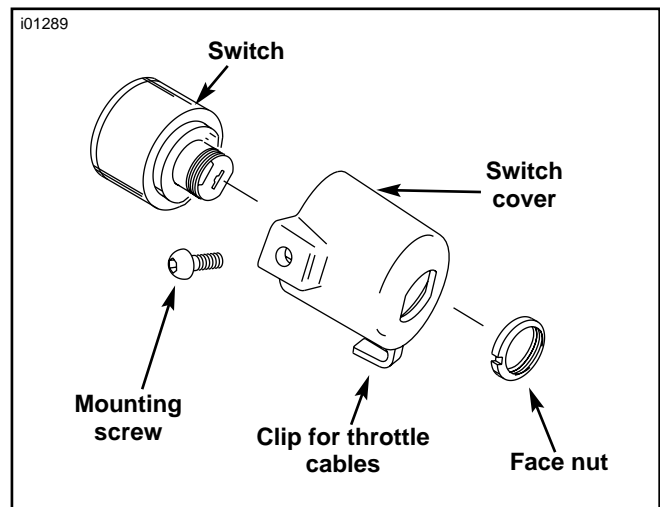

Figure 1.