

## PART NUMBER

92050-62

REV. 3-63

## INSTRUCTIONS

HARLEY-DAVIDSON MOTOR CO., MILWAUKEE 1, WISCONSIN U. S. A.

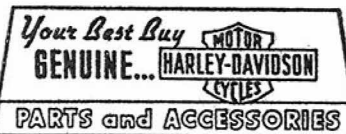
TACHOMETER - SPORTSTER XLCH

(Tachometer will fit only late type magneto having tachometer drive)

<u>Item</u>	<u>Description</u>	<u>Item</u>	<u>Description</u>
1.	Mounting Bracket (1): Mounted on handlebar clamp cover above speedometer bracket.	6.	Drive Cable (1): Routed from tachometer head to magneto.
2.	Grommets (2): Used for mounting tachometer head to bracket.	7.	Clips (2): Used to clip tachometer cable to speedometer cable.
3.	Spacers (2): Inserted into grommets.	8.	O-Ring (1): Used on magneto end of drive cable.
4.	Tachometer Head (1): Mounted on bracket.	9.	Driven Gear and Shaft (1): Mounted on magneto.
5.	1/4" Washers (2): Used for mounting tachometer head.	10.	Thrust Washer (1): Installed on driven gear shaft.

Remove the two bolts and washers which mount the speedometer bracket on the handlebar clamp and cover. Install the tachometer head mounting bracket (item 1) on top of the speedometer bracket as shown in the illustration and secure with the bolts and washers previously removed.

Insert the two grommets (item 2) into the 7/16" holes in the bracket. Moisten the two spacers (item 3) and press them into the grommets. Remove the two nuts and lockwashers from the tachometer head mounting studs. Install head and secure with nuts, lockwashers and plain washers (item 5) as shown in the illustration.

Attach the tachometer drive cable (item 6) loosely. Route the cable through the notch in the headlamp housing and follow the speedometer cable down along the right fork tube. Join the two cables with the clips (item 7) and run cable behind the front exhaust pipe and back to the magneto.

Remove the hairpin-type retainer from the clevis pin by inserting a pencil or other thin object through the loop end and pulling. Remove the clevis pin and the tachometer plug from tachometer drive housing. The plug will no longer be used. Install O-ring (item 8) around housing at end of drive cable.

**IMPORTANT:** Fill tachometer drive housing hole with Harley-Davidson Grease-All grease. Also see that cable hole is filled with grease.

Install thin thrust washer (item 10) on driven gear shaft (item 9).

Install gear and shaft in the cable. Insert the drive cable to engage the gear shaft. Replace the clevis pin and hairpin retainer. Tighten the other end of the drive cable on the tachometer head.

**IMPORTANT:** After installation and before operating motorcycle, be sure that cable housing has no sharp bends or kinks. Straighten if necessary.

LUBRICATION INSTRUCTIONS

Remove drive shaft at magneto and fill drive shaft housing with grease every 2,000 miles. Also remove housing and fill cable end hole with grease.

(over)

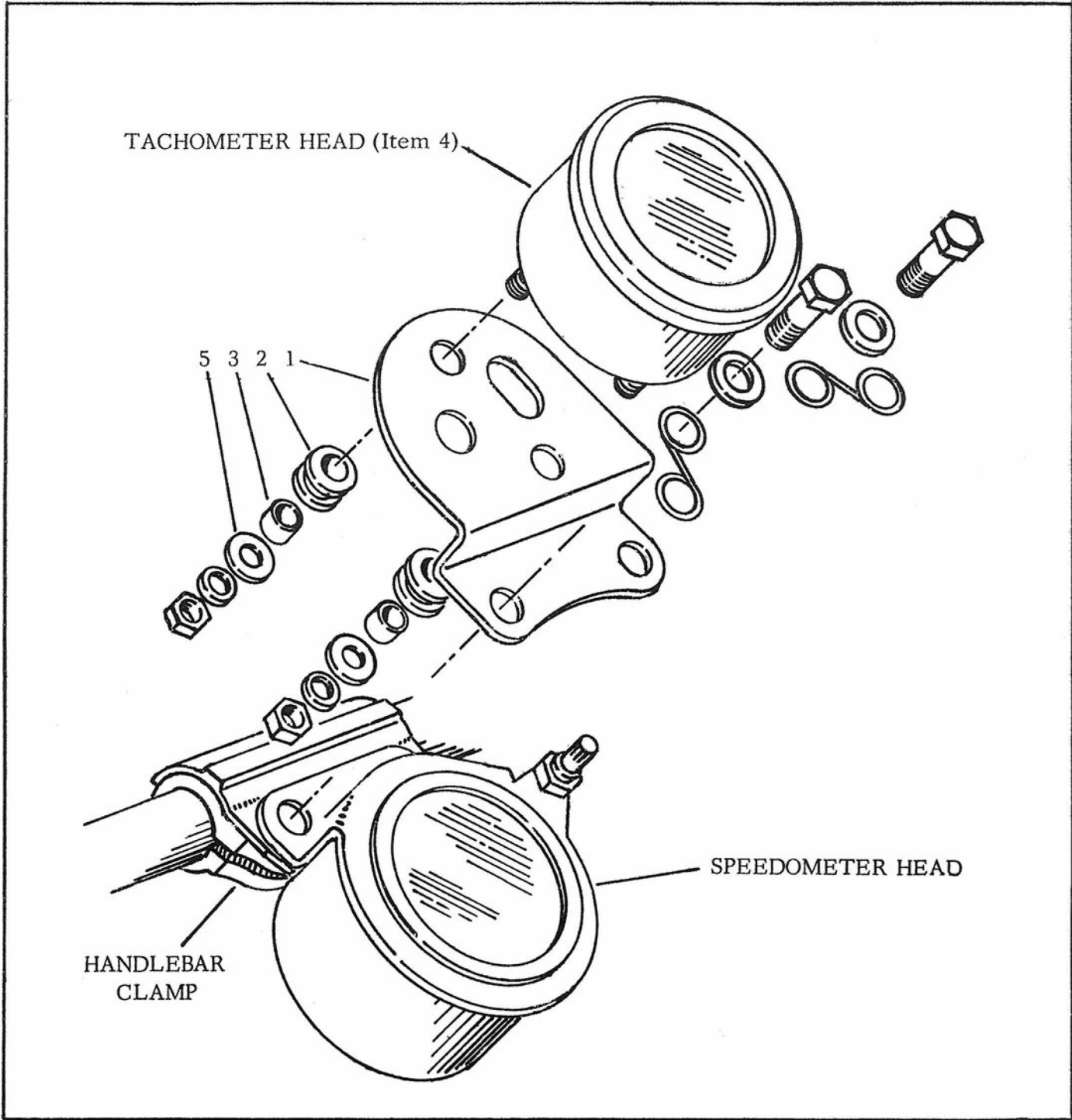

TACHOMETER INSTALLATION