



INSTRUCTIONS

-J06257

2015-08-01

DERBY COVER KIT

GENERAL

Kit Number

25700623

Models

For model fitment information, see the P&A Retail Catalog or the Parts and Accessories section of www.harley-davidson.com (English only).

Kit Contents

There are no Service Parts available for this kit.

Installation Requirements

Separate purchase of LOCTITE® 243 Threadlocker and Sealant (Blue) is required for proper installation of this kit. LOCTITE can be purchased from any Harley-Davidson Dealer.

▲ WARNING

Rider and passenger safety depend upon the correct installation of this kit. Use the appropriate service manual procedures. If the procedure is not within your capabilities or you do not have the correct tools, have a Harley-Davidson dealer perform the installation. Improper installation of this kit could result in death or serious injury. (00333b)

NOTE

This instruction sheet references service manual information. A service manual for your model motorcycle is required for this installation and is available from a Harley-Davidson Dealer.

INSTALLATION

NOTE

On models without forward controls, it may be necessary to remove the left footpeg for removal and assembly of the derby cover.

1. See Figure 1. Remove the existing screws and washers (1) that secure the clutch inspection (derby) cover. Retain screws and washers. Remove and discard the original cover (2).
2. Wipe groove on mating cover clean of any excess oil or debris.
3. Inspect O-ring (25463-94A) for damage. If needed, replace if necessary.
4. Apply a couple of drops of Loctite 243 to the threads of the cap screws and install the new cover with the screws and flat washers.

5. Tighten screws in a cross-wise pattern. **2004-2010 Models** tighten to 9.5–12.2 N·m (84–108 in-lbs). **2011 and Later Models** tighten to 10.2–13.6 N·m (90–120 in-lbs).

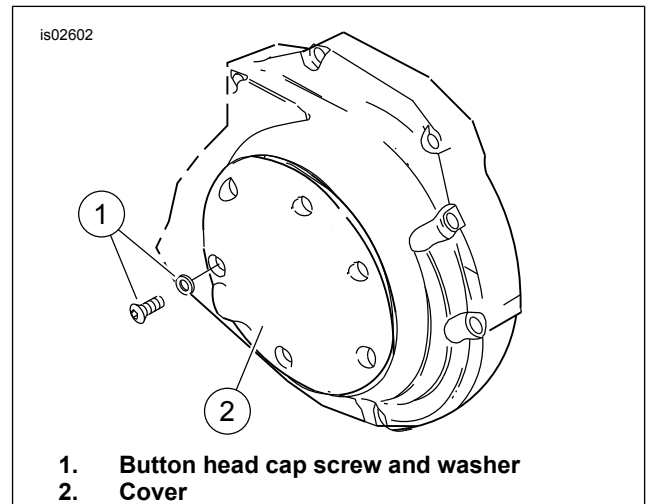

Figure 1. Original Equipment Derby Cover

SPECIAL CARE INSTRUCTIONS

NOTE

To prevent damage to the cover surface, do not use any detergents, chemical solvents, polishes or abrasive cleaning agents.

To keep this surface in best condition, lightly wipe with a Harley-Davidson Micro Fiber cloth (94663-02), using clear water or a mild Harley-Davidson cleaner such as:

- Sunwash (94659-98)
- Bug Remover (94657-98)
- Harley Gloss (94627-98).

NOTE

These cleaners are available separately or as part of the Harley Care Starter Kit (94671-99A) and are available from your Harley Davidson Dealer.

