



# INSTRUCTIONS

-J06161

2015-08-24

## ENGINE GUARD KIT

### GENERAL

#### Kit Number

49000103

#### Models

For model fitment information, see the P&A retail catalog or the Parts and Accessories section of [www.harley-davidson.com](http://www.harley-davidson.com) (English only).

#### Installation Requirements

##### ▲ WARNING

Rider and passenger safety depend upon the correct installation of this kit. Use the appropriate service manual procedures. If the procedure is not within your capabilities or you do not have the correct tools, have a Harley-Davidson dealer perform the installation. Improper installation of this kit could result in death or serious injury. (00333b)

##### NOTE

*This instruction sheet refers to service manual information. A service manual for this year/model motorcycle is available from a Harley-Davidson dealer.*

#### Kit Contents

See Figure 1 and Table 1.

#### PREPARATION

1. See the service manual. Remove main fuse.
2. See the service manual and remove front upper engine mount screws (two each side) and nut plate assemblies. Discard hardware.

##### NOTE

*Left engine mount screws also secure horn bracket on some models.*

3. Remove existing engine guard, if equipped.

#### INSTALLATION

##### NOTE

- Do not tighten hardware until all hardware is installed.
- Do not damage wiring when securing upper guard brackets.

1. See Figure 1. Secure right guard and engine mount using the hardware (3, 4, 9) provided.
2. Secure upper guard bracket to frame with hardware (5, 6).
3. Secure left guard and engine mount using the hardware provided: **Vehicles with horn mounted on left side engine mount:** Secure left guard using hardware (4, 7, 8). Install short spacer (8) between horn bracket and engine guard. **Vehicles with horn mounted behind radiator:** Secure left guard using hardware (4, 7, 9) install long spacer between frame and engine guard.
4. Secure upper guard bracket to frame with hardware (5, 6).
5. Tighten the upper hardware (5, 6) to 27.1 N·m (20 ft-lbs).
6. Tighten the lower hardware (3, 4, 7) to 47.5 N·m (35 ft-lbs).
7. Verify that the starter cable is routed downward. Verify is at least 6.4 mm (¼ in) from the end of the right side screws.
8. Install Dual Bank Angle Sensor Kit (10).
9. See the service manual. Install main fuse.

#### Verify Dual Bank Angle Sensor Shut-Off

##### NOTE

*Engine Guard Kit must be installed for this test to be valid.*

1. Start the engine. Leave the transmission in neutral.
2. Lean the vehicle over until the front guard nearly contacts the ground. The engine must stop running within one second.
3. To reset:
  - a. Turn the run switch off for 5 seconds.
  - b. Turn on the run switch and start engine.
4. Repeat steps for the opposite side.
5. If the engine does not stop, check wiring, connectors and bank-angle sensor bracket mounting to confirm correct installation. Repeat the test.



# SERVICE PARTS

is07870e

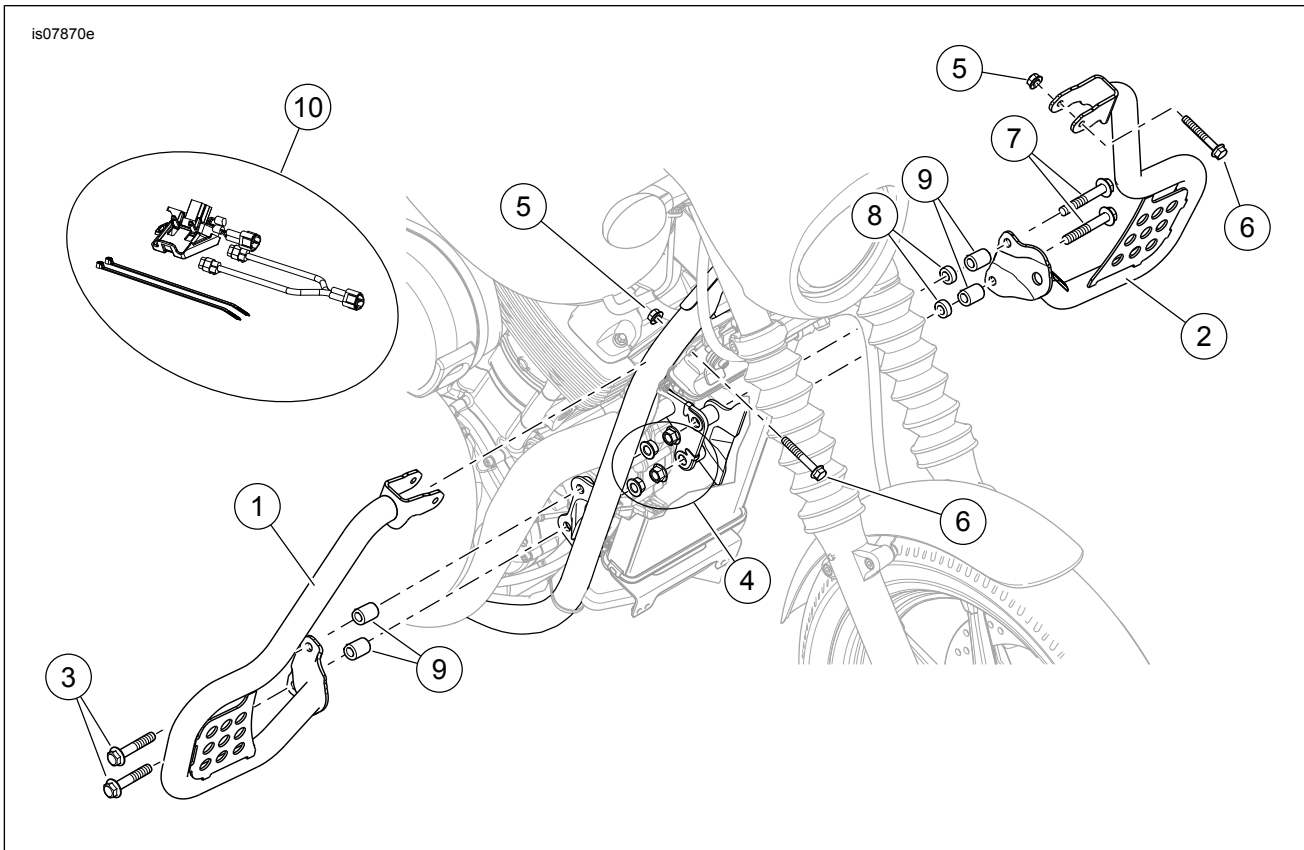

Figure 1. Kit Contents: Engine Guard Kit

Table 1. Kit Contents

Item	Description (Quantity)	Part Number
1	Guard weldment, right	49000109
2	Guard weldment, left	49000108
3	Screw, right, M10 x 1.5 x 60 (2)	10200244
4	Flange Locknut, M10 x 1.5 (4)	10100045
5	Flange Locknut, M8 x 1.25 (2)	10100042
6	Screw, M8 x 1.25 x 55 (2)	10200247
7	Screw, left, M10 x 1.5 x 70 (2)	10200245
8	Spacer, short 14.5 mm (2)	Not Sold Separately
9	Spacer, long 17.5 mm (4)	49000083
10	Dual Bank Angle Sensor Kit	32700040