



INSTRUCTIONS

-J04150

REV. 2006-05-16

XL PASSENGER PILLION

GENERAL

Kit Number

51744-07

Models

This kit fits 2007 and later XL883 and XL883L models equipped with original equipment solo seat. Also fits 2007 and later XL models equipped with accessory solo seat kits 51750-07 and 51751-07.

Additional Parts Required

⚠ WARNING

Do not install these seat kits on motorcycles that are not equipped with an appropriate grab strap and passenger footpegs. If footpegs and grab strap are not installed, passenger could fall from moving motorcycle or grab onto operator, causing loss of control and death or serious injury. (000410b)

Passenger footpeg kit 50203-04 is required for models with out footpegs originally installed.

Kit Contents

See Figure 6 and Table 1.

REMOVAL

NOTE

Avoid scratching the paint surfaces during the removal, and installation of the seat.

1. Remove original seat according to the Owner's Manual instructions. Save the rear seat mounting screw.

INSTALLATION

1. See Figure 1. Remove the seat bracket located on the bottom of the stock seat on XL883 and XL883L models or from accessory seat.

To remove the bracket depress the plastic tab using your finger or screwdriver, and pull the bracket out of the slot.

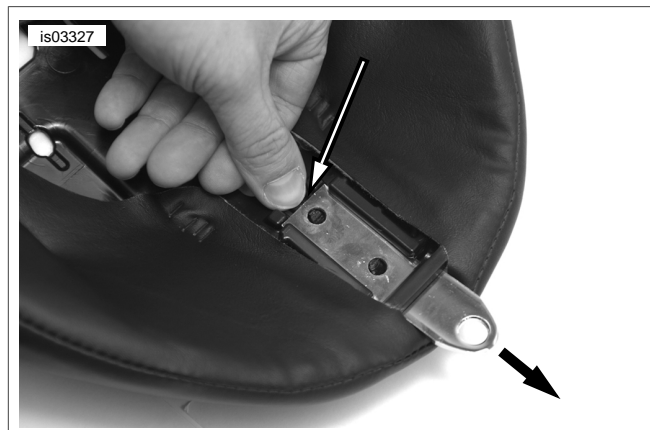
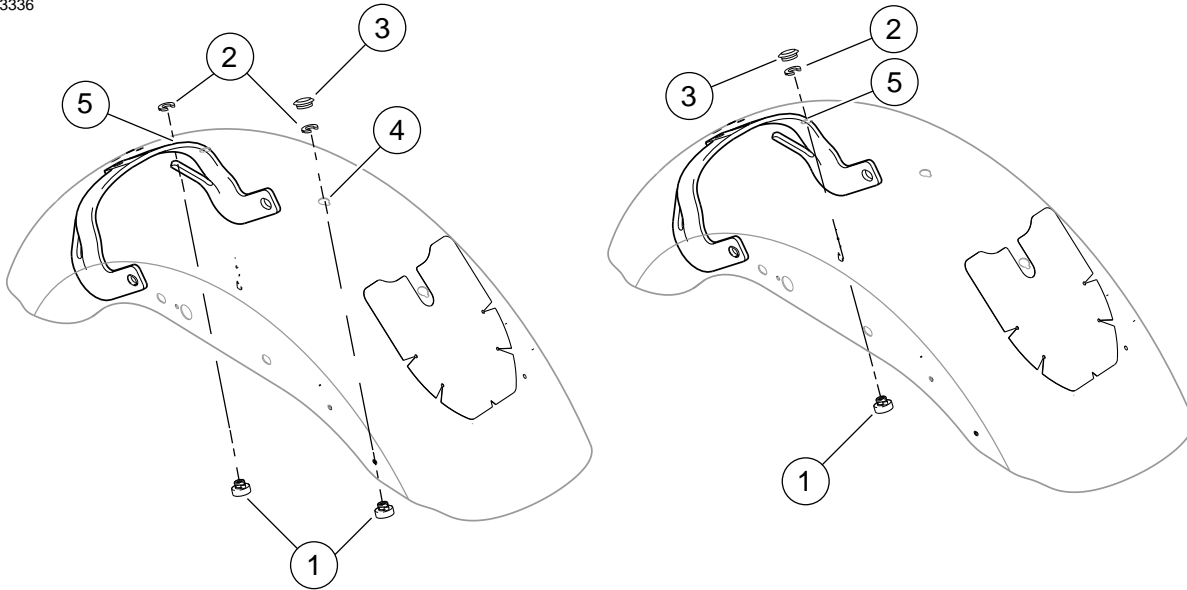

Figure 1. Seat Bracket Removal

2. See Figure 2. Remove the plastic plug (3) from the rear hole location in the fender. Save the plug for installation into the middle fender hole.
3. See Figure 2. Move the retention nut (1) and washer (2) from the middle location to the rear location on the fender where the plug was just removed.
4. As shown in Figure 6 a cable strap can be used as an installation tool.
 - a. Place the retention nut over the cable strap so that the wide end of the nut rests on the eye of the cable strap.
 - b. Thread the cable strap up under the fender and through the fender hole.
 - c. Pull up on the cable strap to hold the nut snug against the underside of the fender.
 - d. With the rib on the retention nut seated into the notch in the fender hole, slide the retention washer into place from the rear. This will lock the retention nut in place.

is03336



1. Seat retention nut
2. Seat retention washer
3. Plastic plug
4. Middle fender hole location
5. Rear fender hole location

Figure 2. Seat Retention Nut and Washer Locations

5. See Figure 3. Place the stock seat or the solo accessory seat upside down on a work surface. Attach the passenger pillion to the solo seat by sliding the metal bracket (on the pillion) into the slot (on the solo seat) till the tab locks the bracket into place.
6. See Figure 4. Install the grabstrap onto the bottom of the seat, by hooking one side of the grabstrap onto the tang on the underside of the seat and then looping the strap over the seat and fastening the remaining side onto the remaining tang.



Figure 3. Underside of Seat and Pillion Assembly



1. Tangs on bottom side of seat

Figure 4. Underside of Seat Showing Grabstrap Installed

7. Attach the seat bracket removed in Step 1 to the passenger pillion using the flange screws included in the kit. Tighten securely.

NOTE

The foam cushion of the seat needs to be compressed as the seat is slid forward to engage the post on the frame when the seat is dropped into place. When properly installed, the front tongue on the underside of the seat should fit snugly in the groove at the fuel tank rear mounting location, and the keyhole on the underside of the seat will lock the seat to the post on the frame.

8. See Figure 5. The seat and pillion assembly is attached to the vehicle at three points.
 - a. The tongue fits under the rear fuel tank bracket.
 - b. The keyhole locks onto the seat post.
 - c. The rear mounting bracket attaches to the rear seat nut in the fender with a screw.

Install the seat and pillion as follows:

Angle the front of the new seat into place so that the tongue engages the slot at the rear of the fuel tank mounting location.

9. Push the seat forward and rotate the rear of the seat downward until the seat contacts the frame. Flex the seat slightly.
10. Pull up on the center of the seat to verify that it is locked into place. (There will be a small amount of play, but the seat should only come up about a half an inch and then will be held firmly in place by the post on the underside of the seat).

11. Install the screw and fasten the seat mounting bracket to the top of the rear fender.
12. Tighten the mounting bracket screw securely.

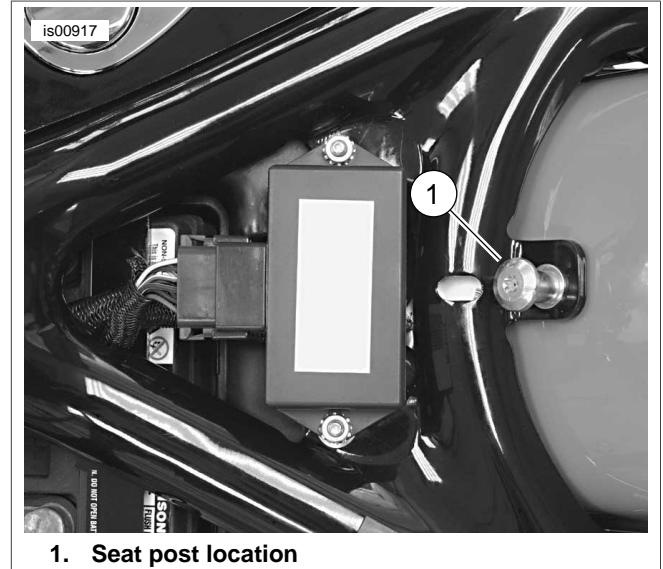

Figure 5. Seat Post

⚠ WARNING

After installing seat, pull upward on seat to be sure it is locked in position. While riding, a loose seat can shift causing loss of control, which could result in death or serious injury. (00070b)

13. Pull up on the front and rear of the seat again to verify that it is properly secured.

SERVICE PARTS

is03321

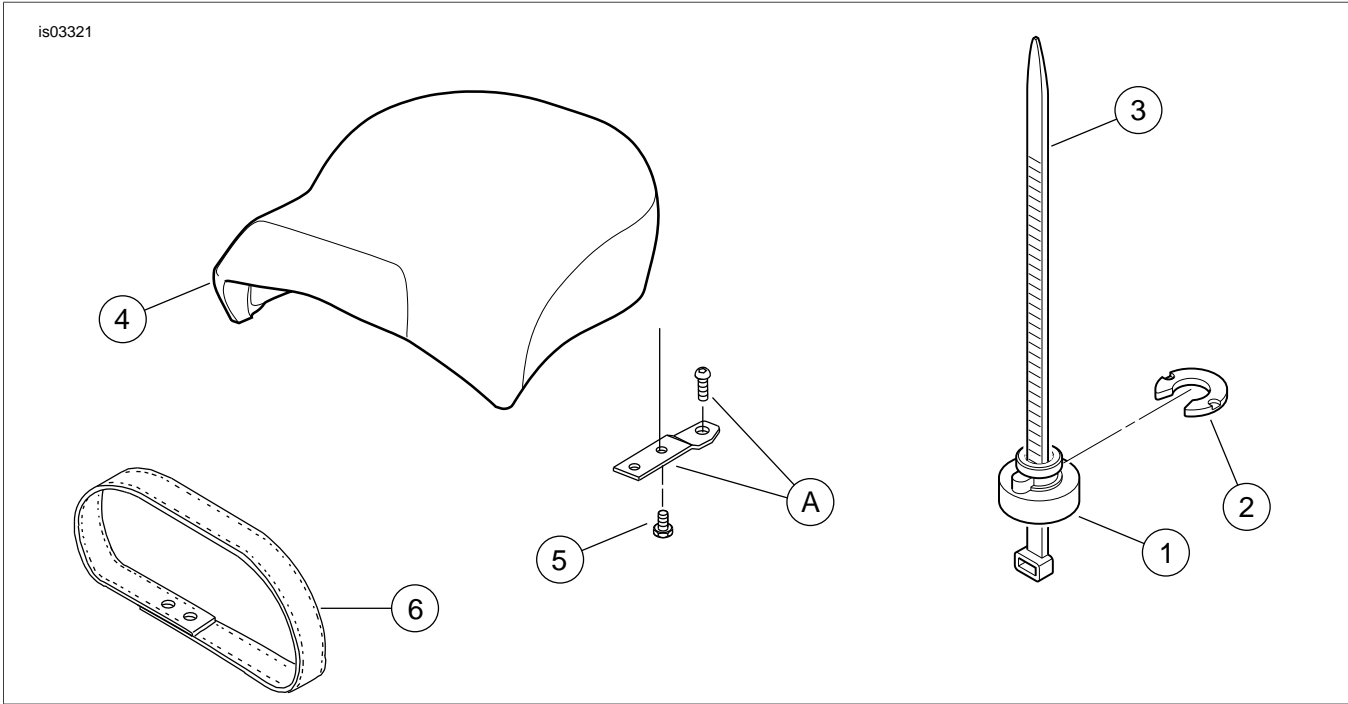

Figure 6. Service Parts: XL PASSENGER PILLION KIT

Table 1. Service Parts Table

Kit Contents in Kit 51744-07					
Item	Description (Quantity)	Part Number	Item	Description (Quantity)	Part Number
1	Nut, seat retention	Not sold separately	5	Hex head flange screw (2)	3574
2	Washer, retention	Not sold separately	6	Grab strap	52293-04
3	Cable strap	10039	Items Not in kit		
4	Passenger pad	Not sold	A	Items saved in Step 1	Reference only
The following service kit is available: Seat Nut kit (includes a retention washer and seat retention nut.)					59768-97