



INSTRUCTIONS

-J03895

REV. 2005-08-18

CHROME FRONT WHEEL HUB PLATE

GENERAL

Kit Number

41513-05, 41514-05, 41517-05

Models

See the enclosed table for fitment information.

Table 1. Models

Kits	Models
Kit 41513-05	Fits 2000-2005 FXD, FXDL, FXDC, and 2000 and later XL883, XL883L models with original equipment front wheel.
Kit 41514-05	Fits 2000 and later FLSTF/I and 2006 FXDCI, FXDLI, FXDI35, FXDBI models with original equipment front wheel. This kit also fits models equipped with accessory front wheel kit part numbers 41322-05, 41271-03, 41022-00, 41031-00, and 41043-00.
Kit 41517-05	Fits the following Accessory Wheel Kits: <ul style="list-style-type: none"> Chrome Thunderstar, Part Numbers 43978-00A, 43977-00, 43975-00, 44323-04 Black Thunderstar, Part Numbers 43771-00A, 43772-00, 43773-00, 44322-04 Chrome Lightningstar, Part Numbers 43732-00, 43733-00, 43805-00, 43734-00, 43765-04, 43940-04 Chrome Slotted Six-Spoke 43918-02, 43922-02, 43924-02, 43926-02, 44055-04, 44058-04 Black Slotted Six-Spoke, Part Numbers 43919-02, 43923-02, 43925-02, 43927-02, 44056-04, 44057-04 Chrome Nine-Spoke, Part Number 43496-04

WARNING

The rider's safety depends upon the correct installation of this kit. Use the appropriate service manual procedures. If the procedure is not within your capabilities or you do not have the correct tools, have a Harley-Davidson dealer perform the installation. Improper installation of this kit could result in death or serious injury. (00333a)

NOTE

This instruction sheet references Service Manual information. A Service Manual for your model motorcycle is required for this installation and is available from a Harley-Davidson Dealer.

Kit Contents

See Figure 1 and Table 2.

INSTALLATION

1. Remove front wheel according to applicable Service Manual instructions.

NOTE

See Service Parts illustration. The hub cap gasket (3) is pre-installed to the hub cap. Shown separately for service clarity.

2. See Service Parts illustration. Install hub cap plate (1), and pan head torx screws (2) from kit. Tighten screws to 16-24 ft-lbs (22-33 Nm).
3. Reinstall front wheel according to applicable Service Manual instructions.

SERVICE PARTS

See Figure 1 and Table 2.

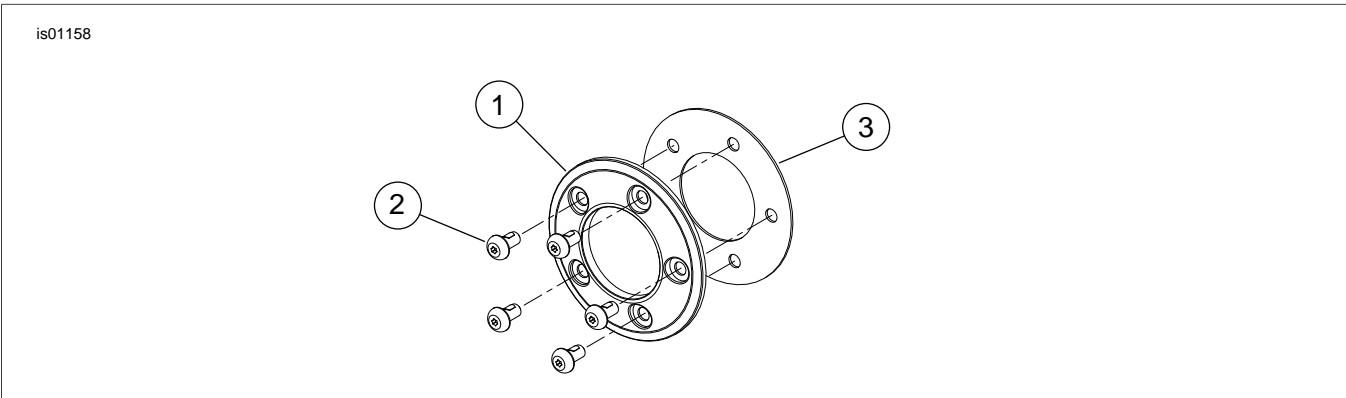

Figure 1. Service Parts: Front Wheel Hub Plate Kits

Table 2. Service Parts Table

Kit	Item	Description (Quantity)	Part Number
Kit 41517-05	1	Hub plate, front, wheel	Not sold separately
	2	Screw, pan head, Torx (5)	4571
	3	Gasket, hub cap	Not sold separately
Kit 41514-05	1	Hub plate, front, wheel	Not sold separately
	2	Screw, pan head, Torx (5)	4571
Kit 41513-05	1	Hub plate, front, wheel	Not sold separately
	2	Screw, pan head, Torx (5)	4571