



INSTRUCTIONS

-J03524

REV 12-16-2004

Kit Number 44549-04

CHROME REAR BRAKE CALIPER KIT

General

This kit is designed to fit 2004 and later XL model motorcycles.

This kit does not include brake pads. If you are installing this kit on a new vehicle, use the existing brake pads. If your vehicle is not new, inspect pads for minimum allowable thickness. Harley-Davidson recommends the purchase of **new** brake pads. Replacement brake pads are available from your Harley Davidson dealer.

This kit requires special tools and procedures. We recommend this kit be installed by a factory-trained technician at an authorized Harley-Davidson dealership.

NOTE

This kit does not include the caliper mounting bracket and mounting bracket bolt pin. When removing the original caliper assembly from the vehicle, retain these items for reuse.

See *Service Parts illustration* for kit contents.

WARNING

The rider's safety depends upon the correct installation of this kit. Use the appropriate service manual procedures. If the procedure is not within your capabilities or you do not have the correct tools, have a Harley-Davidson dealer perform the installation. Improper installation of this kit could result in death or serious injury. (00333a)

NOTE

This instruction sheet references Service Manual information. A Service Manual for your model motorcycle is available for purchase at your Harley Davidson dealer.

Installation

Prepare the Motorcycle for Service

WARNING

To prevent accidental vehicle start-up, which could cause death or serious injury, disconnect negative (-) battery cable before proceeding. (00048a)

1. Follow Service Manual instructions to disconnect the negative (-) battery cable.
2. Remove the left side cover and remove the maxi-fuse.

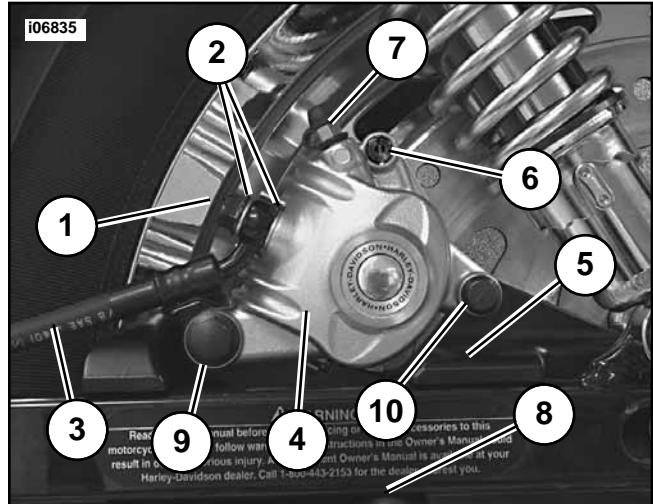

- 1 Banjo bolt
- 2 Washer (2)
- 3 Rear brake line
- 4 Brake caliper
- 5 Caliper mounting bracket
- 6 Pad pin plug
- 7 Bleeder valve
- 8 Damper
- 9 Caliper bolt pin
10. Mounting bracket bolt pin (shown with boot installed)

Figure 1. Rear Caliper Assembly

Remove the Existing Caliper

NOTE

When performing the following step, place a container under caliper to catch brake fluid that may flow from brake line when removing banjo bolt. Do not reuse brake fluid.

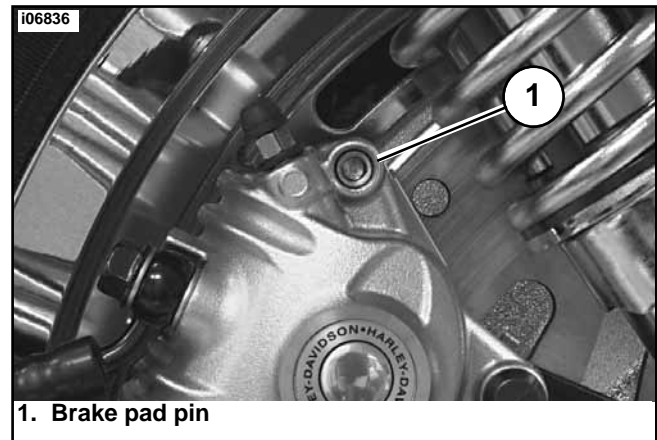

1. Brake pad pin

Figure 2. Brake Pad Pin Removal

CAUTION

Avoid leakage. Be sure gaskets, banjo bolt(s) and brake line are clean and undamaged before assembly. (00323a)

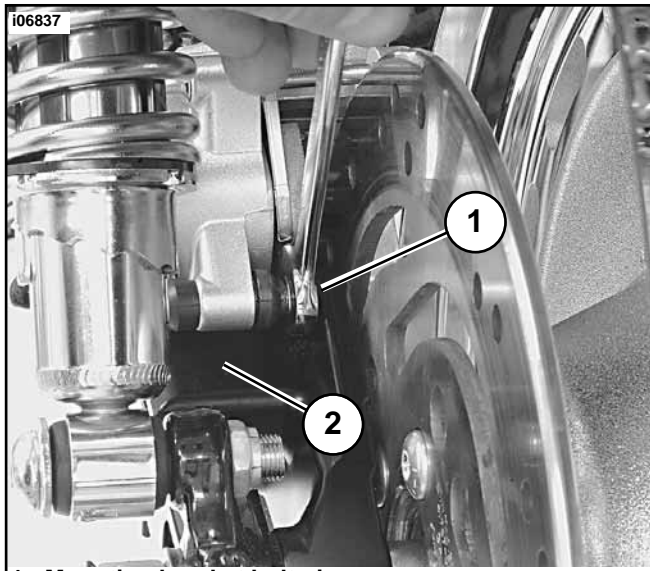

1. Mounting bracket bolt pin
2. Caliper mounting bracket

Figure 3. Caliper Removal

1. See Figure 1. Remove the banjo bolt (1) and both washers (2) to detach front brake line (3) from brake caliper (4). Retain banjo bolt and discard washers.
2. Remove pad pin plug (6).
3. See Figure 2. Unscrew and remove brake pad pin (1).
4. Note the orientation of the brake pads and remove pads.
5. Slide brake caliper on rear bolt pin away from brake disc as far as possible.
6. See Figure 3. Using an open-end wrench, unscrew mounting bracket bolt pin (1) from caliper mounting bracket (2). Retain for future use. Lift brake caliper straight up and away from brake disc and caliper bracket.

Inspect Brake Components

1. Inspect brake disc and, if necessary, follow the instructions in the Service Manual to replace brake disc.

Inspect and Lubricate Chrome Caliper

NOTE

The new rear chrome caliper come assembled from the factory. Before installing onto vehicle however, it must be inspected to ensure that all components are in the correct position.

1. See Figure 4. Place the new caplier housing (1) on a workbench as shown. Ensure that the caliper pad spring (2) is firmly in place in channel.
2. See Figure 5. Apply approximately 0.4 g of G40M brake grease (H-D Part Number 42820-04) inside caliper bushing boot (3) and caliper pin boot (4).
3. See Figure 6. Apply G40M brake grease inside boot lip (8) to prevent sticking between boots (3, 4) and bolt pins (5, 6).
4. Insert mounting bracket bolt pin (6) into caliper bushing boot (3).

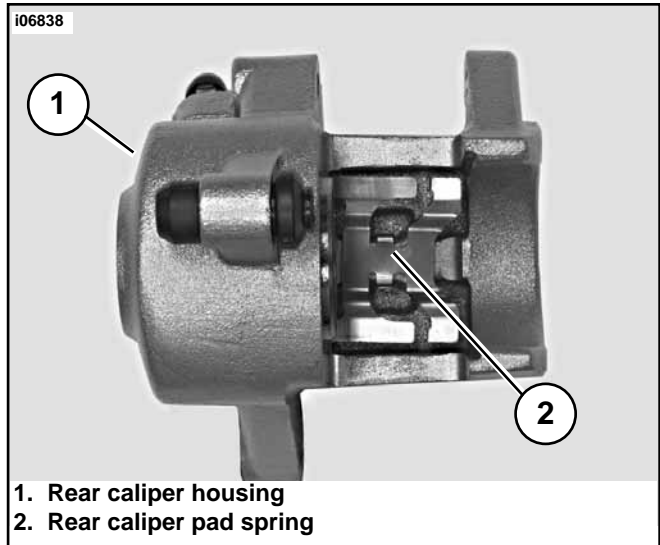

1. Rear caliper housing
2. Rear caliper pad spring

Figure 4. Rear Caliper Assembly

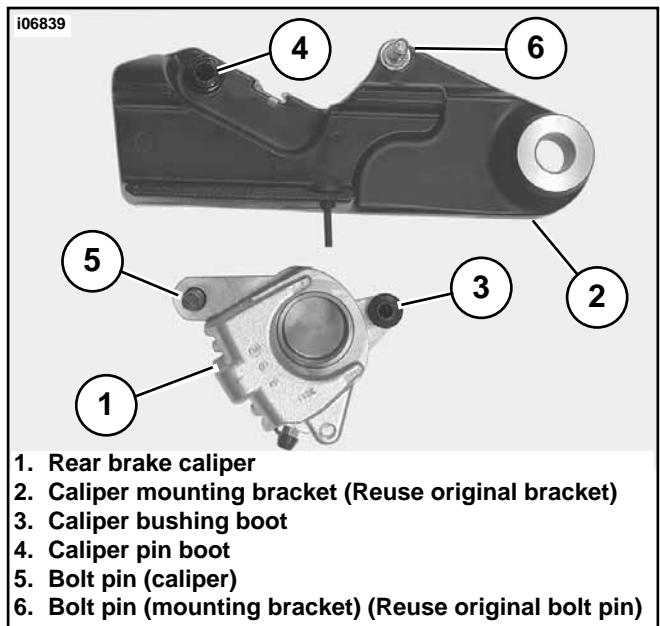

1. Rear brake caliper
2. Caliper mounting bracket (Reuse original bracket)
3. Caliper bushing boot
4. Caliper pin boot
5. Bolt pin (caliper)
6. Bolt pin (mounting bracket) (Reuse original bolt pin)

Figure 5. Lubricating Caliper Boots and Pins

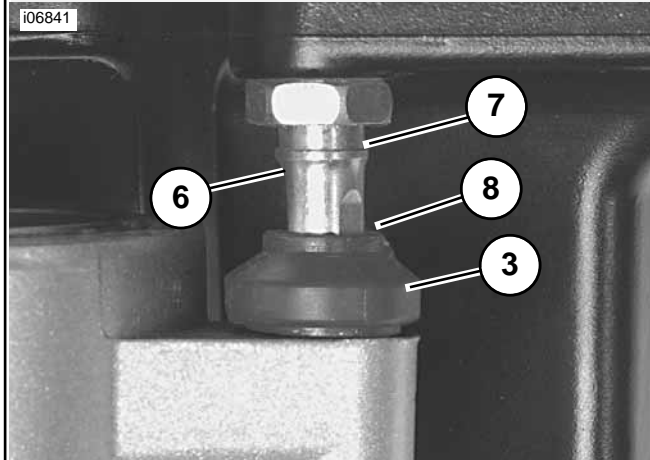
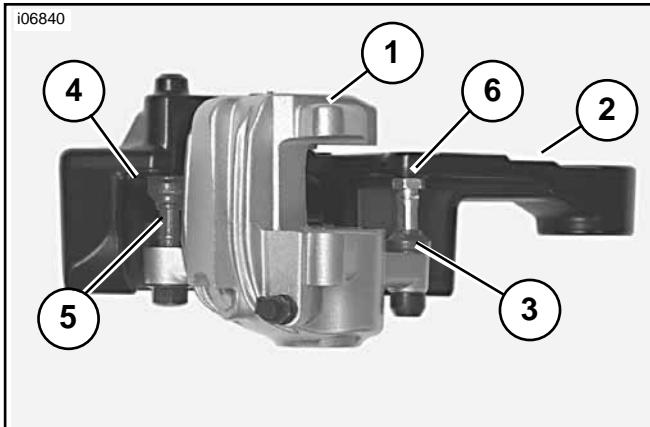

1. Rear brake caliper
2. Caliper mounting bracket (Reuse original bracket)
3. Caliper bushing boot
4. Caliper pin boot
5. Bolt pin (caliper)
6. Bolt pin (mounting bracket)
7. Tapered shoulder
8. Boot lip

Figure 6. Assembling Rear Brake Caliper to Original Mounting Bracket

Install the Chrome Caliper

1. Obtain chrome caliper assembly from kit. Remove plastic bleeder valve cover from brake line port (as shipped) and discard. Place caliper over brake disc with bleeder valve facing upwards.
2. See Figure 7. Before installing caliper, make sure that retainer bracket (1) is properly installed on mounting bracket.

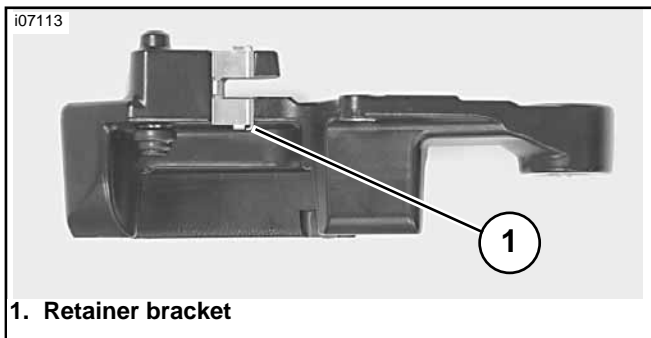
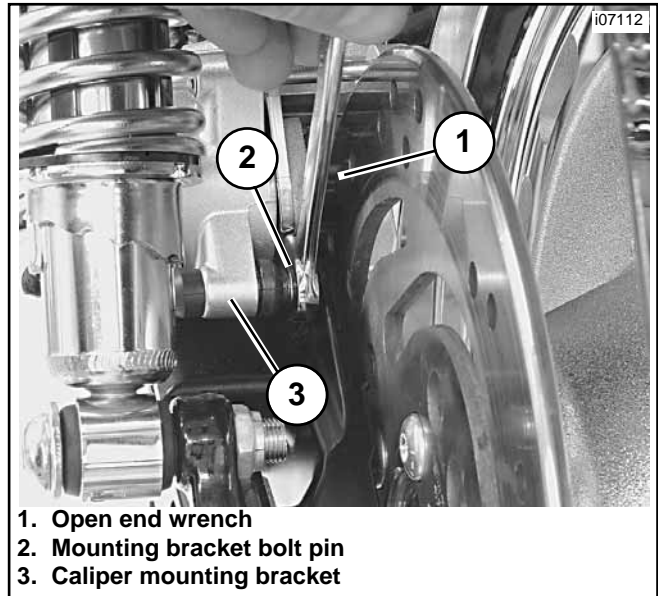

Figure 7. Retainer Bracket

3. See Figure 6. Apply a small amount of LOCTITE 272 thread locking compound (Part Number 98618-03) to threads of mounting bracket bolt pin (6).
4. Place rear caliper assembly onto mounting bracket.
5. See Figure 8. Using an open end wrench (1), thread mounting bracket bolt pin (2) into caliper mounting bracket. Tighten to 87-130 in-lbs (9.8-14.7Nm).



1. Open end wrench
2. Mounting bracket bolt pin
3. Caliper mounting bracket

Figure 8. Installing Rear Caliper Bolt Pin

6. See Figure 6. Apply a small amount of LOCTITE 272 thread locking compound (Part Number 98618-03) to threads of caliper bolt pin (5).
7. Slide caliper bolt pin (5) through front mounting hole in caliper. Carefully insert bolt pin shaft into caliper pin boot (4) in mounting bracket (2). Screw bolt pin into caliper and tighten to 15-18 ft-lbs (20.4-24.6 Nm).

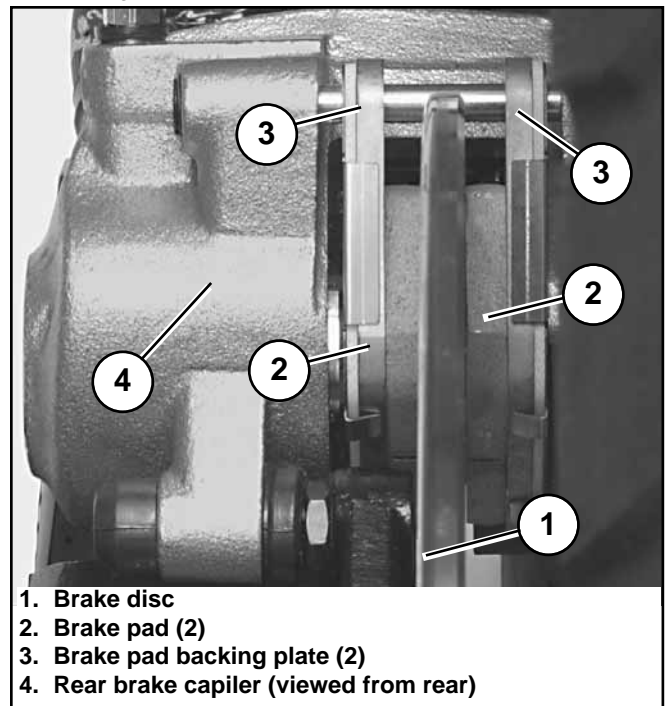

1. Brake disc
2. Brake pad (2)
3. Brake pad backing plate (2)
4. Rear brake capiler (viewed from rear)

Figure 9. Brake Pad Inspection

WARNING

Always replace brake pads in complete sets for correct and safe brake operation. Improper brake operation could result in death or serious injury. (00111a)

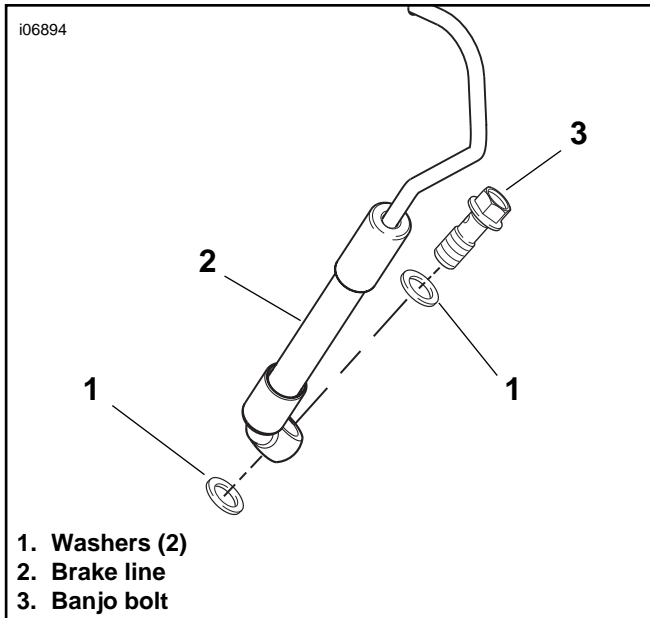

Figure 10. Banjo Bolt and Washer Installation

- See Figure 9. Replace brake pads (2) if brake pad friction material is worn to 0.04 in. (1.02 mm) or less above the backing plate (3). Always replace both pads in a caliper as a set. When checking the brake pads and discs, inspect the brake hoses for correct routing and any sign of damage.
- Inspect the brake disc (1) thickness. Minimum brake disc thickness is stamped on the side of the disc. Replace disc if worn past minimum thickness or badly scored. Maximum brake disc lateral runout and warp is 0.008 in. (0.2 mm) when measured near the outside diameter.
- Install brake pads. Refer to the instructions in the Service Manual to install new brake pads.
- Install the pad pins through the inner and outer brake pads. Tighten to 130-173 in-lbs (14.7-19.6 Nm).

CAUTION

Avoid leakage. Be sure gaskets, banjo bolt(s) and brake line are clean and undamaged before assembly. (00323a)

- See Figure 1. Install pad pin plug (6). Tighten to 18-25 in-lbs (2.0- 2.9 Nm).
- See Figure 10. Obtain 2 **new** washers (gaskets) (Part Number 41732-04). Connect the brake line (2) to caliper using **new** washers (gaskets) (1) and banjo bolt (3). Tighten banjo bolt to 20-25 ft-lbs (27.1-33.9 Nm).

Bleed the Brakes

CAUTION

Direct contact of D.O.T. 5 brake fluid with eyes can cause eye irritation, swelling and redness. Avoid eye contact. In case of eye contact flush with large amounts of water and get medical attention. Swallowing large amounts of D.O.T. 5 brake fluid can cause digestive discomfort. If swallowed, obtain medical attention. Use in well ventilated area. KEEP OUT OF THE REACH OF CHILDREN. (00144a)

- Refer to the instructions in the Service Manual for brake bleeding procedures.

Return the Motorcycle to Service

WARNING

Connect positive (+) battery cable first. If positive (+) cable should contact ground with negative (-) cable connected, the resulting sparks can cause a battery explosion, which could result in death or serious injury. (00068a)

- Connect negative (-) battery cable to battery. Install maxi-fuse and left side cover.

Test the Brakes

WARNING

After servicing brakes and before moving motorcycle, test brakes at low speed. If brakes are not operating properly, testing at high speeds can cause loss of control, which could result in death or serious injury. (00289a)

- Turn ignition switch ON.
- Pump brake pedal to verify operation of the brake lamp.
- Test ride the motorcycle. If the brakes feel spongy, bleed the brake system again.

NOTE

Avoid making hard stops for the first 100 miles (160 km). This allows the new pads to become conditioned to the brake discs.



Service Parts

Part No. 44549-04

Date 12/04

Chrome Rear Brake Caliper Kit

i06829

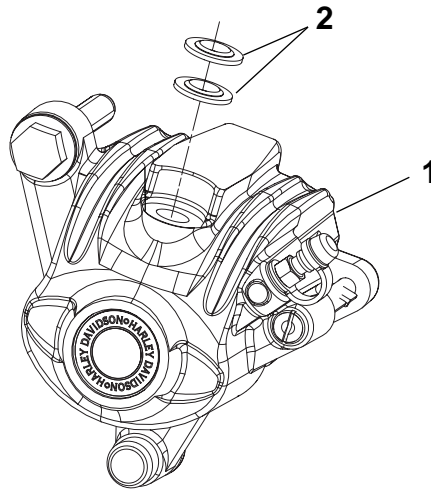

Item	Description (Quantity)	Part No.
	Chrome Rear Brake Caliper Kit	44549-04
1	Rear Caliper Assembly	Not sold
2	Washer (2) (Banjo bolt washers)	41732-04