



# INSTRUCTIONS

-J03214

REV. 12-15-03

Kit Number 29848-04

## AIR CLEANER ADAPTER KIT

### General

This instruction sheet describes the installation of the Air Cleaner Adapter Kit (P/N 29848-04). This kit is used with Air Cleaner Cover (Part No. 29792-04) when installed with the Screamin' Eagle High Flow Air Cleaner Kit (P/N 29042-04).

This kit fits all 2004 Sportster models.

This kit contains the following items:

QTY	DESCRIPTION	PART NO.
1	Front spacer bar assembly	not sold
2	5/16-18 UNC X 1.375 zinc plated flat head screw	not sold
2	Spacer	not sold
2	Nylon washer	not sold

#### NOTE

*A service manual for your model motorcycle is available from any Harley-Davidson dealer.*

This instruction sheet addresses three different types of installations:

1. If your motorcycle is equipped with the original equipment air cleaner cover, air filter element and backplate assembly and you have purchased the Screamin' Eagle High Flow Air Cleaner Kit (P/N 29042-04) and Air Cleaner Cover Kit (P/N 29792-04), follow the instructions under "Installation 1".
2. If your motorcycle is equipped with the Screamin' Eagle High Flow Air Cleaner Kit (P/N 29042-04), the original equipment air cleaner cover, and you have purchased Air Cleaner Cover Kit (P/N 29792-04), follow the instructions under "Installation 2".
3. If your motorcycle is equipped with the original equipment air filter element and backplate assembly, Air Cleaner Cover Kit (P/N 29792-04) and you have purchased the Screamin' Eagle High Flow Air Cleaner Kit (P/N 29042-04), follow the instructions under "Installation 3".

### Installation 1

For vehicles equipped with original equipment air cleaner assembly:

1. Follow the instructions in the Sportster Models Service Manual and remove the air cleaner cover, air filter element and backplate assembly. Save original components; some will be reused when installing High Flow air cleaner kit.
2. Follow the instructions included in the Screamin' Eagle High Flow Air Cleaner Kit (P/N 29042-04) to install the air cleaner assembly and backplate. Do NOT install the cover adapter or cover mounting hardware.
3. Now continue with instructions under "Installation - All" on the next page.

### Installation 2

For vehicles equipped with Screamin' Eagle High Flow Air Cleaner Kit (P/N 29042-04) and original equipment air cleaner cover:

1. Remove air cleaner cover with screws, spacers and cover adapter. None of these parts will be reused.
2. Now continue with instructions under "Installation - All" on the next page.

### Installation 3

For vehicles equipped with original equipment air filter element and backplate assembly and Air Cleaner Cover Kit (P/N 29792-04):

1. Remove the air cleaner cover. Discard cover screws, spacers, nylon washers and rubber cover seal. These parts will not be used in this installation. Set cover and medallion insert aside for later use.
2. Follow the instructions in the Sportster Models Service Manual and remove the air filter element and backplate assembly. Save original components; some will be reused when installing High Flow air cleaner kit.
3. Follow the instructions included in the Screamin' Eagle High Flow Air Cleaner Kit (P/N 29042-04) to install the air cleaner assembly and backplate. Do NOT install the cover adapter or cover mounting hardware.
4. Now continue with instructions under "Installation - All" on the next page.

## Installation - All

## NOTE

1. See [Figure 1](#). Remove protective backing from two adhesive strips (2) on back side of front spacer bar assembly (1).
2. Mount spacer bar assembly vertically with notch (5) facing lower front air cleaner mounting screw (6). Install screw (4) through hole in spacer bar and thread into air cleaner face plate a few turns to line up spacer bar properly with air cleaner (3). Press firmly against spacer bar assembly to affix it to air cleaner. Remove screw.

See [Figure 2](#). Note that spacers (1) have a tapered recess (2) on one end and a flat recess (3) on the other end. When assembled, the nylon washer (6) fits into the flat recess.

3. See [Figure 2](#). Insert screws (5) into air cleaner cover (4). Slide spacers (1) onto screws with tapered recess (2) facing cover. Thread nylon washers (6) onto screws.
4. Install air cleaner cover assembly while aligning mounting screws with threaded holes in air cleaner face plate. Tighten screws to 36-60 **in-lbs** (4.1-6.8 Nm).
5. Install medallion insert by centering the medallion in the recess on cover and pressing firmly into place.

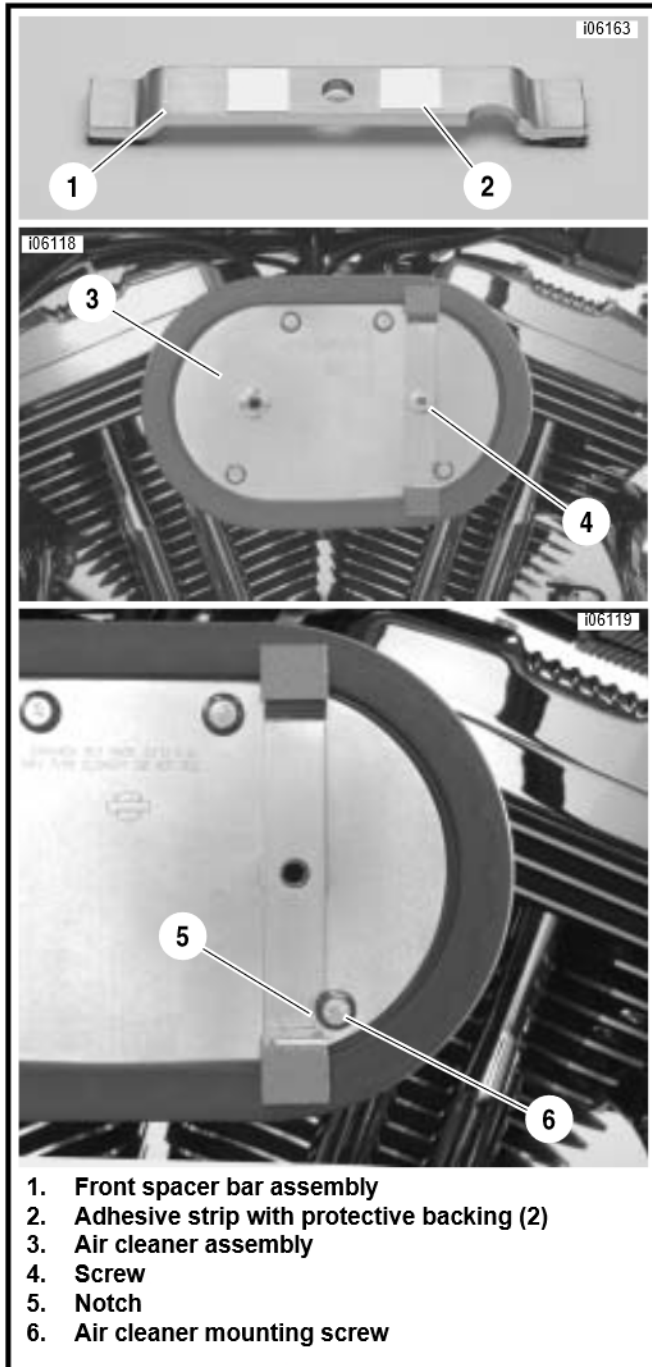

Figure 1. Attaching Front Spacer Bar Assembly to Air Cleaner

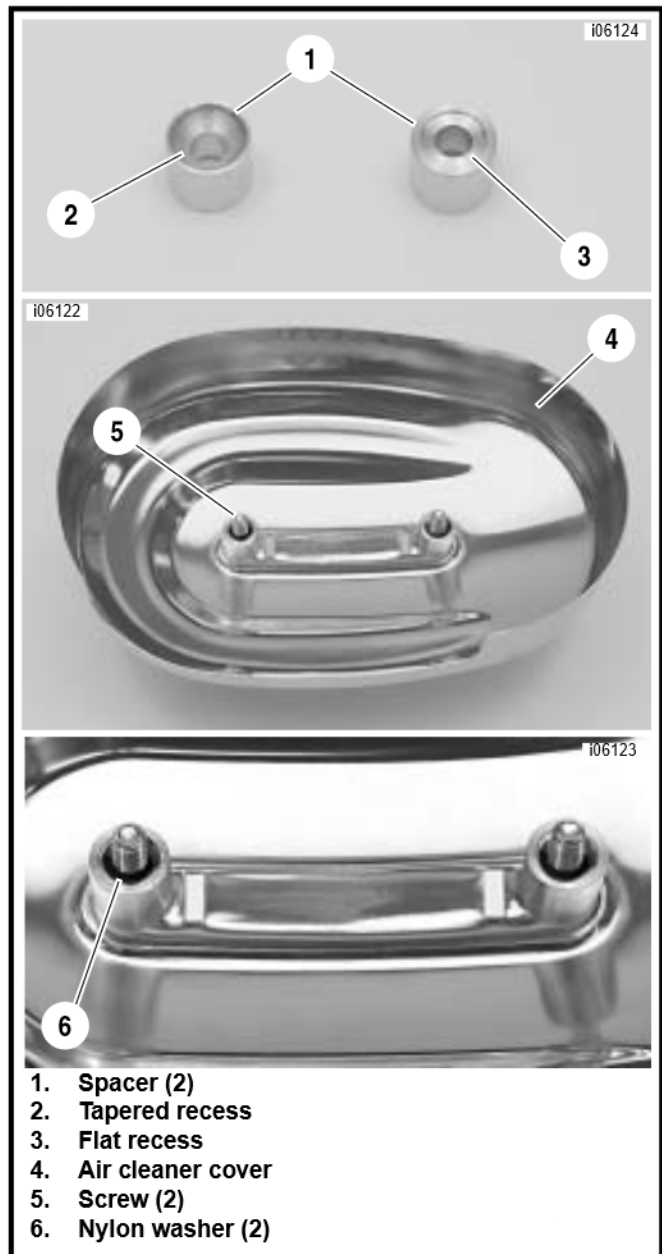

Figure 2. Attaching Mounting Hardware to Air Cleaner Cover