

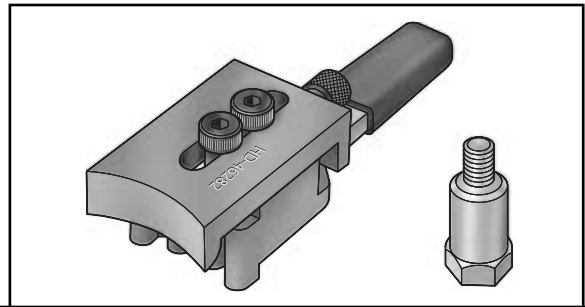

Service Tool Instructions

REV. 09-15-2003

Instruction Sheet ID: -J03049



HD-46282 FINAL DRIVE SPROCKET HOLDING TOOL

General

These instructions describe how to use the FINAL DRIVE SPROCKET HOLDING TOOL (Part No. HD-46282) to remove and install the final drive sprocket on the following models:

- All 1991 and later Sportster models.

NOTE

A Service Manual for your model motorcycle is available from your Harley-Davidson Dealer.

Usage

1. See Figure 1. Unthread adjustment screw (3) several turns. Loosen shoulder bolts (4) just enough so that sprocket holder plate (2) slides smoothly on sprocket holder/handle (1).
2. See Figure 2. Holding tool attaches to final drive sprocket as shown.
 - a. Slide tool onto sprocket.
 - b. Tighten adjustment screw (item 3, Figure 1.) only enough to clamp tool squarely to sprocket. Do NOT overtighten adjustment screw.
 - c. Tighten shoulder bolts (item 4, Figure 1.) firmly to lock tool in place.

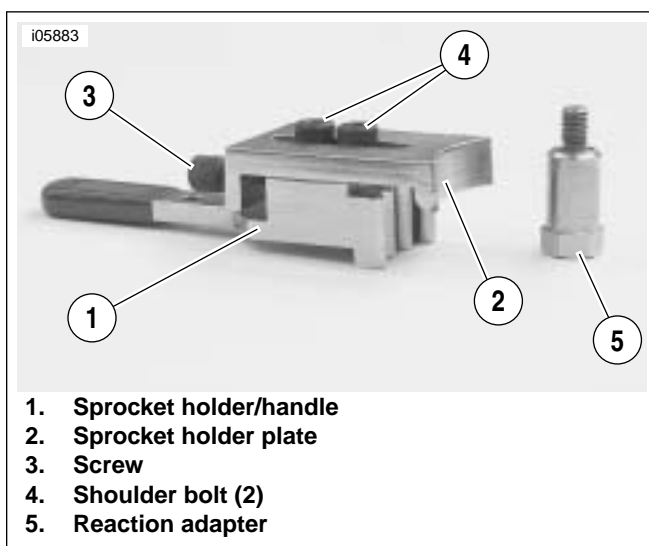

Figure 1. Final Drive Sprocket Holding Tool

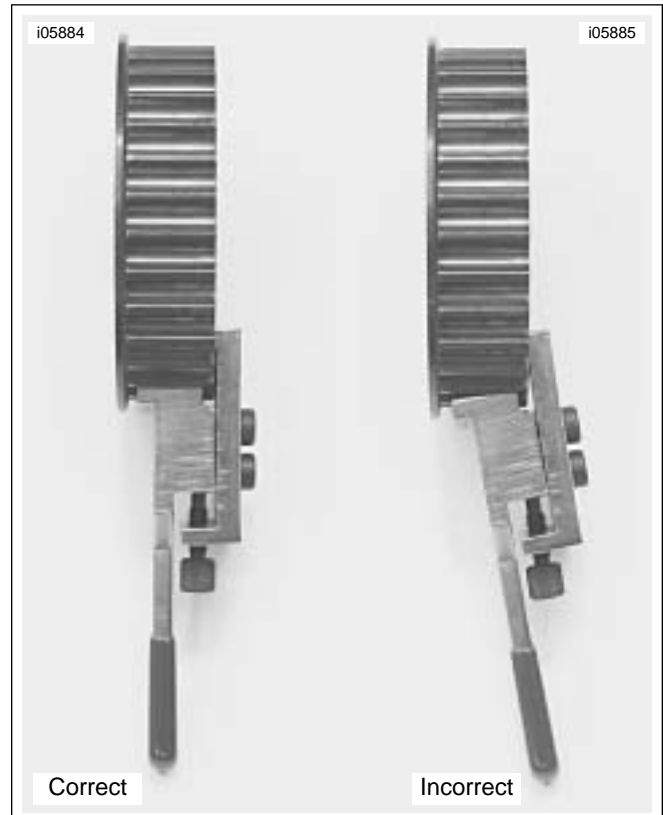

Figure 2. Attaching Holding Tool to Final Drive Sprocket

Removal

1. Shift transmission into neutral.
2. Remove the following items as described in the service manual:
 - Rear muffler and rear exhaust pipe
 - Sprocket cover
 - Rear drive belt
3. See Figure 3. Remove screw and washer (6) from exhaust interconnect bracket.
4. Remove two screws (5) and lockplate (4).

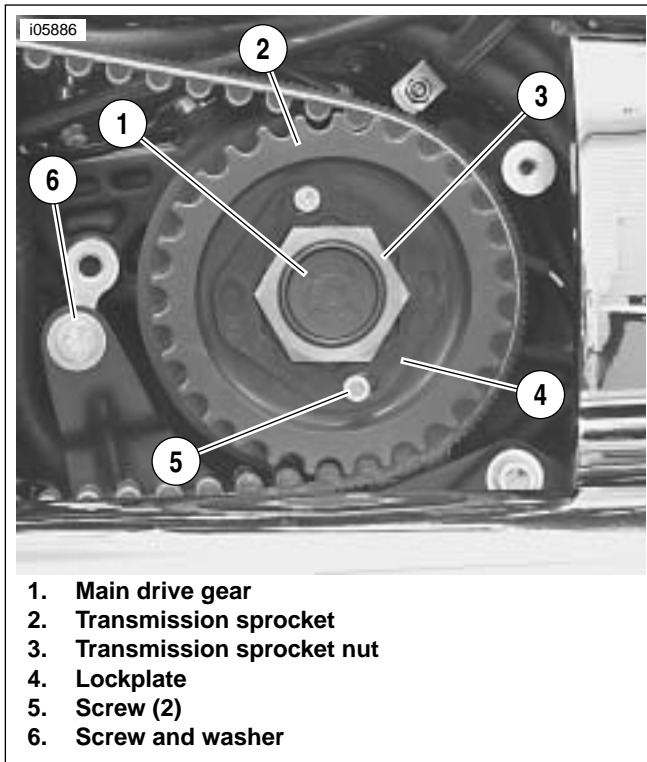

Figure 3. Transmission Sprocket Assembly

5. See Figure 4. Use TRANSMISSION SPROCKET HOLDING TOOL (Part No. HD-46282) (1), MAINSHAFT LOCKNUT WRENCH (Part No. HD-46288) (2), and a breaker bar (3) to remove transmission sprocket nut (**left-hand threads**). Place handle of sprocket holding tool under bottom of footpeg bracket. Turn nut **clockwise** to loosen and remove it.

NOTE

On models without rear footpegs, screw reaction adapter (Part No. HD-46282-1) into either rear footpeg bracket hole in frame. Place handle of tool underneath adapter.

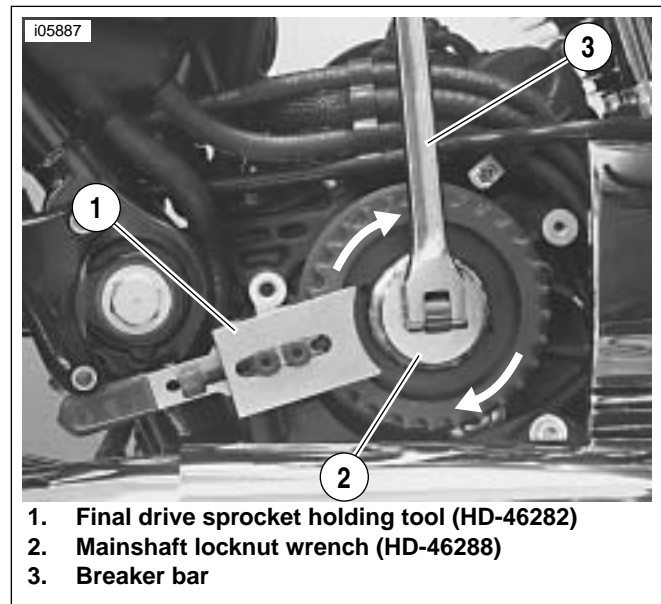

Figure 4. Removing Transmission Locknut

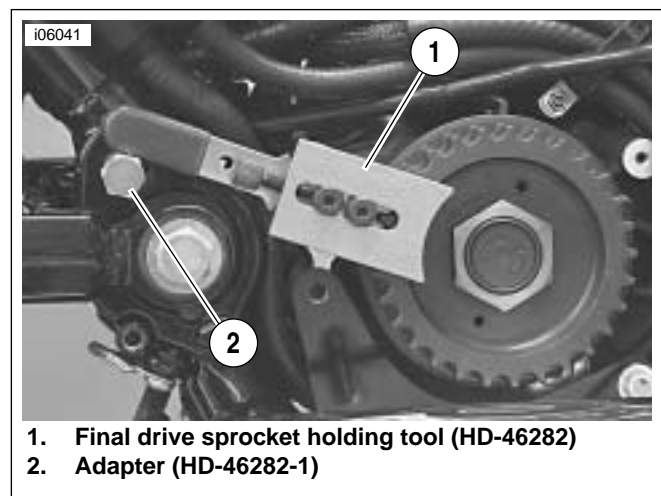

Figure 5. Using Holding Tool with Adapter (Arrangement for Tightening Sprocket Nut Shown)

SPX KENT-MOORE

SPX Corporation • 655 Eisenhower Drive • Owatonna, MN 55060-0995 • Phone 800-345-2233 • Fax 800-578-737

Installation

1. See [Figure 3](#). Install transmission sprocket (2) onto main drive gear (1).
2. Shift transmission into neutral. Apply a few drops of LOCTITE THREADLOCKER 262 (red) to the **left-hand threads** of transmission sprocket nut (3). Position nut with washer-faced side facing transmission sprocket. Turn the nut **counterclockwise** to install it onto main drive gear.
 - a. See [Figure 6](#). Use TRANSMISSION SPROCKET HOLDING TOOL (Part No. HD-46282) (1), MAIN-SHAFT LOCKNUT WRENCH (Part No. HD-46288) (2), and a torque wrench (3). Place handle of sprocket holding tool on top of footpeg bracket.

NOTE

On models without rear footpegs, screw reaction adapter (Part No. HD-46282-1) into either rear footpeg bracket hole in frame. Place handle of tool on top of adapter.

- b. See [Figure 3](#). Tighten sprocket nut (3) according to the procedure described in the service manual.
 - c. Install lock plate (4) over nut and tighten screws (5) according to the procedure described in the service manual.
3. Install the following items as described in the service manual:
 - Rear drive belt
 - Sprocket cover
 - Rear exhaust pipe and rear muffler
 4. Align rear wheel and adjust belt tension as described in the service manual.

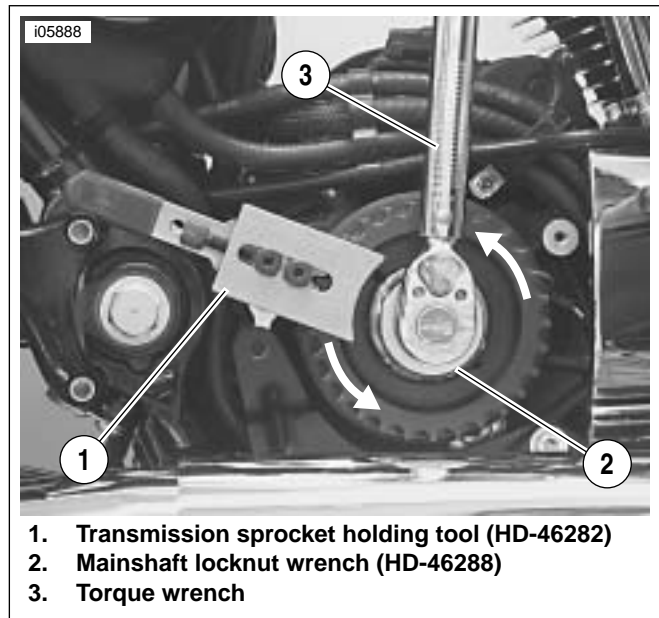

Figure 6. Installing Transmission Locknut



Service Tool Service Parts

Part No. HD-46282

Final Drive Sprocket Holding Tool

Date 09/03

i06030

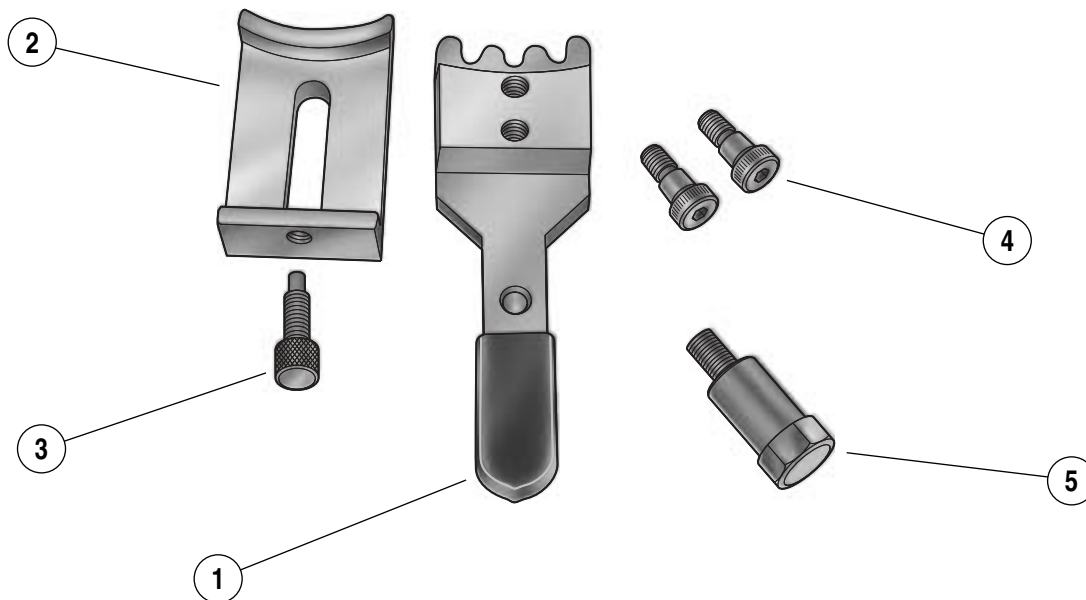

Item	Description	Part No.	No. In Kit
1	Sprocket holder/handle	HD-46282-2	1
2	Sprocket holder plate	HD-46282-3	1
3	Screw	HD-46282-6	1
4	Shoulder bolt	HD-46282-4	2
5	Reaction adapter	HD-46282-1	1

SPX KENT-MOORE

SPX Corporation • 655 Eisenhower Drive • Owatonna, MN 55060-0995 • Phone 800-345-2233 • Fax 800-578-737

-J03049

4 of 4