



INSTRUCTIONS

-J02877

REV. 08-23-2004

Kit Numbers 34578-04, 34584-04, 34586-04, 34588-04, 34592-04 and 34840-05

SPORTSTER® STAINLESS STEEL SHIFT LINKAGE KITS

General

Sportster Stainless Steel Shift Linkage Kits are designed to fit Harley-Davidson® 2004 and later XL model motorcycles with forward controls.

Kit No.	Style
34578-04	Scripted
34584-04	H-D Scripted
34586-04	Bar & Shield
34588-04	Slotted
34592-04	Round
34840-05	Skull

See the Service Parts illustration for the contents of these kits.

NOTE

A Service Manual for your model motorcycle is available from any Harley Davidson Dealer.

Installation

- 1 See Service Parts illustration. Loosen the jamnuts and turn the tie rod ends on the new stainless steel shifter rod (1) to match the length of the existing shifter rod.
- 2 See Figure 1. Remove existing capscrews (4) and shifter rod (2).
- 3 See Service Parts illustration. Slide longer capscrew (3) through the left tie rod end of new shifter rod (1). Place rod on the outside of the lever assembly. Thread capscrew (3) into the lever assembly.
- 4 Slide shorter capscrew (2) through the right tie rod end of new shifter rod (1). Place rod on the outside of the transmission shift lever. Thread capscrew (2) into the transmission shift lever.
- 5 Tighten capscrews to 10-15 ft-lbs (13.6-20.3 N-m).
- 6 Firmly tighten the jamnuts against the tie rod ends.

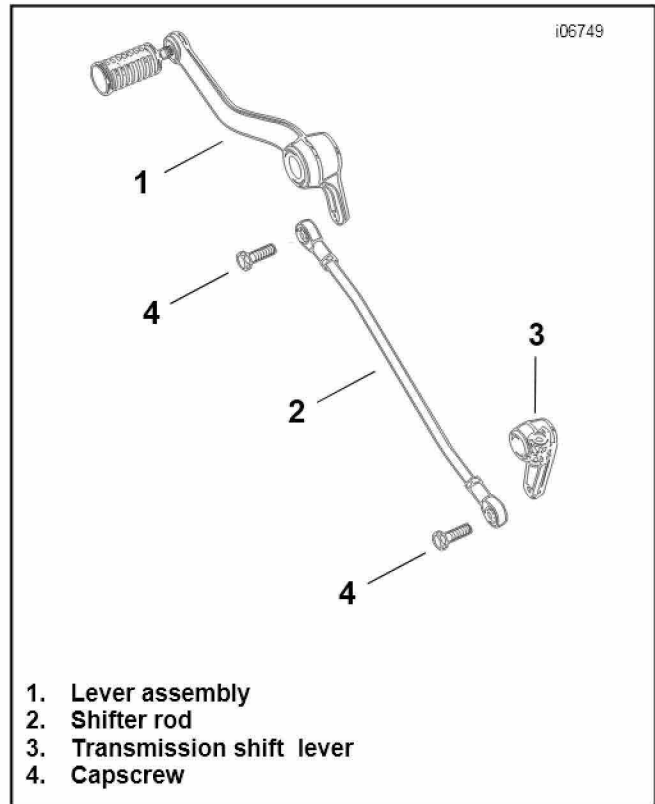

Figure 1. Shift Linkage Components



Service Parts

Part No. 34578-04 & others | Date 8/04

Stainless Steel Shift Linkage Kit

i06748

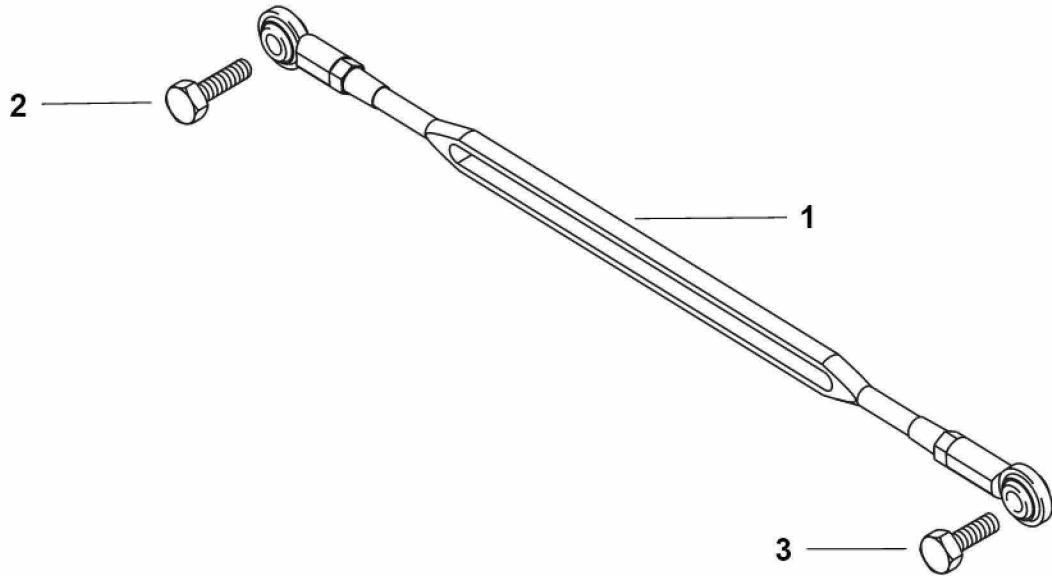

Item	Description	Part No.
1	Stainless steel shifter rod linkage	Not sold separately *
2	Capscrews w/LOC-PATCH® 5/16-18 x 7/8	4111
3	Capscrews w/LOC-PATCH® 5/16-18 x 1.0	4112

* Kit No. 34588-04, slotted, shown