



INSTRUCTIONS

-J02632

REV. 7-10-02

Kit Number 38629-02

STAINLESS STEEL BRAIDED CLUTCH KIT

General

This kit is designed to fit 2000-2003 Sportster 883STD, 883C, 1200S and 1200C model motorcycles.

See the Service Parts Illustration for kit contents.

WARNING

Rider safety depends on the correct installation of this kit. Follow the procedures in the appropriate Service Manual. If the procedures are not within your capabilities or if you do not have the correct tools, have your Harley-Davidson Dealer perform the installation. Improper installation could result in loss of control and death or serious injury.

WARNING

To protect against shock and accidental start-up of vehicle, disconnect the negative battery cable before proceeding. Inadequate safety precautions could result in death or serious injury.

WARNING

Always disconnect the negative battery cable first. If the positive battery cable should contact ground with the negative cable installed, the resulting sparks may cause a battery explosion which could result in death or serious injury.

NOTE

A Service Manual for your motorcycle is available at your Harley-Davidson Dealer.

Clutch Cable Removal

1. See Figure 1. Loosen clutch adjuster to obtain slack in the clutch cable (2) by performing the following:
 - a. Locate cable adjuster (1) and slide off rubber boot (4).
 - b. While holding cable adjuster with 1/2-inch wrench, loosen jam nut (3) using a 9/16-inch wrench.
 - c. Turn cable adjuster until there is a large amount of free play at hand lever.

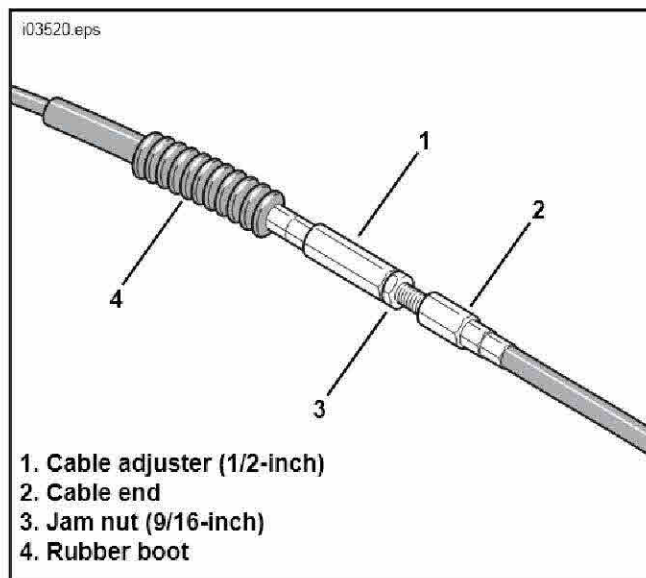

Figure 1. Clutch Cable Adjuster

2. See Figure 2. Remove retaining ring (3) and pivot pin (6).

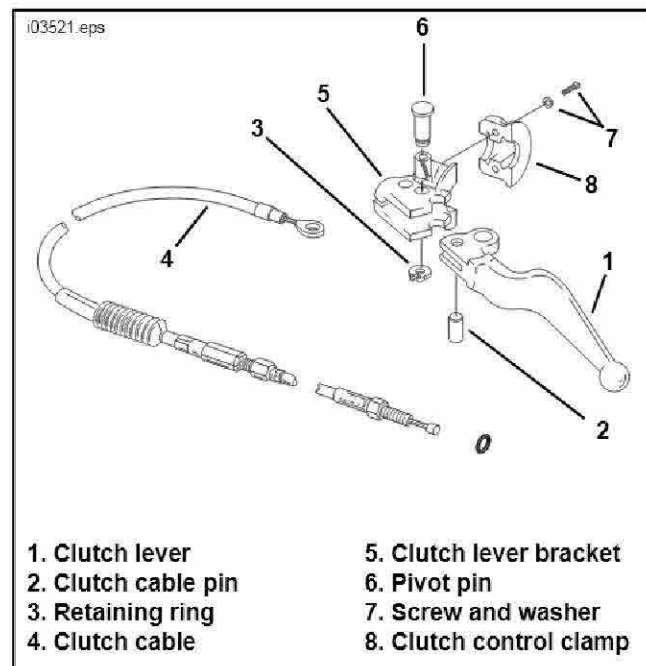

Figure 2. Clutch Cable Components

3. Remove clutch lever (1) from clutch lever bracket (5).
4. Remove clutch cable pin (2). Disconnect upper section of clutch cable (4) from lever (1).
5. See Figure 3. Using T-27 TORX driver, remove four TORX screws with washers (12) to remove clutch inspection cover (13). Exercise caution to avoid damaging or dislodging quad ring (3) in primary cover (1).

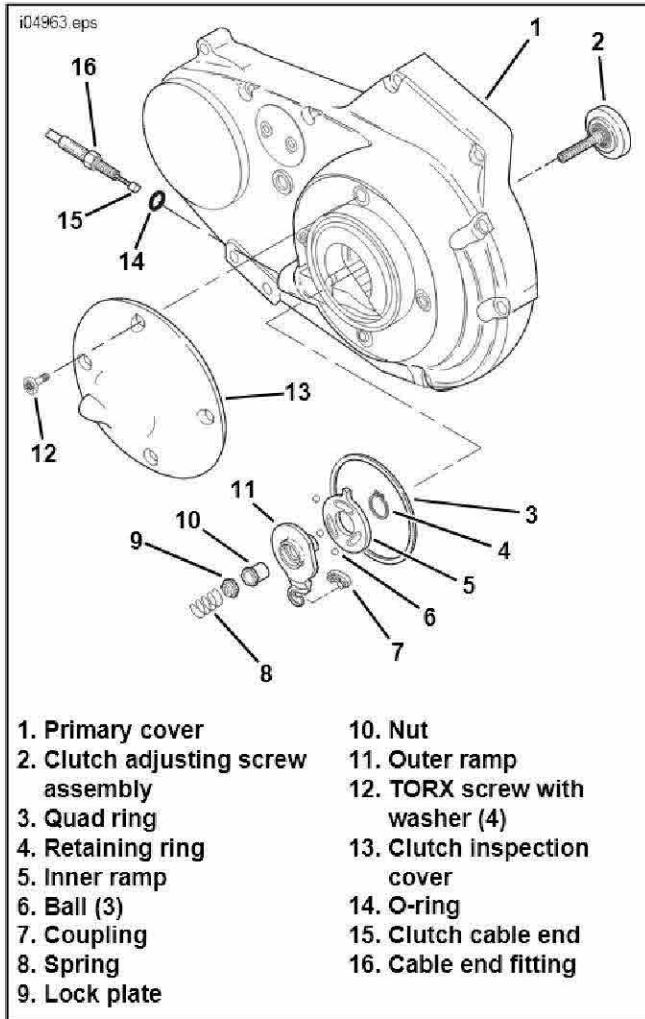

Figure 3. Clutch Release Mechanism

6. Slide spring (8) with attached hex lock plate (9) from flats of adjusting screw (2).
7. Turn adjusting screw clockwise to release ramp and coupling mechanism. As the adjusting screw is turned, ramp assembly moves forward. Unscrew nut (10) from end of adjusting screw.
8. Remove hook of ramp (11) from bottom at the rear of cable end coupling (7). Remove cable end (15) from slot in coupling.
9. Turn cable end fitting (16) counterclockwise to remove clutch cable lower section from primary cover (1). Remove o-ring (14) from cable end fitting.
10. Loosen cable clip at lower left front engine mount and remove clutch cable from vehicle.

Clutch Cable Installation

1. See Figure 3. Obtain Braided Stainless Steel Clutch Cable. Apply a light coat of oil on new o-ring (14) and install o-ring (Part Number 11179) onto threaded portion of clutch cable end (16). Turn fitting clockwise to install into primary cover (1). Tighten fitting to 3-5 ft-lbs (4-7 Nm).
2. Fit coupling (7) over cable end with the rounded side inboard and the ramp connector button outboard. With retaining ring side of ramp assembly facing inward, place hook of ramp around coupling button and rotate assembly counterclockwise until tang on inner ramp (5) fits in slot of primary cover (1).
3. Thread nut (10) on adjusting screw (2) until slot of screw is accessible with a screwdriver. Fit nut hex into recess of outer ramp (11) and turn adjusting screw counterclockwise.
4. Route clutch cable forward from primary cover upward through clip on lower left front engine mount to outboard side of left front slider tube, and then rearward to clutch lever. Tighten cable clip.
5. See Figure 2. Connect end of clutch cable upper section to clutch lever (1) using clutch cable pin (2).
6. Position lever within clutch lever bracket (5).
7. Follow instructions in applicable Service Manual and perform clutch cable adjustment.



Service Parts

Part No. 38629-02

Date 7/02

Stainless Steel Braided Clutch Cable Kit

104902.eps

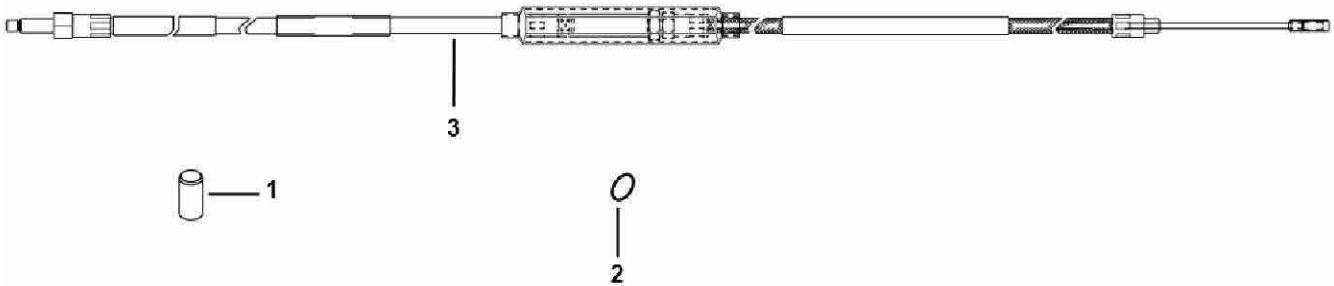

Item	Description	Part No.	Item	Description	Part No.
1	Pin, anchor	45036-88	3	Cable, clutch	Not sold separately
2	O-ring	11179			