



INSTRUCTIONS

-J02579

2010-06-25

CHROME OIL TEMPERATURE DIPSTICK W/LCD

GENERAL

Kit Number

62936-00B, 62937-00D, 62938-00D, 62939-00B, 62938-00E

Models

For model fitment information, see the P&A Retail Catalog or the Parts and Accessories section of www.harley-davidson.com (English only).

NOTE

This oil temperature dipstick is designed to be viewed at certain angles, such as when the rider is off of the vehicle and the vehicle is on the jiffy stand. The LCD display may not be visible at all angles, as while riding.

INSTALLATION

Installing the LCD Readout Dipstick

1. Remove the original equipment (OE) dipstick from the filler neck.

NOTE

Following installation, check for proper seating by gently lifting up on the dipstick. The dipstick should be locked in place.

2. Lightly oil the "O"-ring around the top of the new LCD dipstick. Orient the dipstick so that the display window is horizontal and readable from left to right, with the Bar and Shield logo to the left (toward the rear of the vehicle). Push the dipstick straight into the filler neck until it seats against the flat rubber seal.

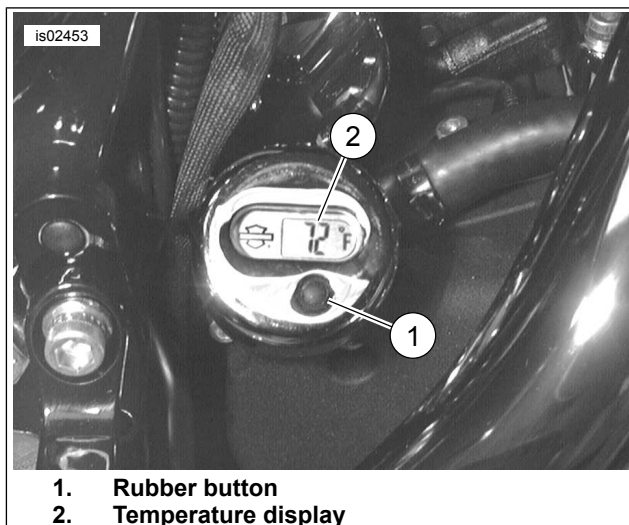

1. Rubber button
2. Temperature display

Figure 1. Dipstick Temperature Readout (Touring Model Shown)

USE

Removing the Dipstick

The dipstick assembly must be removed from the filler neck to check the oil level or to service the battery. Follow these procedures.

For LATER models (Kit 62937-00D, 62938-00D and 62938-00E):

NOTE

It is important to twist the dipstick in a COUNTER-CLOCKWISE direction WHILE PULLING UP to remove. Twisting in a clockwise direction or not twisting could result in damage to the dipstick.

Carefully twist counter-clockwise while pulling up to remove the dipstick from the filler neck. The dipstick should remove easily.

For EARLIER models (Kit 62936-00B or 62939-00B):

Carefully twist in either direction while pulling to remove the dipstick from the filler neck. The dipstick should remove easily. In some cases, it may be easier to remove the dipstick by just pulling straight up without twisting.

Displaying the Oil Temperature

See Figure 1. Press and release the rubber button (1) on the front face to display the temperature of the oil in the oil tank in degrees Fahrenheit (°F). The display (2) will automatically shut off after 5-7 seconds.

Changing the Display Mode

The display can be changed to read in degrees Centigrade (°C) by pressing and holding the button in for approximately 5 seconds, then releasing the button. The display will automatically shut off after 5-7 seconds. From then on, pressing and releasing the button will display the temperature in "°C".

Change back to "°F" display in the same way.

Extended Temperature Display

Press the button twice in rapid sequence to have the display remain on for an extended time. The display will automatically shut off after about 3 minutes. To manually shut off the display sooner, press the button once. The display will automatically shut off after 5-7 seconds.

Replacing the Battery

The LCD oil temperature display is powered by a long lasting, replaceable CR 2032 Lithium battery, part number 66373-06.



NOTICE

Read the following instructions and make sure you fully understand them prior to replacing the battery. If the procedure is not within your capabilities, or you do not have the correct tool, have a Harley-Davidson dealer replace the battery. Improper installation could result in damage to this product. (00419b)

1. See Figure 2. Carefully remove the flat rubber seal ring (1), and save for re-installation.

NOTE

Be extremely careful when separating the upper and lower display body assemblies.

2. Loosen the three small Phillips head screws on the underside of the display body until the screw heads contact the silver-colored ring on the lower assembly. Gently pull the lower assembly out of the upper display body as far as it will come, then continue to alternately loosen the screws and extract the lower assembly. Being extremely careful not to strain the wiring, gently separate the upper and lower display assemblies.

NOTE

Be careful not to disturb the thin rubber seal ring when performing the following procedures.

3. Note the battery orientation. Using a mechanics pick or a small screwdriver, carefully insert the tool under the battery (4). Gently pry battery free. Discard battery. Insert the new battery as shown and push battery down until seated.
4. Lining up the tab on the lower assembly with the notch in the upper body, assemble the two parts, being careful not to pinch the wiring. Alternately tighten the three screws while gradually seating the lower assembly, then tighten the screws securely.
5. Carefully replace the flat rubber seal ring.
6. Insert the dipstick into the filler neck. See Installation.
7. Check for proper operation by pressing the rubber button on the front face.

Service Kits

Service kits, which include all the replacement seals needed, are available from any Harley-Davidson Dealer.

For kits 62937-00D (1999 through 2006 Touring models) and 62938-00D and 62938-00E (1999 through 2005 Dyna models), use Service Kit Part Number 62984-03.

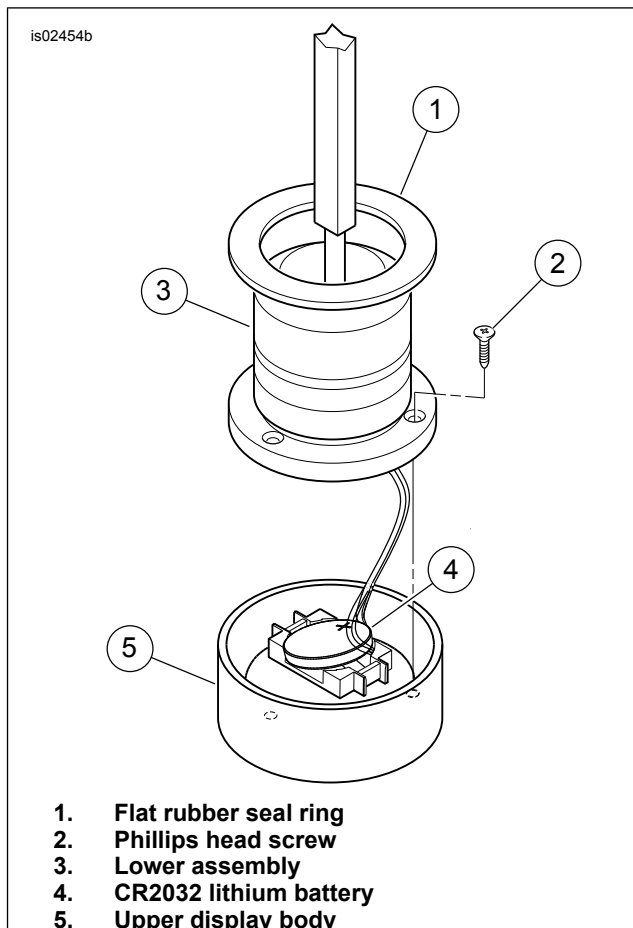

Figure 2. Dipstick Battery Replacement

Nature of the Liquid Crystal Display (LCD)

Due to the nature of an LCD, the readout will not display the oil temperature properly when the display body is exposed to extreme temperatures caused by heat transfer from the transmission case or oil tank. Typically this will happen only with the TC88 powertrain.

These extremes can occur in stop and go traffic and/or parade duty combined with a high ambient (outside air) temperature. If this situation occurs, DO NOT be alarmed. The LCD will not be damaged, and will function properly when the LCD has returned to a normal operating temperature.

Note also that the LCD may appear not to be reading properly after prolonged exposure to direct bright sunlight, but may appear as "888". This can be overcome by shading the display until the face temperature cools enough to achieve a proper reading.