



# INSTRUCTIONS

-J02294

2007-08-02

## CHROME RISER CUP WASHERS KIT

### GENERAL

#### Kit Number

56486-01

#### Models

For model fitment information, please see the P&A Retail Catalog or the Parts and Accessories section of [www.harley-davidson.com](http://www.harley-davidson.com) (English only).

#### Additional Parts Required

Loctite<sup>®</sup> 242 (blue) (P/N 99642-97)

#### ▲ WARNING

Rider and passenger safety depend upon the correct installation of this kit. Use the appropriate service manual procedures. If the procedure is not within your capabilities or you do not have the correct tools, have a Harley-Davidson dealer perform the installation. Improper installation of this kit could result in death or serious injury. (00333b)

#### NOTE

This instruction sheet references Service Manual information. A Service Manual for your model motorcycle is required for this installation and is available from a Harley-Davidson Dealer.

#### Kit Contents

See Figure 1 and Table 1.

#### INSTALLATION

#### NOTE

The following procedure is based upon a typical handlebar riser assembly. The handlebar riser assembly for your model

motorcycle may vary slightly from the illustration and procedure provided in this instruction sheet.

1. See Figure 1. Remove the four socket head screws (A, B) fastening the handlebar upper clamp (C) to the handlebar riser clamps (13, 14). Lift the handlebar (4) from the riser clamps and carefully rest the handlebar in front of the risers.

#### NOTE

Note the locations of spacers that may be used between handlebar risers and the handlebar upper clamp on early 1991 and earlier vehicles. Install these spacers in their original locations.

2. Remove the riser bolts (G) fastening the risers to the triple tree upper bracket.
3. Remove the risers from the triple tree upper bracket.
4. Replace the stock upper cup washers with the new chrome cup washers (1).
5. Assemble the handlebar riser assembly in reverse order of disassembly. Apply Loctite<sup>®</sup> 242 (blue) to the riser bolt threads and torque riser bolts (G) to:
  - **XL:**34–41 N·m (25–30 ft-lbs)
  - **Dyna and FXR:**41–54 N·m (30–40 ft-lbs)
  - **Softails:**34–47 N·m (25–35 ft-lbs)
6. Tighten the two rear socket head screws (A) until the handlebar upper clamp contacts the risers. Do not tighten the screws completely.
  - Torque the front screws (B) to 16–20 N·m (12–15 ft-lbs)
  - Torque the rear screws (A) to 16–20 N·m (12–15 ft-lbs)

#### NOTE

When installation is complete, the upper and lower clamp back edges must touch and show a slight gap between the front edges.



# SERVICE PARTS

is05132

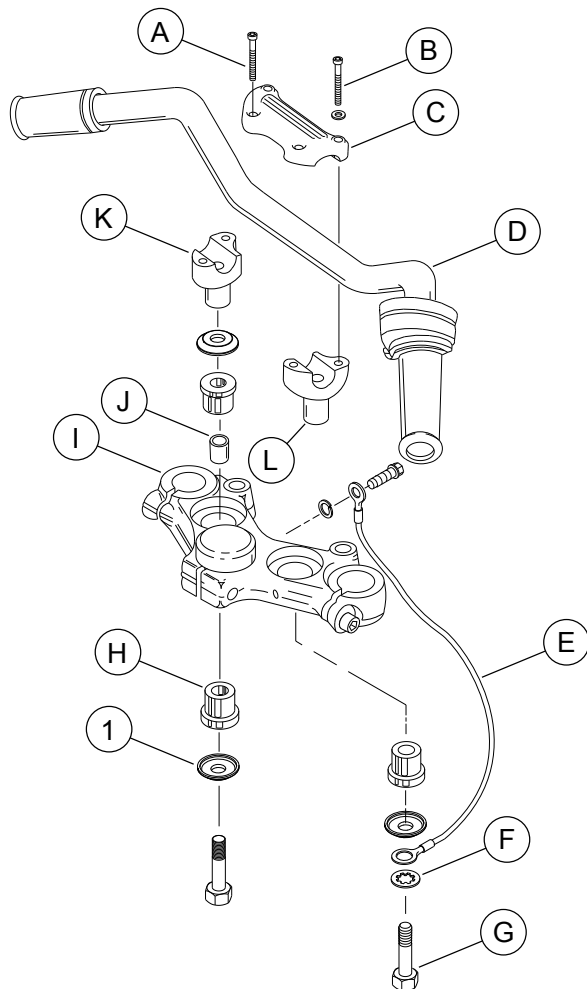

Figure 1. Service Parts: Chrome Riser Cup Washer Kit

Table 1. Service Parts Table

Kit	Item	Description (Quantity)	Part Number
Kit 56486-01	1	Chrome riser cup washer (4)	56487-01
<b>Items mentioned in text, but not included in kit:</b>			
	A	Socket head screw (2)	
	B	Socket head screw and washer (2)	
	C	Handlebar upper clamp	
	D	Handlebar	
	E	Ground wire	
	F	Lockwasher	
	G	Riser bolt (2)	
	H	Rubber bushing (4)	
	I	Triple tree upper bracket	
	J	Spacer (2)	
	K	Handlebar riser clamp, left	
	L	Handlebar riser clamp, right	