



INSTRUCTIONS

-J02140

REV. 3-29-01

Kit Number 65202-02

SPORTSTER 2-INTO-1 EXHAUST KIT

General

Fits 1986 and later XL models (except 1999 and later XL 1200C and XL 883C.) Will not work with Sportster Forward Control Kits, P/N 33891-98 and 33892-98. Limits adjustability of Adjustable Highway Peg Support Kit, P/N 49053-96. (Not designed for use with Harley-Davidson Saddlebags.)

NOTE

This kit is not legal for use on catalyst-equipped model motorcycles.

See Service Parts illustration for kit contents.

Installation

1. Remove stock exhaust system from motorcycle, including all mounting brackets and hardware.
2. Remove the stock muffler support bracket from the frame. Discard screws.
3. Install new mounting bar (2) to frame using screws (1), flat washers and locknuts (from item 8) from kit. Tighten locknuts to 33 ft-lbs (45 Nm).
4. Completely unscrew all of the hose clamps from kit. Feed the tail end of each hose clamp (from item 8) into the clips on the inside of both the front exhaust pipe and rear exhaust pipe heat shields (5, 6). Feed the tail end of the worm drive hose clamps (13 and 14) into the clips on the inside of the collector heat shield (4).

NOTE

The screw end of the hose clamp should be accessible, but not visible when the pipe is mounted on the motorcycle.

5. Install the new retaining rings (11) and the new flanges (9) onto both of the new head pipes.
6. Remove all exhaust gaskets from heads and discard. Install new exhaust gaskets (10) from kit.
7. Install the new header assembly (7) using stock exhaust pipe flange nuts (12) from kit. Leave nuts loose.
8. Install the stainless steel muffler clamp over the front end of the muffler.
9. Slide dog bone-shaped nut plate (from item 8) from the kit under the bracket that is welded to the backside of the muffler.
10. Slip the muffler (3) onto the collector of the header. Attach the muffler to the mounting bar using the two 5/16-18 x 5/8 in. long flange bolts (from item 8) in the kit.
11. Tighten flange nuts at cylinder heads to 60-80 in-lbs (7-9 Nm). To seat exhaust gaskets properly, alternate tightening on flange nuts until 60-80 in-lbs (7-9 Nm) is reached.

12. Tighten the stainless steel muffler clamp at the muffler slip joint to 10 ft-lbs (14 Nm). Tighten the 5/16-18 x 5/8 in. long flange bolts at the mounting bar to 19 ft-lbs (26 Nm).
13. Install the three new heat shields (4,5,6). Tighten the hose clamps evenly on all three heat shields.

CAUTION

Wipe all fingerprints off exhaust system. Failure to thoroughly clean system will result in oil from hands burning permanently into the finish of the exhaust system, damaging the cosmetic integrity of the pipes.

14. Start engine and check for exhaust leaks.

NOTE

Because the exhaust gaskets are "crush-type", they will leak slightly until they fill in with carbon.

15. After initial warm-up, let the engine cool and tighten the exhaust flange bolts to 60-80 in-lbs (7-9 Nm).

NOTE

Re-jetting may be required to realize full potential of this performance exhaust system. See your Harley-Davidson dealer for details.

WARNING

Installation of this kit may affect cornering clearance. This could distract the rider, causing loss of control and death or serious injury.

NOISE EMISSION WARRANTY

Harley-Davidson warrants that this exhaust system, at the time of sale, meets all applicable United States EPA Federal noise standards. This warranty extends to the first person who buys this exhaust system for purposes other than resale, and to all subsequent buyers. Warranty claims should be directed to an authorized Harley-Davidson Dealer or Harley-Davidson, Inc. Milwaukee, WI, (414) 342-4680.

TAMPERING PROHIBITION

Federal law prohibits any modification to this exhaust system which causes the motorcycle to exceed the federal noise standard. Use of the motorcycle with such a modified exhaust system is also prohibited.

CAUTION

This product should be checked for repair or replacement if the motorcycle noise has increased significantly through use. Otherwise, the owner may become subject to penalties under state and local ordinances.



Service Parts

Part No. 65202-02

Date 3/01

Sportster 2-Into-1 Exhaust Kit

103657.eps

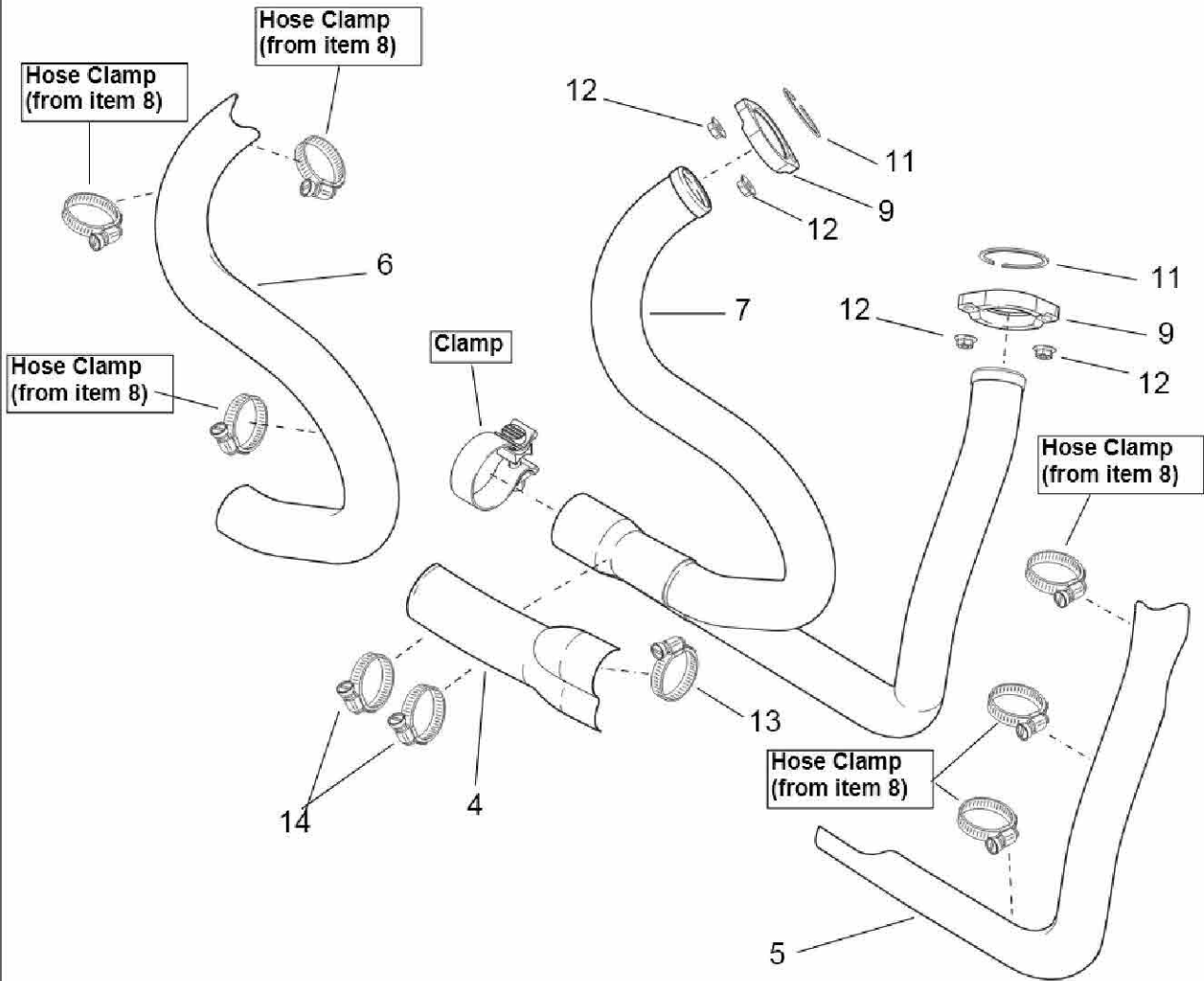

Item	Description	Part No.
1	Screw, 3/8-16 x 2, self-tapping (2) (not shown)	4377
2	Assembly, support bar, muffler (not shown)	64780-02
3	Muffler, XL 2-into 1 (not shown)	64783-02
4	Heatshield, collector	64784-02
5	Heatshield, front	64860-99
6	Heatshield, rear	64861-99
7	Header assembly	64785-02

Item	Description	Part No.
8	Hardware kit (not shown)	64864-99
9	Flange, exhaust pipe (2)	65184-02
10	Gasket, exhaust port (2) (not shown)	65324-83A
11	Retaining ring, exhaust gasket (2)	65325-83A
12	Flange nut, 5/16-24 (4)	7593
13	Clamp, worm drive, #28	9954
14	Clamp, worm drive, #24 (2)	9955