



INSTRUCTIONS

-J01623

REV. 10-9-00

Kit Number 46192-99 and 46193-99

SCREAMIN' EAGLE FORK BRACE KITS

General

These kits are designed for installation on 39mm or 41mm diameter forks. The following tabulations list Part No., finish and model applications.

NOTE

These brace kits are not recommended for forks with chrome lower fork legs.

39mm

Part Number	Finish	Models
46192-99	Chrome	1988 and later XL, 1987 FXLR and FXRS-SP, and all FXR (except FXRT), and FXD Dyna Wide Glide models (except FXDWG)

41mm

Part Number	Finish	Models
46193-99	Chrome	1993 and later FXDWG, 1999 FXSTB, and 1984 and later FXSTC

A Service Manual for your motorcycle is available at your Harley-Davidson dealership.

See Service Parts illustration for kit contents.

Installation

1. See Service Parts illustration on page 2. On all models except those equipped with 39mm forks, push the dust covers off of the sliders and up the fork tubes until out of the way. On models equipped with 39mm forks, the fork brace fits over the dust cover.
2. Using allen wrenches, remove screws (1) and end caps (5 and 6) from brace halves (3 and 4).
3. Loosen screws (2), push brace halves together and insert between fork tubes. Heads of screws (2) must face towards the engine.
4. Make sure brace is down tight on fork sliders (dust covers on 39mm fork equipped models) and install end caps (5 and 6). Lightly secure end caps with screws (1).
5. Align brace halves (3 and 4) tighten screws (2) finger tight.
6. Push down on front forks several times to seat fork brace and allow it to self-align.

CAUTION

It is very important to tighten all screws evenly and carefully to prevent binding.

7. Tighten end cap screws (1) and brace screws (2).
8. Slide dust covers down onto fork brace (except 39mm fork equipped models).

WARNING

Check clearance between fork brace and front end components such as brake hoses and cables. Check all clearances throughout the full travel range of the front suspension. Insufficient clearance may lead to loss of control of vehicle which could result in death or serious injury.



Service Parts

Part No. 46192-99 & 46193-99 | Date 10/00

Screamin' Eagle Fork Brace Kit

sp45421A

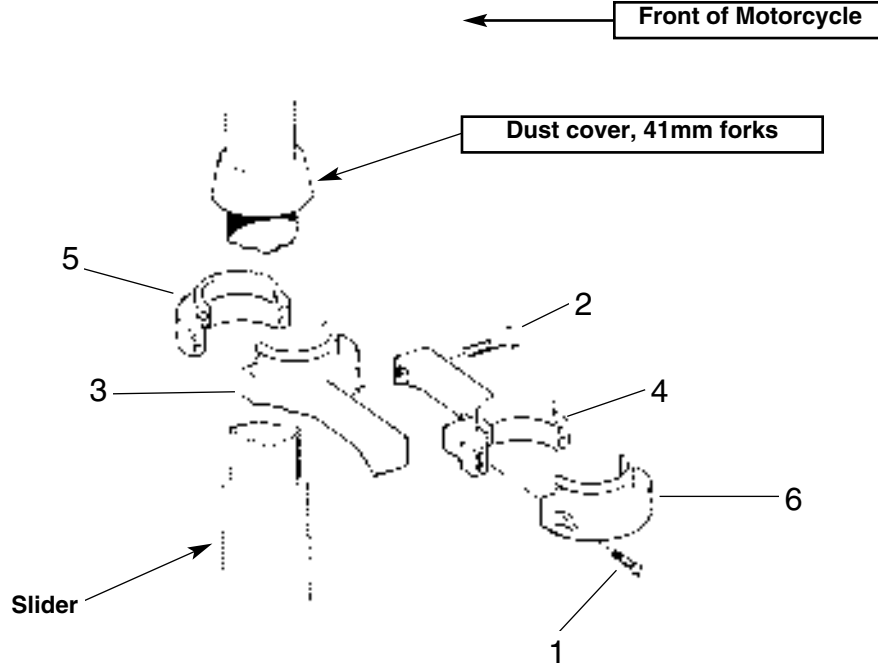

Kit Part No. 46192-99 and 46193-99

Item	Description	Part No.
1	Screw, socket head, 1/4-20 X .500 (4)	94774-99
2	Screw, socket head, 5/16-18 X 1.500 (2)	94775-99
3	Front brace half	Not sold separately
4	Rear brace half	Not sold separately
5	End cap, right	Not sold separately
6	End cap, left	Not sold separately