



# INSTRUCTIONS

-J01478

REV. 4-18-00

Kit Number 51598-00

## SEAT AND PILLION KIT

### General

This kit is designed for installation on 1986 and later XL model vehicles with 4.4 gallon fuel tanks.

### WARNING

Do not install this kit on XL models that are not equipped with passenger footpegs. On models not equipped with passenger footpegs, you must install Rear Footpeg Kit, Part No. 49105-83. Carrying a passenger without footpegs could result in death or serious injury to the passenger.

See Service Parts Illustration on page 2 for kit contents.

### CAUTION

While performing the following installation procedures, be careful not to scratch fender or other painted parts with metal bracket tabs on bottom of seat.

### Installation

1. See Figure 1. Remove and save screw and nylon washer securing seat to fender. Remove seat.
2. Remove screws, washers and nuts securing passenger grab strap (if vehicle is so equipped) and discard all components.
3. Install new seat bracket (9) on seat with bolts (10). Tighten bolts securely.

### CAUTION

Make certain you select the correct screw (from kit) in step 4. Attempting to install a coarse threaded screw in a fine threaded hole, or vice versa, will damage threads in weld nut in fender and on screw.

4. Select screw to secure grab strap to fender as follows:  
On 1995 and earlier models use: Screw, hex cap, 1/4-28 x 5/8 in.  
On 1996 and later models use: Screw, torx, 1/4-20 x 5/8 in.
5. See Figure 2. Locate grab strap, screw (selected above) and washer from kit. Insert screw through washer. Insert screw with washer through appropriate holes in grab strap as shown in Figure 2.
6. See Figure 1. Insert screw into hole in fender and tighten to 3 - 5 ft-lbs.
7. On 1986-1996 models, slip rear section of seat through grab strap. Bring seat forward and engage clip on bottom front of seat into seat bracket on frame. Secure seat to fender using original screw and nylon washer (11). (Install washer between seat bracket and fender.) Tighten screw securely.

### NOTE

For 1997 and later models with a stock solo seat, a retention nut and washer must be installed into the fender hole, covered with a plastic cap, where the rear seat bracket will be attached. A cable strap is included to aid in this installation.

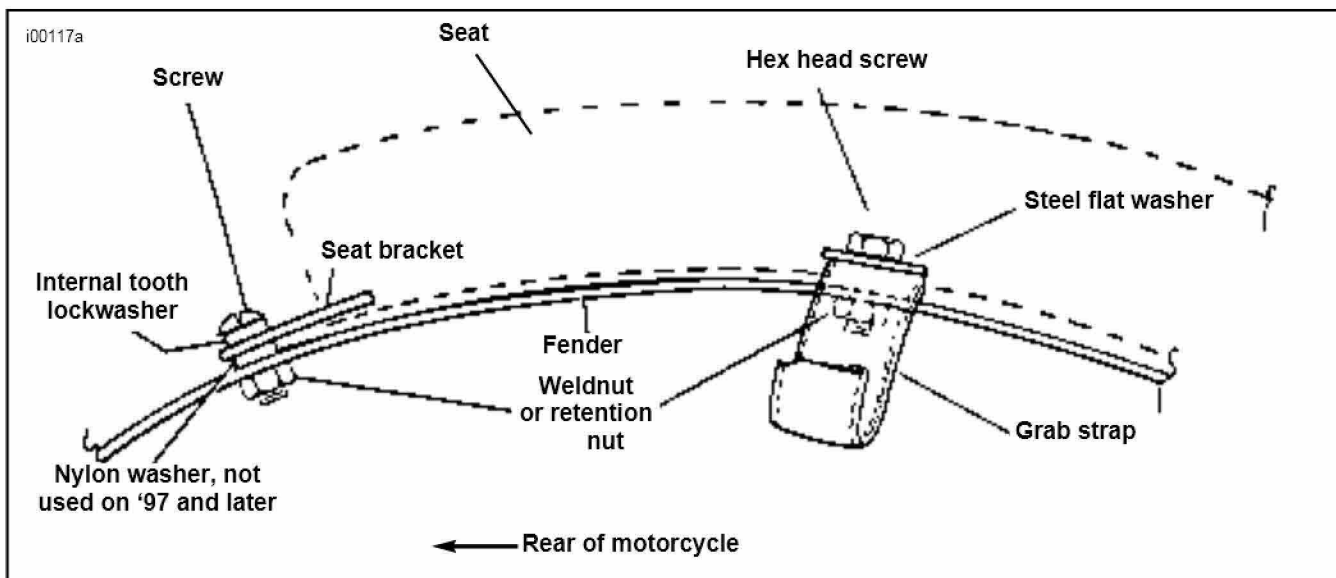

Figure 1. Hardware, Seat Bracket and Grab Strap Assembly

**For 1997 and Later Models:**

8. Remove plastic cap from hole in fender where the rear seat bracket will be attached.
9. Place retention nut over cable strap so wide end of nut rests on eye of cable strap. Thread cable strap up under fender and through fender hole. Pull up on cable strap to hold nut snug against underside of fender.
10. With rib on retention nut seated into notch in fender hole, slide retention washer into place from the rear. This will lock the retention nut in place. Remove cable strap.
11. Slip rear section of seat through grab strap. Bring seat forward and engage clip on bottom front of seat into seat bracket on frame. Secure seat to fender using original screw removed in Step 1. Tighten screw securely.

**NOTE**

Nylon washer removed in Step 2 is not required for 1997 and later models.

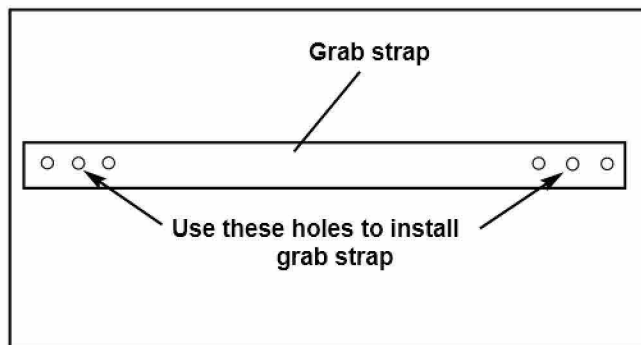

**Figure 2. Grab strap holes - 1986 and later only**

**WARNING**

After installing seat, pull upward on front of seat to be sure it is locked in position. If seat is loose, it could shift position during vehicle operation, resulting in loss of control of vehicle and death or serious injury.



# Service Parts

Part No. 51598-00

Date 9-99

## Seat and Pillion Kit

i00747

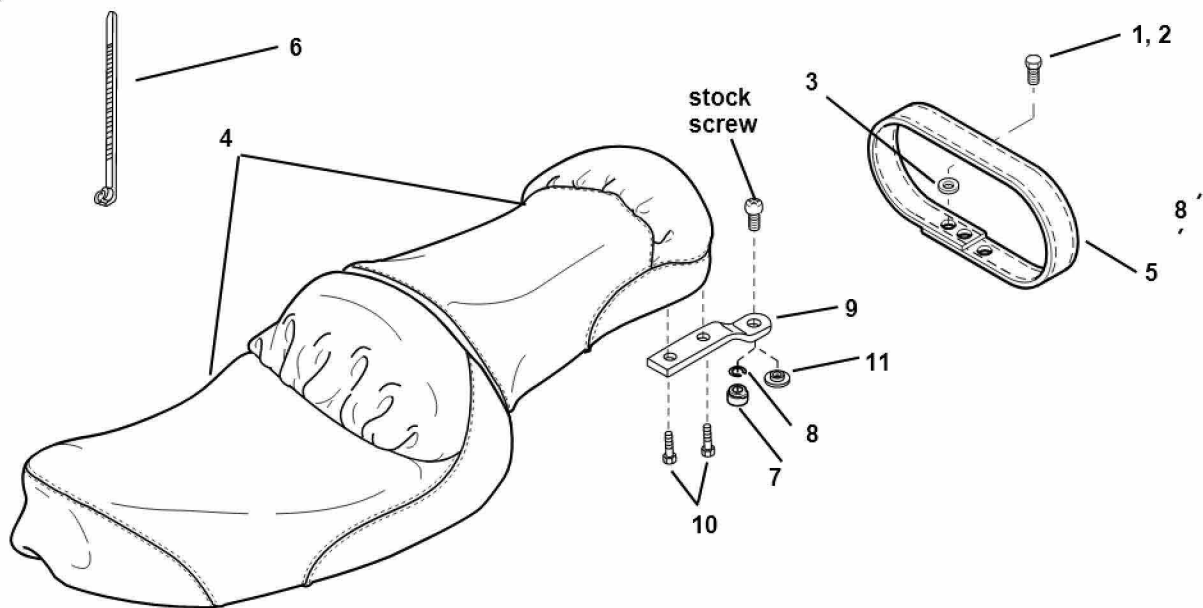

ITEM	DESCRIPTION	PART NO.	ITEM	DESCRIPTION	PART NO.
1	Screw, torx, 1/4-20 x 5/8 in (use on 1996 and later only)	941	6	Cable strap (for 1997 vehicles)	10039
2	Screw, hex cap, 1/4-28 x 5/8 in. (use on 1986 -1995 only)	3765	7	Retention nut (for 1997 vehicles)	7488
3	Washer, flat, 1/4 in. ID* x 1 in. OD** 6036 (use on 1986 and later only)		8	Retention washer (for 1997 vehicles)	7489A
4	Seat	Not sold separately	9	Mounting bracket	51652-97
5	Grab strap	53033-98	10	Screw, hex cap, 1/4-20 x 1/2 inch	3728
			11	Guide washer	7487

\*Inside diameter  
\*\*Outside diameter