



INSTRUCTIONS

-J01362

REV. 3-4-99

Kit Number 43979-98/ 43780-99

THUNDERSTAR™ CUSTOM 16 INCH REAR WHEEL KIT

General

These wheels are designed to fit 1986 and later XLH; 1986 and later Softail; 1991 and later FXD; 1986-1994 FXR, '99 FXR² and FXR³. See Service Parts for kit contents.

43979-98 is a chrome wheel kit.

43780-99 is a satin and black wheel kit.

Installation

Refer to the appropriate Service Manual for wheel removal and installation procedures.

See Service Parts Illustration. This kit contains the necessary parts for wheel installation, however, the following OE parts will be reused when you install your new chrome wheel:

Axle

Axle nut

Cotter pin or spring clip for axle nut

Brake

CAUTION

This wheel kit includes a stainless steel hub plate, P/N 43985-98, to be installed between the brake disc and the wheel.

These items are designed, and must be installed, to prevent water intrusion to the wheel, which could lead to an imbalance condition, and could adversely affect the handling of the motorcycle.

Maintenance and Cleaning

Chrome parts must be maintained regularly to ensure that they keep their original shine and luster.

1. Thoroughly clean chrome with a good quality chrome cleaner, such as S-100 Special Performance Wheel Cleaner, Part No. 99775-89T.
2. After cleaning and polishing, seal the finish with a good quality sealer such as Harley Glaze Polish and Cleaner, Part No. 99701-84.

CAUTION

Do not reuse brake disc screws. New Torx screws are provided for disc and chrome hub cap installation. Loss of torque on Torx fasteners could result in damage to rotor and/ or brake assembly.



Service Parts

Part No. 43979-98/ 43780-99 | Date 3/99

ThunderStar™ Custom 16" Rear Wheel Kit

sp43979a

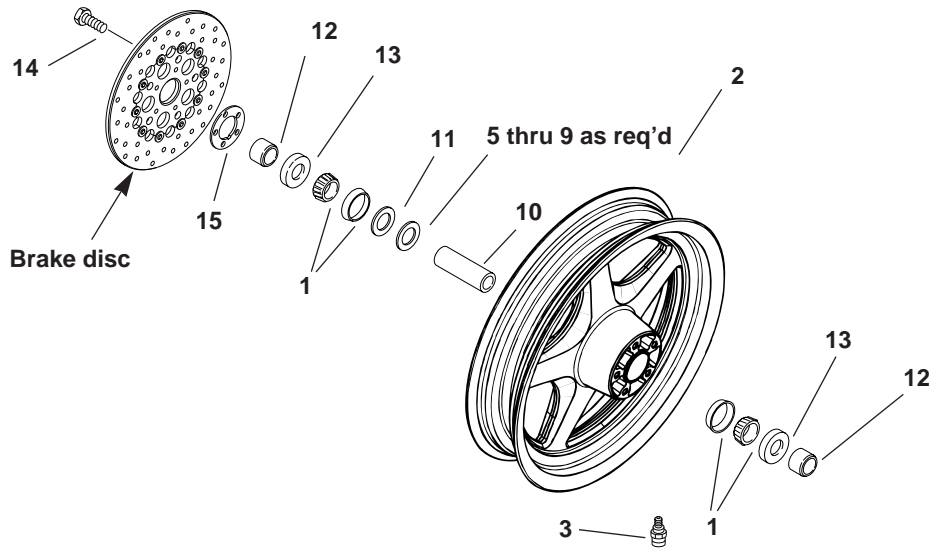

| Item | Description | Part No. | Item | Description | Part No. |
|------|---------------------------|-----------|------|-------------------------|-----------|
| 1 | Bearing assemblies (2) | 9052 | 8 | Spacer, 0.004 in. thick | 43293-82 |
| 2 | Thunderstar™ custom wheel | not sold | 9 | Spacer, 0.002 in. thick | 43294-82 |
| 3 | Valve stem assembly | 43157-83A | 10 | Spacer, bearing | 43608-82 |
| 4 | Rim label (not shown) | 43251-80A | 11 | Washer, spacer | 43650-82 |
| 5 | Spacer, 0.032 in. thick | 43290-82 | 12 | Wheel spacers (2) | 43654-86A |
| 6 | Spacer, 0.016 in. thick | 43291-82 | 13 | Oil seals (2) | 47519-83A |
| 7 | Spacer, 0.008 in. thick | 43292-82 | 14 | Brake disc screws (5) | 43567-92 |
| | | | 15 | Hub plate | 43985-98 |