



INSTRUCTIONS

-J01237

REV. 2009-11-05

SPORTSTER SHORTY DUAL SLIP-FIT MUFFLERS

GENERAL

Kit Numbers

80102-97, 80110-97, 80306-99, 80310-99, 80363-99

Models

These kits are designed to fit 1998-2003 XL (except 883R), 1992-2003 883 Hugger®, 1996-2003 XL1200C and 1992-2003 XL equipped with Profile Low Rear Suspension (54571-94A).

Additional Parts Required

Proper installation of this kit requires the separate purchase of two muffler clamps (65296-95A).

Due to the increased diameter of these mufflers (as compared with original equipment), some realignment of headpipes is usually required. It is recommended that the exhaust port gaskets (65324-83A) be replaced to avoid the tendency of the headpipes to return to the original position when tightened.

WARNING

The rider's safety depends upon the correct installation of this kit. Use the appropriate service manual procedures. If the procedure is not within your capabilities or you do not have the correct tools, have a Harley-Davidson dealer perform the installation. Improper installation of this kit could result in death or serious injury. (00333a)

NOTE

This instruction sheet references service manual information. A service manual for your model motorcycle is required for this installation and is available from a Harley-Davidson dealer.

Kit Contents

See Figure 1 and Table 1.

PRODUCT INFORMATION

Tampering Prohibition

Federal law prohibits any modification to this exhaust system which causes the motorcycle to exceed the Federal noise standard. Use of the motorcycle with such a modified exhaust system is also prohibited.

Noise Emission Warranty

Harley-Davidson warrants that these mufflers, at the time of sale, meets all applicable United States E.P.A. Federal noise

and Emissions standards. This warranty extends to the first person who buys these mufflers for purposes other than resale, and to all subsequent buyers. Warranty claims should be directed to an authorized Harley-Davidson Dealer.

NOTE

This product should be checked for repair or replacement if the motorcycle noise has increased significantly through use. Otherwise, the owner may become subject to penalties under state and local ordinances.

INSTALLATION

WARNING

To prevent accidental vehicle start-up, which could cause death or serious injury, remove main fuse before proceeding. (00251b)

1. Remove the main fuse.
2. Loosen stock muffler clamps.
3. The front muffler is held to a stud on the sprocket cover with a locknut. To access the locknut, remove the master cylinder mounting bolts and lift the brake pedal upward. Remove the locknut and remove front muffler.
4. Remove locknut and bolt that attaches rear muffler to muffler support and remove rear muffler.
5. Loosen head pipe nuts at cylinder head exhaust studs until headpipes move freely.
6. Install new mufflers and new muffler clamps and stock mounting hardware:
 - a. Tighten head pipe nuts to 6-8 ft-lbs (8-11 Nm).
 - b. Tighten locknut at sprocket cover stud to 20-40 ft-lbs (27-54 Nm).
 - c. Tighten muffler clamps to 35-40 ft-lbs (47-54 Nm).
 - d. Tighten locknut for rear muffler support to 10-15 ft-lbs (14-20 Nm).
 - e. Tighten master cylinder mounting bolts to 155-190 **in-lbs** (17-21 Nm).
7. Install the main fuse.

SERVICE PARTS

is00115

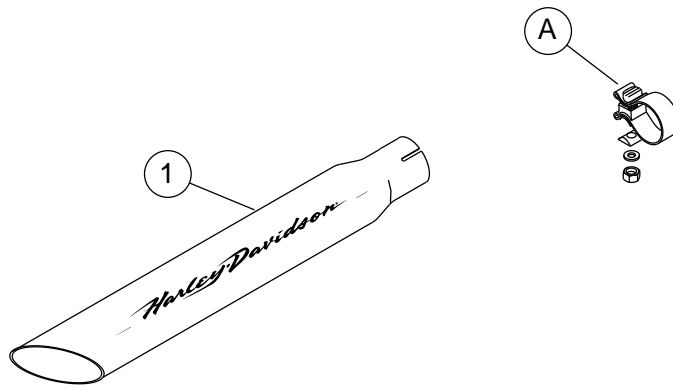

Figure 1. Dyna Slip-on Mufflers

Table 1. Service Parts Table

Kit	Item	Description (Quantity)	Part Number
80102-97	1	Slash cut	
		• Slash cut, rear	80150-97
		• Slash cut, front	80149-97
80110-97	1	Blunt cut	
		• Blunt cut, rear	80152-97
		• Blunt cut, front	80151-97
80306-99	1	Slash cut (black)	
		• Slash cut, rear (black)	80305-99
		• Slash cut, front (black)	80304-99
80310-99	1	Slash down (black)	
		• Slash down, rear (black)	80309-99
		• Slash down, front (black)	80307-99
80363-99	1	Slash down (black)	
		• Slash down, rear (black)	80361-99
		• Slash down, front (black)	80362-99
Items mentioned in text, but not included in kit:			
	A	Clamp, muffler (2)	65296-95A