



# INSTRUCTIONS

-J01211

REV. 6-26-03

Kit Number 25216-98

## SPORTSTER CHROME GEARCASE COVER TRIM KIT

### General

This kit is designed for installation on 1996 to 2003 XL (Sportster®) model motorcycles.

#### Kit contents:

Qty	Description
1	Gearcase cover
3	1/4-20 x 2-1/4 in. long screws (chrome)
1	1/4-20 x 1-1/2 in. long screw (chrome)
2	Spacers
2	Lockwashers
3	1/4-20 x 1-3/4 in. long screws (zinc)
2	1/4-20 x 2.0 in. long screws (zinc)
2	1/4-20 x 2-1/4 in. long screws (zinc)
7	flat washers

### Installation

1. See Figure 1. **ONE AT A TIME**, replace original sockethead capscrews in locations 1,2,3,4,7,9, and 10 on gearcase with zinc plated buttonhead screws from kit as follows:

Remove the screws one at a time, match the length of the removed screw with zinc plated buttonhead screws supplied in kit, then install zinc plated buttonhead screw, along with flat washer from kit, and tighten screw to 80-100 **in-lbs** (9-12 Nm). By replacing the original capscrews with zinc plated buttonhead screws from kit as described, the chrome gearcase cover will fit flush against the gearcase.

Remove screws from holes in positions 5,6,8, and 11.

2. Remove front muffler mounting bracket nut, pull muffler away from motorcycle, and put gearcase cover in place. It may be necessary to remove the two screws that hold the rear master cylinder in place in order to gain access to the muffler mounting nut.
3. See Figure 2. Install the four gearcase cover chrome buttonhead screws, lockwashers, and spacers (as shown in illustration) in positions 5,6,8, and 11 and tighten screws to 80-100 **in-lbs** (9-12 Nm).
4. Replace muffler mounting bracket nut. If rear master cylinder screws were removed, tighten them to 155-190 **in-lbs** (17.5-21.5 Nm).

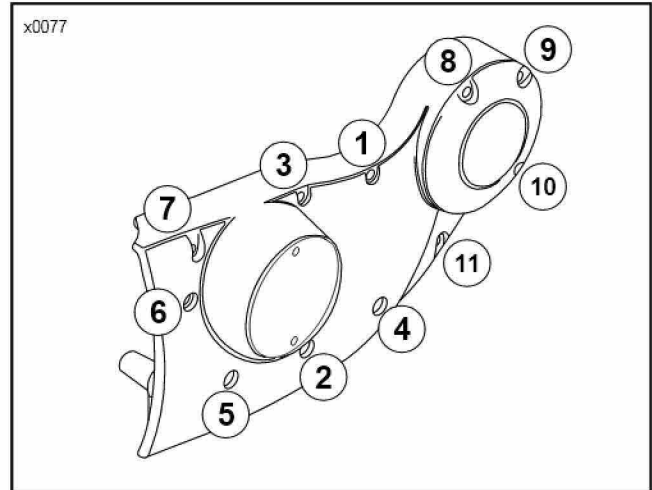

Figure 1. Gearcase

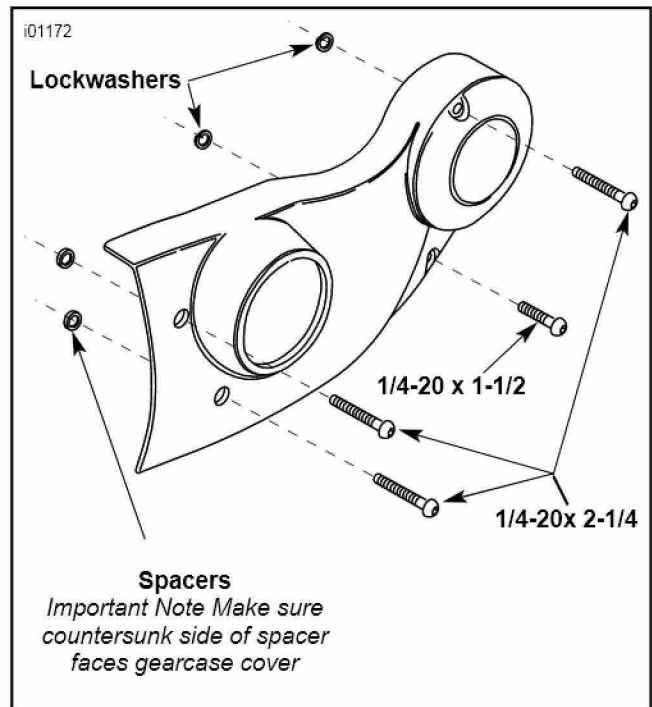

Figure 2. Installing Chrome Gearcase Cover