



# INSTRUCTIONS

-J00966

REV. 8-8-97

Kit Number 59234-98

## FUEL TANK INSTALLATION HARDWARE KIT

### General

This hardware kit is designed for installing the fuel tank in the Custom Paint Package 95708-98CC on 1997 and 1998 Sportster models.

#### NOTE

See *Service Parts* page for kit contents.

### Removing the stock fuel tank

#### ⚠ WARNING

To avoid accidental start-up of vehicle and possible personal injury, disconnect the battery cables before proceeding. Always disconnect the negative cable first. If the positive cable should contact ground with the negative cable installed, the resulting sparks may cause a battery explosion resulting in personal injury.

#### ⚠ WARNING

Gasoline is extremely flammable and highly explosive under certain conditions. Be sure engine is cold and do not smoke or allow open flames or sparks anywhere in the area while removing the stock fuel tank.

1. Turn fuel supply valve handle to OFF. Cut fuel hose clamp at bottom of fuel supply valve and remove hose.
2. Remove vacuum hose from fuel supply valve.

#### NOTE

To allow access to rear fuel tank mounting bolt on left side, cut the existing cable strap securing the main harness to the frame backbone. Move main harness as necessary to allow wrench clearance.

3. See Service Parts illustration. Remove front and rear mounting bolts and the associated hardware. Note the position of all parts so they will be reassembled correctly when new tank is mounted.
4. Disconnect vent elbow fitting from bottom right side of tank.

#### NOTE

The tank vent fitting is located on the bottom, right-rear of 1997 tanks and on the bottom right-middle of 1998 tanks.

5. See Figure 1.

**On 1998 models**, disconnect 90° elbow from tank vent fitting. Hose, fitting, and elbow will be reused with new tank.

**On 1997 models**, remove 90° elbow, fitting, and vent hose that runs from tank vent fitting to plastic tubing near front of seat. Discard 90° elbow, fitting, and vent hose.

6. Remove the stock fuel tank. Drain any gasoline in stock tank into a suitable, clean container. Remove fuel tank cap and retain for use on new tank.

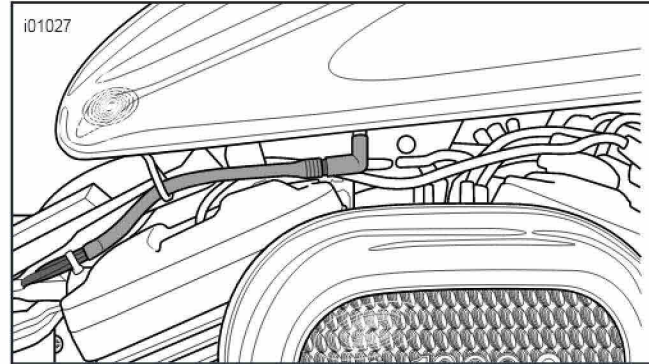

Figure 1. 1998 Tank Vent Hose

**On 1998 models**, reuse hose, fitting, and elbow shown

**On 1997 models**, replace hose, fitting, and elbow with new components from kit

7. See Service Parts illustration. Remove four T-spacers and retain for use on new tank.

#### NOTE

The valve fitting (nut) has right hand threads in the portion that attaches to fuel tank and left hand threads that mate with threads on the valve.

8. Note position of fuel supply valve. Turn the hex fitting that attaches the valve to the fuel tank counterclockwise and remove the valve, gasket, and filter assembly. Discard gasket, a new gasket is in kit. Retain all parts removed, except gasket, for use on new tank.

### Installing parts removed from old tank on new tank

1. Remove protective sleeves from vent tube and fuel valve fitting on bottom of tank, if present.
2. See Service Parts illustration. Install new grommets (3) from kit in holes of mounting tabs.
3. Install T-spacers in grommets as shown in Service Parts illustration.
4. Remove hex fitting from valve. Coat the valve and fuel tank threads with Loctite PIPE SEALANT WITH TEFLON.
5. Install new gasket (6) on valve and install filter strainer on gasket.
6. Thread hex fitting on right hand threads of fuel tank two turns. Hold hex fitting and thread valve into left hand threads of hex fitting for two turns.

#### ⚠ WARNING

Do not thread fitting onto valve more than two turns to avoid "bottoming" fitting on valve. This could cause a gasoline leak and/or fire hazard, and possible personal injury.

- Position valve as it was on stock tank and tighten hex fitting (clockwise) to 18 ft-lbs (24 Nm).

### Installing new tank

- See Service Parts illustration. Place fuel tank on frame. Install one washer on rear bolt and slide bolt through T-spacers and frame from left side.
- Install a second washer on rear bolt and install nut on rear bolt, but do not tighten.
- Install front bolt and hardware removed in step 3 of "Removing the stock fuel tank".

#### CAUTION

Check that wiring and hoses are not pinched between fuel tank and frame. Damaged wiring or hoses will result if they are pinched between fuel tank and frame.

- Tighten fuel tank mounting bolts to 8–16 ft-lbs (11–22 Nm).

#### CAUTION

Check clearance between front directional lights and fuel tank by turning handlebars full left and right. If directional lights contact tank, loosen mounting screws and rotate light forward. Damage to paint on fuel tank will result if directional lights contact fuel tank.

- Install vacuum line on fuel supply valve.
- Slip hose clamp (1) over fuel line, leaving clamp loose. Install fuel line on fuel supply valve and tighten clamp.

#### WARNING

Make certain fuel line will not contact hot or moving throttle parts. Fuel line contact with hot or moving parts could cause a fire hazard and possible personal injury.

- On 1998 models, reconnect large end of stock vent line elbow to tank vent fitting.

On 1997 models, See Service Parts illustration. Install small end of 90° vent line elbow (5) on tank vent fitting. Insert straight fitting (4) into 90° fitting. Install new vent hose (7) over rear plastic tube. Lay front of hose alongside of straight fitting to measure length, then cut hose to suit. Install hose over straight fitting.

- If cable strap was removed, install cable straps at rear of tank to secure main wiring harness and vent hose to frame backbone.
- Fill tank with gasoline and install cap from previously removed stock tank. Check valve and fuel line for leaks.

#### WARNING

Always connect the positive battery cable first. If the positive cable should contact ground with the negative cable installed, the resulting sparks may cause a battery explosion resulting in personal injury.

- Reconnect battery cables, positive cable first.



## Service Parts

Part No. 59234-98

Date 8/97

### Fuel Tank Installation Hardware Kit

sp59234

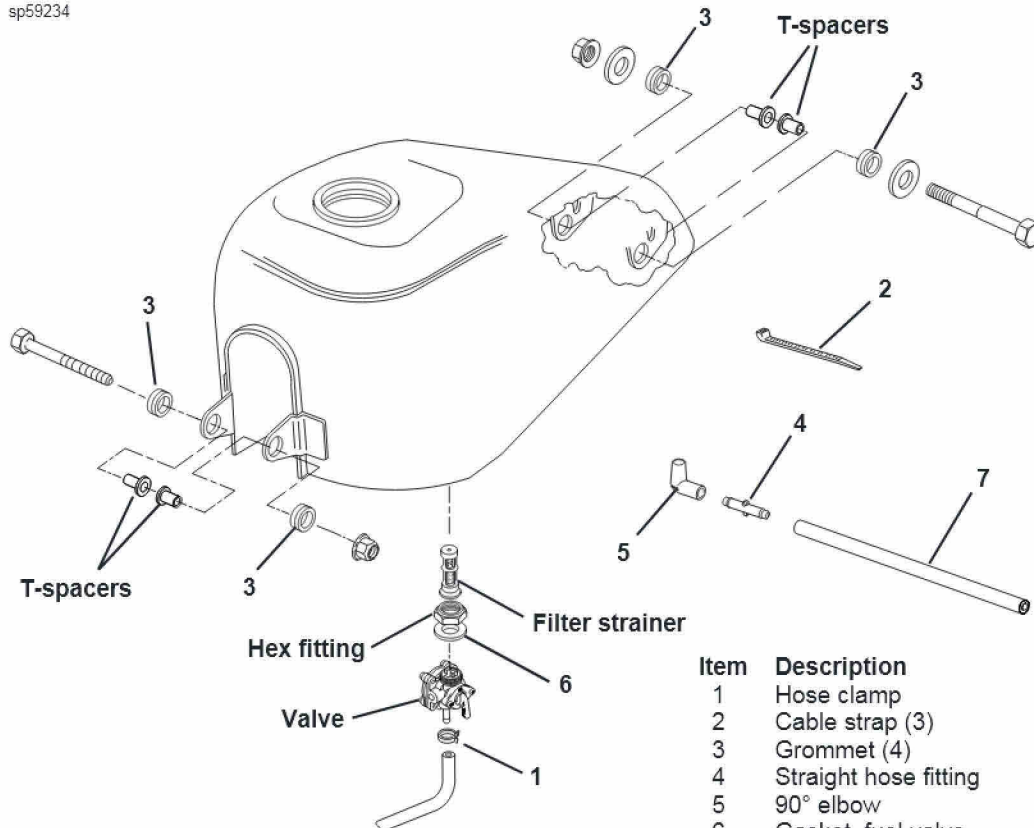

| Item | Description             | Part No.  |
|------|-------------------------|-----------|
| 1    | Hose clamp              | 9946      |
| 2    | Cable strap (3)         | 10006     |
| 3    | Grommet (4)             | 11473     |
| 4    | Straight hose fitting   | 27249-96  |
| 5    | 90° elbow               | 27250-96A |
| 6    | Gasket, fuel valve      | 62172-75  |
| 7    | Vent hose, 7.5 in. long | 27163-98  |