



INSTRUCTIONS

-J00664

REV. 10-3-96

Kit Number 53529-95A

'90 – '93 SPORTSTER DOCKING HARDWARE WITHOUT SADDLEBAG SUPPORTS

General

This kit is designed to fit 1990 to 1993 and Sportsters without saddlebags.

See Service Parts on page three for kit contents.

NOTE

A Service Manual for your vehicle is available from your Harley-Davidson Dealer.

Installation of Turn Signal Stalks and Rear Docking Points

NOTE

The rear turn signals must be relocated to the rearmost fender support bracket hole when installing this docking hardware kit. This involves cutting the turn signal wires as described in step 2 below.

⚠WARNING

To protect against shock, disconnect the battery cables (negative cable first) before performing any of the following procedures. If the positive cable should contact ground with the negative cable installed, the resulting sparks may cause a battery explosion resulting in personal injury.

1. Remove seat and disconnect battery cables, negative cable first.

NOTE

Perform the following procedures on one side of the motorcycle until instructed to go to the other side.

2. Reach under the fender and locate the fender clips that hold the turn signal wire in place. Bend the fender clips just far enough to free the wire and pull the wire down so it can be cut.

From the point where the turn signal wire passes through the fender at the turn signal stalk, measure along the wire 3 inches and cut through the conduit and wire. Discard the short piece of conduit that covered the 3 inch length of wire. Be careful to only cut the wire for the turn signal being worked on.

3. See Figure 1. Remove the screw, nut, and washer from the rearmost hole in the fender support bracket. After the hardware is removed, carefully drill out the rear hole of the fender support bracket and fender to a diameter of 0.390 in.
4. Remove the locknut and cupped washer that attaches the turn signal stalk to the fender support bracket. Discard the locknut and cupped washer. Remove the turn signal from the fender support bracket. Remove the turn signal stalk from the lamp housing and discard the stalk.

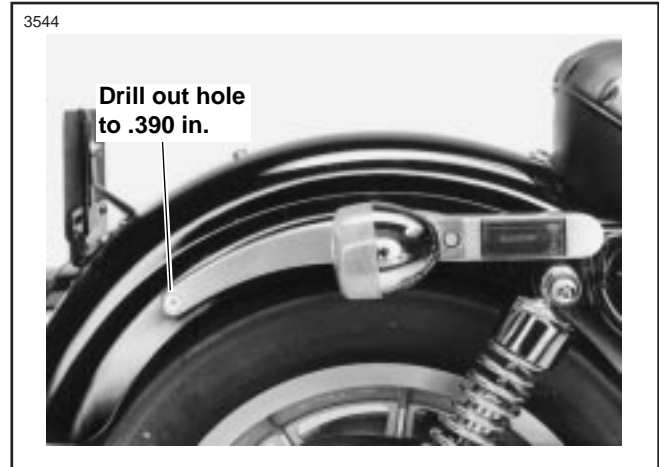

Figure 1. Rear Turn Signal and Fender Support Bracket

5. See the "Service Parts" Illustration. Slip the lockwasher (11) onto the short threaded end (5/16-24 x 3/8 in.) of the kit's turn signal stalk (6). Route the turn signal wire through the stalk as shown in the illustration. Apply Loctite® 242 (blue) on the stalk threads and screw the turn signal onto the stalk. Tighten the turn signal securely, taking care to avoid scratching the component's chrome finish.
6. Place the rear docking point (1) on the long threaded end of the turn signal stalk (6) so that the countersunk side of the docking point will face the fender support bracket.

⚠CAUTION

Make sure you use the fine (3/8-24) threaded nut (8) in the next step. Attempting to install the coarse (3/8-16) threaded nut (12) on the turn signal stalk will damage threads on both the nut and turn signal stalk.

7. Insert the turn signal stalk into the fender support bracket hole enlarged in step 3 and install the cup washer (3) and locknut (8). The locknut (8) must be in the cupped side of the cup washer (3). Torque the locknut (8) to 22 ft-lbs (30 Nm).

NOTE

Because the turn signal has been relocated, you will need to splice an additional length of wire into the turn signal wire.

8. Trim back the vinyl conduit 1 inch from the end of the turn signal wire that leads to the front of the fender (the wire that was cut in step 2). Strip a 3/8 in. section of insulation from each loose wire end. Strip a 3/8 in. section of insulation from both ends of one of the 12 in. long kit wires (10).
9. See Figure 2. Insert one end of the kit wire (10), and the end of the turn signal wire leading from the front of the fender, into opposite ends of a butt splice connector (7).

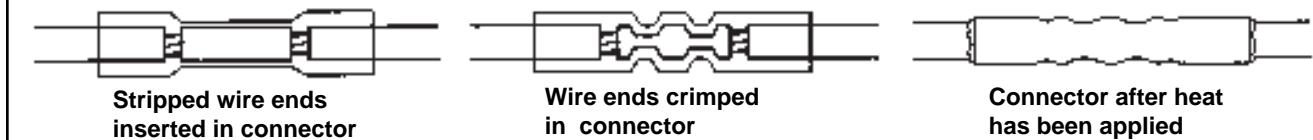

Figure 2. Install Sealed Butt Connectors

10. Match the color of the butt splice connector with the color of the crimp cavity of the crimping tool. Using a H-D 38125-8 crimping tool, crimp the wire ends into the connector.

⚠WARNING

- Use extreme caution when operating the UltraTorch UT-100 or any other radiant heating device. Read the manufacturer's instructions carefully before using the tool. Improper tool handling can result in personal injury.
- Always keep hands away from tool tip area and heat shrink attachment.
- Avoid directing the heat toward any fuel system component. Extreme heat can cause fuel ignition/explosion resulting in personal injury.
- Avoid directing heat toward any electrical system component other than the connectors on which heat shrink work is being performed.
- Be sure to turn the "ON/OFF" switch to the "OFF" position after use.

11. See Figure 2. Using the UltraTorch UT-100 (H-D 39969), Robinair Heat Gun (H-D 25070) with Heatshrink Attachment (H-D 41183), or other suitable radiant heating device, heat the crimped splice to encapsulate the butt splice connection. Apply heat from the center of the crimp out to each end until the meltable sealant exudes out of both ends of the connector.
12. Slip one of the 17 in. long pieces of kit conduit (9) over the wire that was spliced in the preceding step. Push the conduit far enough forward so that the stripped end of the spliced wire is showing.
13. Connect the kit wire section you have just spliced in place to the remaining loose turn signal wire leading from the turn signal lamp, using a butt splice connector as described previously.
14. With the kit wire spliced in place, pull the conduit (9) towards the turn signal lamp until the conduit covers all exposed wire.
15. Place the conduit covered turn signal wire into the fender clips and bend the fender clips back into place making sure the entire length of turn signal wire is held tight against the fender.

16. Repeat steps 2 through 15 for the turn signal on the other side of the motorcycle.

⚠WARNING

Always connect the positive battery cable first. If the positive cable should contact ground with the negative cable installed, the resulting sparks may cause a battery explosion resulting in personal injury.

17. Connect battery cables, positive cable first.
18. Install seat, then check the turn signals for proper operation.

⚠WARNING

After installing seat, pull upward on front of seat to be sure it is locked in position. If seat is loose, it could shift position during vehicle operation and startle the rider, causing loss of control and personal injury.

Installation of Front Docking Points

1. Remove the two plastic bushings, labeled **04**, from the bushing set (5) included in this kit. Discard the rest.
2. Place a bushing into each of the two front fender support bracket holes shown in the "Service Parts" illustration. The beveled sides of the bushings face out from the fender.
3. Install the front docking points (2) as shown in the "Service Parts" Illustration. For each front docking point, place the countersunk side of the docking point so that it engages the bushing. Insert a bolt (4) through each docking point (2) and into the fender, then install the cup washer (3) and locknut (12) on the inside of the fender. The locknut (12) must be in the cupped side of the cup washer (3). Torque the locknut (12) to 27 ft-lbs (37 Nm).

NOTE

In time docking points may wear, causing the mating luggage rack or sideplates to become loose. The fit may be tightened using the following procedure.

1. Loosen docking hardware
2. Rotate docking points clockwise approximately 45°.
3. Tighten docking hardware to the appropriate torque values.

Repeat as often as required, up to 3 times.



Service Parts

Part No. 53529-95A

Date 10/96

1990-1993 Sportster Docking Hardware Without Saddlebag Supports

sp53529-95

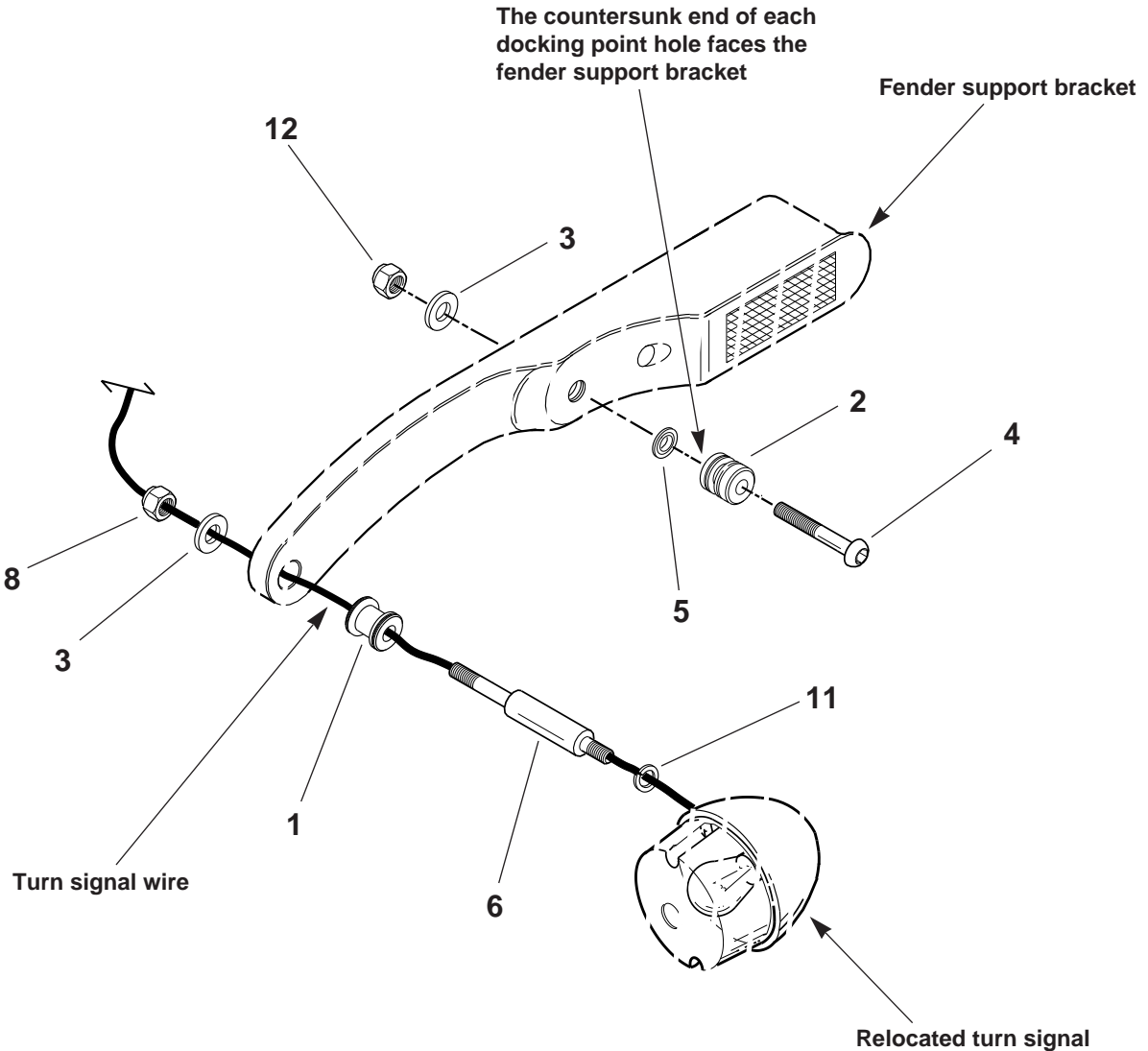

ITEM	DESCRIPTION	PART NO.	ITEM	DESCRIPTION	PART NO.
1	Rear docking points (2)	53684-96A	8	Locknuts, 3/8-24 x 9/32 x 9/16 (2)	7776W
2	Front docking points (2)	53687-96	9	Conduit, vinyl #3, 17 in. long	
3	Washers, Cup (4)	6056		[not shown]	not sold separately
4	Buttonhead bolts, 3/8-16 x 2-1/2 in. (2)	4157	10	Wires, 18 ga., 12 in. long (2)	
5	Bushing sets (2)	53696-96		[not shown]	not sold separately
6	Turn signal stalks (2)	53698-96	11	Lockwashers, 5/16, chrome (2)	94081-90T
7	Butt splice wire connectors (4)	70585-93	12	Locknuts, 3/8-16 x 7/16 x 9/16 (2)	7778
	[not shown]				