



INSTRUCTIONS

-J00619

REV. 3-5-99

Kit Number 52664-96A

XL PASSENGER PAD

General

This kit provides for installation of a passenger pad on all 1982 and later XL model vehicles using 52663-96 solo saddle. The Passenger Pad Kit contains the following items:

QTY.	DESCRIPTION
1	Passenger Strap
1	Plain Washer
1	TORX Button Head Screw
1	Hex Head Capscrew
2	Plain Washer
2	Lock Washer
2	Hex Head Capscrew
1	Passenger Pad
1	Cable strap
1	Nut, seat retention
1	Washer, retention

Removal

1. Remove screw, external tooth lockwasher and nylon washer to detach seat mounting bracket from rear fender.
2. Slide seat rearward to remove from frame.
3. Remove two bolts with lockwashers to free mounting bracket from bottom of stock seat.
4. If original stock seat is dual type, remove bolt and flat washer to detach passenger strap from rear fender.

Installation

1. Inspect new passenger strap. Note that one end of strap has 3 holes, while the other end has 2 holes. Loop passenger strap so that middle hole on 3-hole side and outside hole on 2-hole side are aligned with forward hole in rear fender.
2. Align hole in flat washer with those in fender and passenger strap. Install bolt and tighten to 8-13 ft-lbs (11-18 Nm). Be sure to use the fine threaded hex head capscrew on 1995 and earlier models. Use the coarse threaded TORX button head screw on 1996 and later models.

CAUTION

Make certain you select the correct kit screw in step 2. Attempting to install a coarse threaded screw in a fine threaded hole, or vice versa, will damage threads.

3. Using two hex head capscrews with lockwashers and flat washers (supplied in kit), fasten passenger pad to bottom of solo saddle. Tighten capscrews securely.
4. To install seat assembly, push on rear corners of passenger pad to compress foam and slide rear of pad through installed passenger strap.
5. To properly position saddle on frame, slide seat forward until tongue welded to center frame support fits snugly in groove at bottom of saddle.

WARNING

After installing seat, pull upward on front of seat to be sure it is locked in position. If seat is loose, it could result in shifting during vehicle operation, loss of control of vehicle, death or serious injury.

For 1996 and earlier models:

6. Using original hardware, install screw, external tooth lockwasher and nylon washer to fasten seat mounting bracket to rearward hole in top of rear fender.

NOTE

Install the nylon washer between fender and seat mounting bracket to prevent damage to fender paint.

7. Pull up on seat again to verify that it is properly secured, front and rear.

NOTE

For 1997 models with a stock solo seat, a retention nut and washer must be installed into the fender hole, covered with a plastic cap, where the rear seat bracket will be attached. A cable strap is included to aid in this installation.

For 1997 and later models:

8. Remove plastic cap from hole in fender where the rear seat bracket will be attached.
9. See Service Parts Illustration. Place retention nut (10) over cable strap (9) so wide end of nut rests on eye of cable strap. Thread cable strap up under fender and through fender hole. Pull up on cable strap to hold nut snug against underside of fender.

10. With rib on retention nut seated into notch in fender hole, slide retention washer (11) into place from the rear. This will lock the retention nut in place.
11. Using original hardware, install screw and external tooth lockwasher to fasten seat mounting bracket to rearward hole in top of rear fender. Tighten the screw securely.



Service Parts

Part No. 52664-96A

Date 3/99

XL Passenger Pad Kit

sp52664a

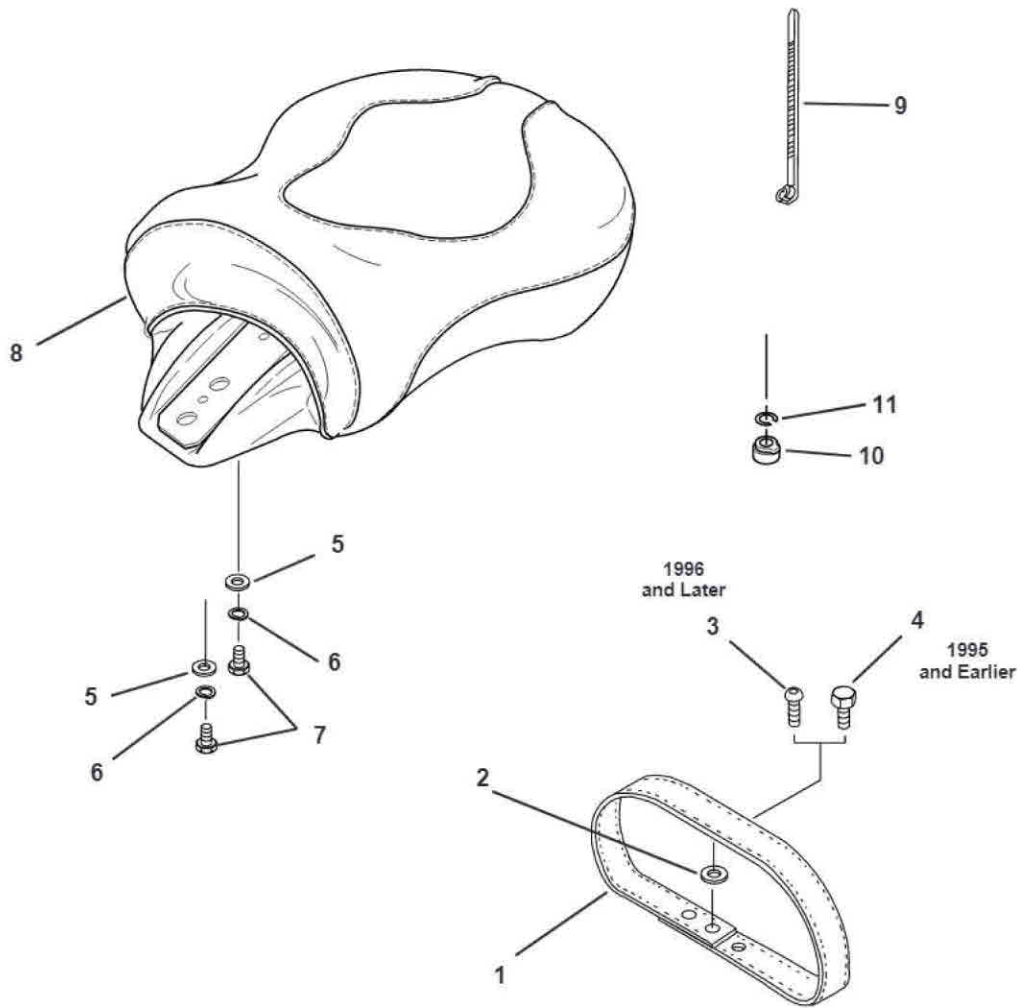

Item	Description	Part No.	Item	Description	Part No.
1	Passenger Strap	51187-94A	6	Lockwasher (2)	2551W
2	Plain Washer	6036	7	Hex Head Capscrew (2)	Not sold separate
3	TORX Button Head Screw	941	8	Passenger Pad	10039
4	Hex Head Capscrew	3765	9	Cable strap	7488
5	Plain Washer (2)	6235	10	Nut, seat retention	7489A
			11	Washer, retention	