



INSTRUCTIONS

-J00618

REV. 5-23-2003

Kit Number 52663-96A

XL SOLO SADDLE

General

This kit provides for replacement of the original stock seat on all 1982 -2003 XL model vehicles.

This kit contains the following:

QTY	DESCRIPTION	PART NO.
1	Solo saddle	Not sold separately
1	Chrome cap	762

NOTE

Service part is listed above. A Service Manual for your motorcycle is available from your Harley-Davidson Dealer.

Removal

1. See Figure 1. Remove screw, external tooth lockwasher and nylon washer to detach seat mounting bracket from rear fender.
2. Slide seat rearward to remove from frame.
3. Remove two capscrews with lockwashers to free mounting bracket from bottom of stock seat.
4. If original stock seat is dual type, remove bolt and flat washer to detach passenger strap from rear fender.

Installation

1. Install two capscrews with lockwashers to fasten mounting bracket to bottom of new solo saddle. Tighten capscrews securely.

2. Position solo saddle on frame with mounting bracket at rear.
3. Slide seat forward until tongue welded to center frame support fits snugly in groove at bottom of solo saddle.

WARNING

After installing seat, pull upward on front of seat to be sure it is in locked position. While riding, a loose seat can shift causing loss of control, which could result in death or serious injury. (00070a)

4. Install screw, external tooth lockwasher and on 1996 and earlier models nylon washer to fasten seat mounting bracket to forward hole in top of rear fender. On 1997 - 2003 models, the nylon washer is not required. The chrome cap is to be installed in rear fender retention nut threads to enhance appearance.

CAUTION

On 1996 and earlier models, install the nylon washer between fender and seat mounting bracket to prevent damage to fender paint.

5. Pull up on seat again to verify that it is properly secured, front and rear.

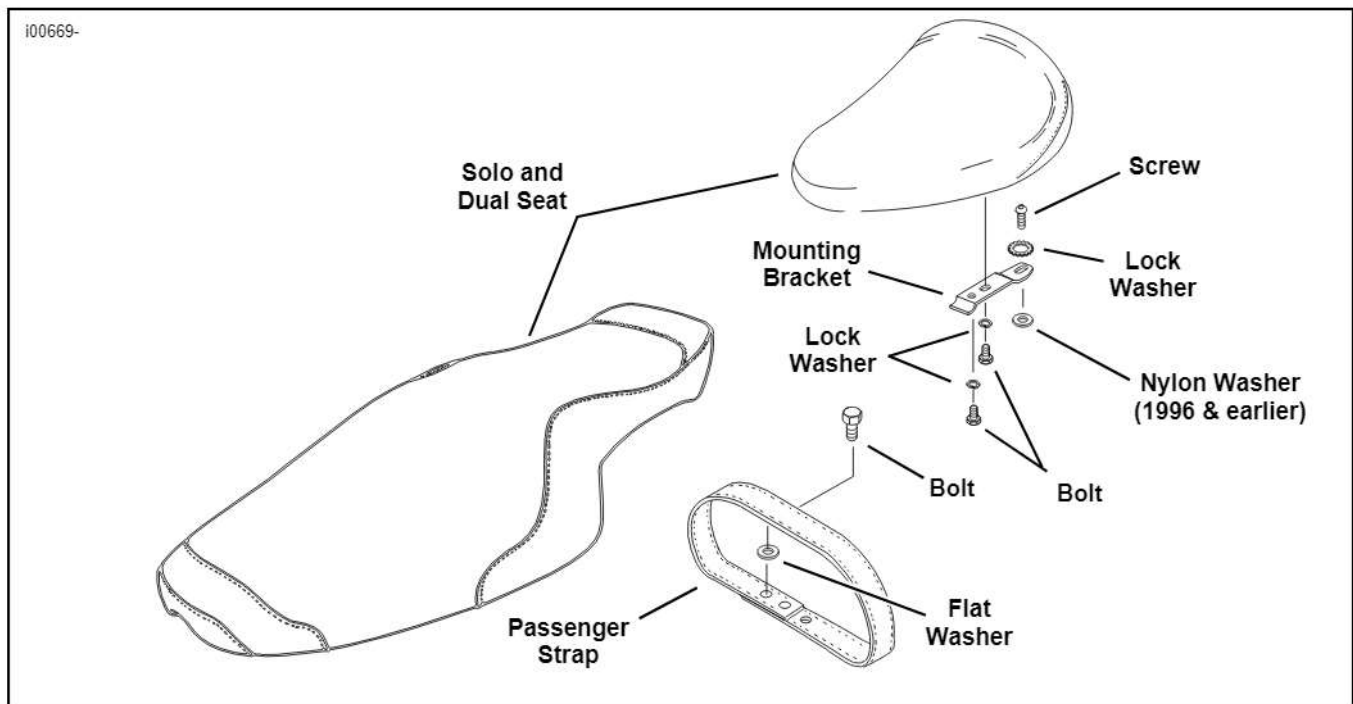

Figure 1. Original Stock Seat and Hardware