



# INSTRUCTIONS

-J00287

REV. 9-29-2003

Kit Number 56078-96A

## 1996 XLH 883 SPORTSTER BUCKHORN HANDLEBAR KIT

### General

This kit is designed for installation on 1996 -2003 XLH 883 Sportster models.

Kit contents:

QTY	DESCRIPTION
1	Gasket, clutch cover
1	Clutch cable
2	Gasket, brake
2	Gasket, banjo
1	Pin
1	Brake line, front
4	Retainer, wire
1	Handlebar
1	Handlebar grip
1	Idle control assembly
1	Throttle control assembly

### Installation

#### **WARNING**

Rider safety depends on the correct installation of this kit. Use the appropriate Service Manual procedures. If the procedures are not within your capabilities, or if you do not have the correct tools, have your Harley-Davidson dealer perform this installation.

#### NOTE

These installation steps are intended to serve only as a general guideline of installation sequences. Refer to the appropriate Service Manual for important information concerning these steps.

A Service Manual for your vehicle is available from your Harley-Davidson dealer.

An asterisk (\*) marks each step that has a detailed procedure within the Service Manual.

1. \*Remove seat

#### **WARNING**

To prevent accidental vehicle start-up, which could cause death or serious injury, disconnect negative (-) battery cable before proceeding. (00048a)

#### **WARNING**

Disconnect negative (-) battery cable first. If positive (+) cable should contact ground with negative (-) cable connected, the resulting sparks can cause a battery explosion, which could result in death or serious injury. (00049a)

2. Disconnect battery (negative cable first).
3. \*Drain front brake system. Remove and discard front brake hose.

#### CAUTION

Do not disconnect or remove the brake switch housing assembly without first placing a 5/32 inch thick cardboard insert or cable strap eyelet between the brake lever and lever bracket (See Figure 1). Housing removal/installation without an insert may result in damage to the rubber boot and plunger of the stoplight switch.

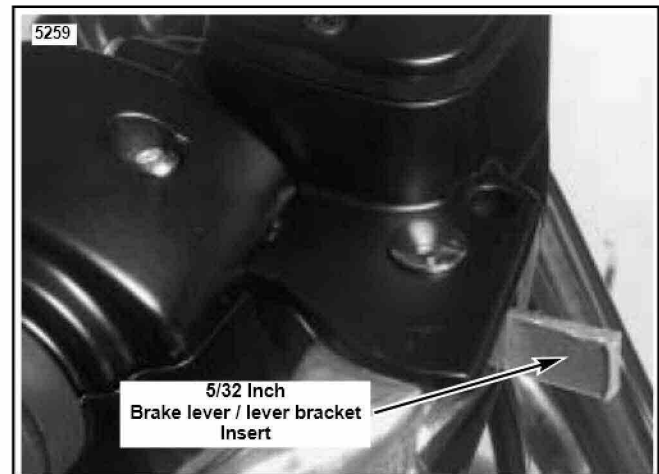

Figure 1. Brake Lever / Lever Bracket Cardboard Insert

4. \*Remove hand controls and switches. Let wires carefully support the switches.
5. \*Remove and discard throttle cables.
6. \*Remove top handlebar clamps, mounting hardware, and gauge(s). Carefully let wires support gauge(s).
7. Remove handlebars.
8. Install buckhorn handlebars. Do not fully tighten handlebar clamp screws.
9. Adjust handlebars to desired position. Tighten front screws to 12-15 ft-lbs. Tighten rear screws to 12-15 ft-lbs. A slight gap between clamp halves should exist at the front.
10. To install new left handgrip:
  - a. Using a piece of emery cloth, rough grip end of left buckhorn handlebar.

**NOTE**

Before applying adhesive in the next step, clean the left buckhorn handlebar with acetone.

- b. Apply LOCTITE PRISM PRIMER (770) to inside of handgrip. Remove any excess PRISM PRIMER. Wait two minutes for PRISM PRIMER to set before beginning the next step.
- c. Apply LOCTITE PRISM SUPERBONDER (411) to inside of handgrip. Place new handgrip on left buckhorn handlebar.

**NOTE**

SUPERBONDER will set in four minutes and be fully cured in 24 hours.

- 11. \*Remove the old clutch cable. Install new clutch cable from kit.
- 12. Replace clutch cover gasket with new gasket from kit.
- 13. \*Place throttle control grip in position. Install new throttle cables from kit and right handlebar switch assembly. Use new wire harness retainers to secure the wires to the handlebars.
- 14. \*Install front brake master cylinder.

See Figure 2. Position brake lever/master cylinder assembly inboard of the switch housing assembly.

Engage the tab on lower switch housing in groove at top of brake lever bracket.

- 15. Align holes in handlebar clamp with holes in master cylinder housing. Start the two screws (with flat washers). Position this assembly for rider comfort.

Beginning with the top screw, tighten screws to 60-80 in-lbs (6.8-9.0 Nm) using a T27 TORX drive head.

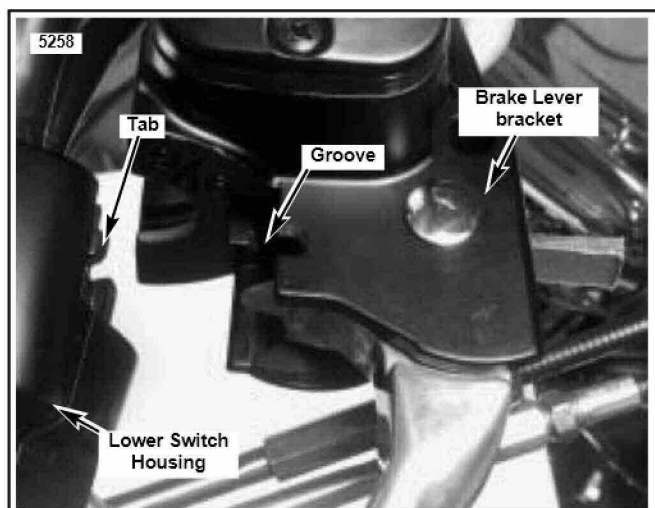

Figure 2. Brake Lever / Master Cylinder fit to Right Handlebar Lower Switch Housing

- 16. Using a T25 TORX drive head, tighten lower and upper switch housing screws to 30-40 in-lbs (3.4-4.5 Nm).

**NOTE**

Always tighten the lower switch housing screw first so that any gap between the upper and lower housings is at the front of the switch.

- 17. Remove the insert between the brake lever and lever bracket.
- 18. Test switches for proper operation.
- 19. If necessary, secure wire harness conduit to handlebar using new cable strap. Position cable strap approximately 4-5 inches from handlebar clamp. Cut any excess cable strap material.
- 20. Note lettering for proper orientation and gently push keycaps onto switch shafts.
- 21. \*Install left handlebar switch controls. Use new wire harness retainers to secure the wires to the handlebars. Install clutch hand controls and adjust clutch.
- 22. \*Install new brake hose using new banjo fitting gaskets.
- 23. \*Fill front brake master cylinder. Bleed front brake system.

**WARNING**

Connect positive (+) battery cable first. If positive (+) cable should contact ground with negative (-) cable connected, the resulting sparks can cause a battery explosion, which could result in death or serious injury. (00068a)

- 24. Reconnect battery, positive cable first.

**WARNING**

After installing seat, pull upward on front of seat to be sure it is in locked position. While riding, a loose seat can shift causing loss of control, which could result in death or serious injury. (00070a)

- 25. \*Reinstall seat

**WARNING**

Brakes are a critical safety component. Contact a Harley-Davidson dealer for brake repair or replacement. Improperly serviced brakes can adversely affect brake performance, which could result in death or serious injury.

**WARNING**

After completing this installation and bleeding the system, always test motorcycle brakes at low speed. If brakes are not operating properly, or braking efficiency is poor, testing at high speeds could result in death or serious injury.

- 26. Test clutch, electrical, and brake functions. Adjust headlamp.



# Service Parts

Part No. 56078-96A

9/03

1996 XLH 883 BUCKHORN HANDLEBAR KIT

sp56078

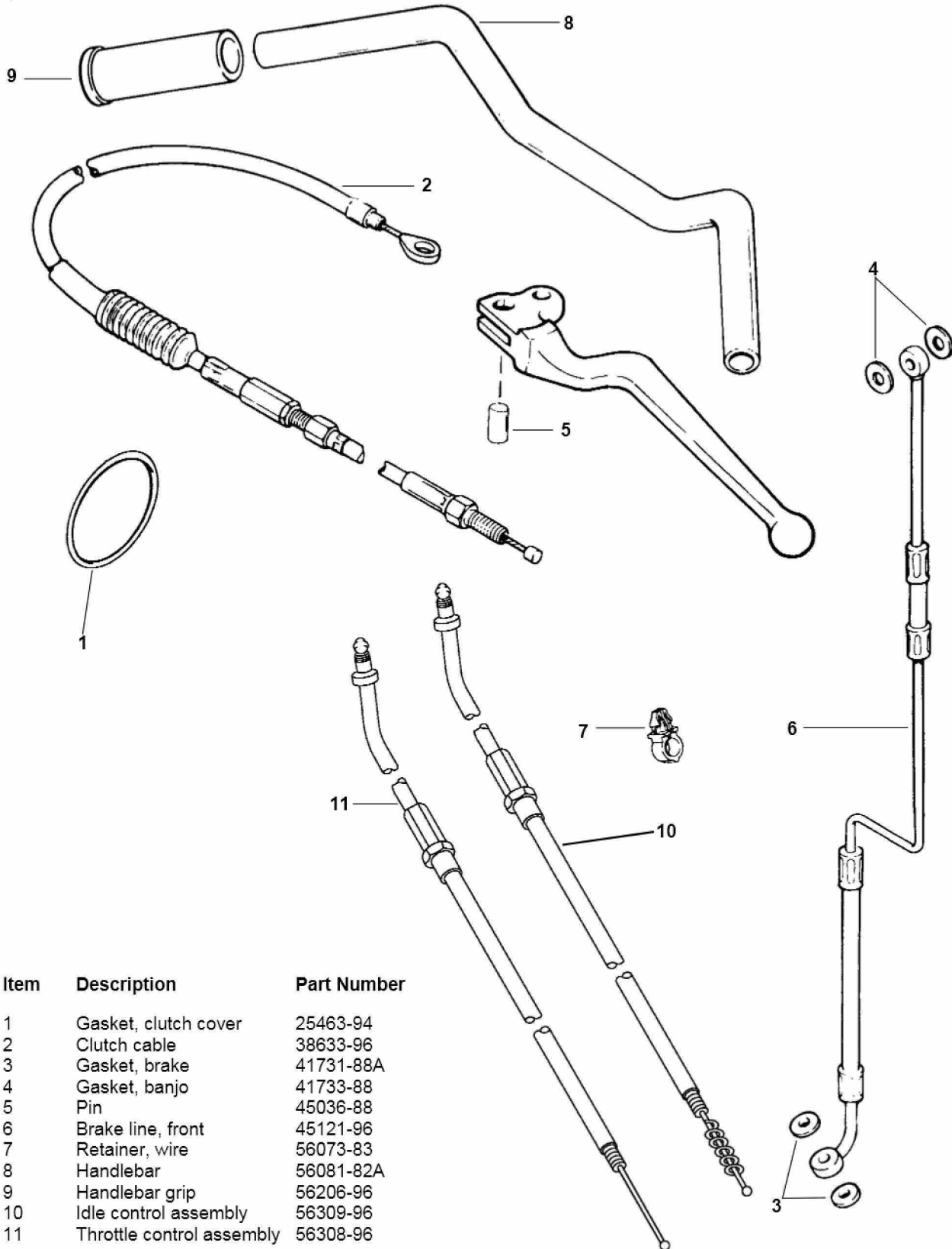

Item	Description	Part Number
1	Gasket, clutch cover	25463-94
2	Clutch cable	38633-96
3	Gasket, brake	41731-88A
4	Gasket, banjo	41733-88
5	Pin	45036-88
6	Brake line, front	45121-96
7	Retainer, wire	56073-83
8	Handlebar	56081-82A
9	Handlebar grip	56206-96
10	Idle control assembly	56309-96
11	Throttle control assembly	56308-96