



# INSTRUCTIONS

-J00278

REV. 7-1-95

Kit Number 54592-94

## XLH (Sportster) "Profile"™ Low FRONT SUSPENSION KIT

### General

This instruction sheet applies to XLH, Sportster, "Profile"™ Low Front Suspension kit 54592-94.

This kit is designed for installation on 1991 and later XLH Sportster models **except** Hugger and 1996 and later Custom Sportster models.

QTY	DESCRIPTION	PART NO.
2	Spring	54593-94
1	Low jiffy stand assembly	50129-95

#### NOTE

The springs and jiffy stand assembly, listed above, are available separately as Service Parts.

#### ⚠WARNING

Installation of any accessory suspension components may affect cornering clearance and jiffy stand operation. This could distract the rider, causing loss of control and personal injury.

#### ⚠WARNING

The jiffy stand included in this suspension kit is designed solely for use with this Harley-Davidson Profile Suspension kit and must be installed. Use of this jiffy stand is not designed or intended for use in other applications. Improper application may affect jiffy stand operation. This could distract the rider, causing loss of control and personal injury.

#### ⚠WARNING

Rider safety depends on the correct installation of this kit. Follow the procedures listed in this Instruction Sheet and in the appropriate Service Manual. If the procedures are not within your capabilities, or if you do not have the correct tools, have your Harley-Davidson dealer perform the installation.

#### ⚠WARNING

This fork spring kit cannot be used independently. It must be used with rear shock lowering kit, Part No. 54571-94 or handling and cornering may be affected. This could distract the rider, causing loss of control or personal injury.

### Fork Spring - Removal / Installation

1. See Figure 1. Elevate and support vehicle so front wheel clears floor.

#### NOTE

Take care not to damage O-ring (2).

2. Remove tube cap (1) from top of each fork tube (4). Use caution. Tube caps are under pressure from fork springs.

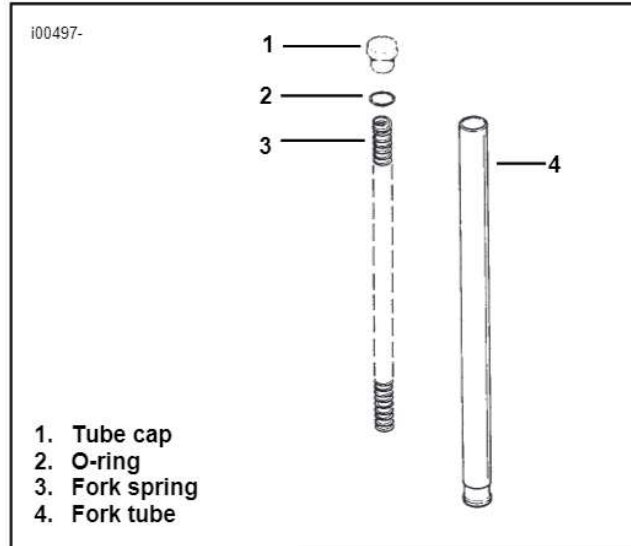

Figure 1. Fork Spring Assembly

3. Remove fork drain plugs. Drain fork oil. Replace drain plugs.
4. Remove and discard stock fork springs.

#### NOTE

When installing new fork springs, install the tight wound portion of the fork spring to the bottom of the fork slider.

5. Install new fork springs (3).

#### NOTE

"Profile"™ Low Forks require more H-D type E fork oil than the quantity listed in the Service Manual.

6. After fork spring installation, pour 12.1 oz. (358 ml) of H-D type E Fork Oil into each fork side.
7. Re-install tube cap (1). Be careful not to damage O-ring (2).

### Jiffy Stand Removal / Installation

To remove stock jiffy stand:

1. Block motorcycle under frame so that motorcycle is securely upright and jiffy stand moves through its full range of travel.

#### ⚠WARNING

Wear gloves and protective eyewear when performing the following procedures. The jiffy stand spring tension could cause the spring, components attached to the spring, and/or hand tools to fly outward at great speed during this removal/installation procedure and cause personal injury.

2. See Figure 2. Remove rubber bumper from frame to permit further retraction of jiffy stand leg. Additional spring tension relief allows for easier spring removal.
3. Place jiffy stand leg in retracted position. Remove and discard cotter pin. Remove washer.
4. See Figure 3. While firmly holding jiffy stand leg in fully retracted position, withdraw clevis pin until it disengages from the upper pivot hole of jiffy stand yoke.
5. Detach spring from anchor pin using pliers. Unhook other end of spring from jiffy stand leg.
6. Remove clevis pin from lower pivot hole of jiffy stand yoke. Remove jiffy stand leg.

**To install new Jiffy Stand:**

1. Apply a small amount of wheel bearing grease to pivot holes of jiffy stand leg and yoke, groove of anchor pin, and O.D. of clevis pin.
2. See Figure 3. Hook either end of spring into spring mounting hole on jiffy stand leg. Install loose end of spring over anchor pin.
3. While holding end of spring in groove of anchor pin and holding jiffy stand leg in its retracted position, position pivot end of jiffy stand leg within yoke on motorcycle frame. Insert clevis pin through lower pivot hole of yoke and halfway into pivot hole of jiffy stand leg.
4. See Figure 2. Lift jiffy stand leg upward, aligning pivot hole of jiffy stand leg with slotted upper hole of yoke. Fully insert clevis pin through holes in jiffy stand leg and yoke.
5. Install washer over end of clevis pin and against upper surface of yoke. Insert new cotter pin through hole in end of clevis pin. Bend ends of cotter pin apart to secure.
6. Press rubber bumper onto mounting stud on motorcycle frame.
7. Extend and retract jiffy stand leg several times to check for proper operation. In up position, jiffy stand leg should be securely seated against rubber bumper.
8. Place jiffy stand in down position. Carefully remove motorcycle frame support. Rest motorcycle on jiffy stand.

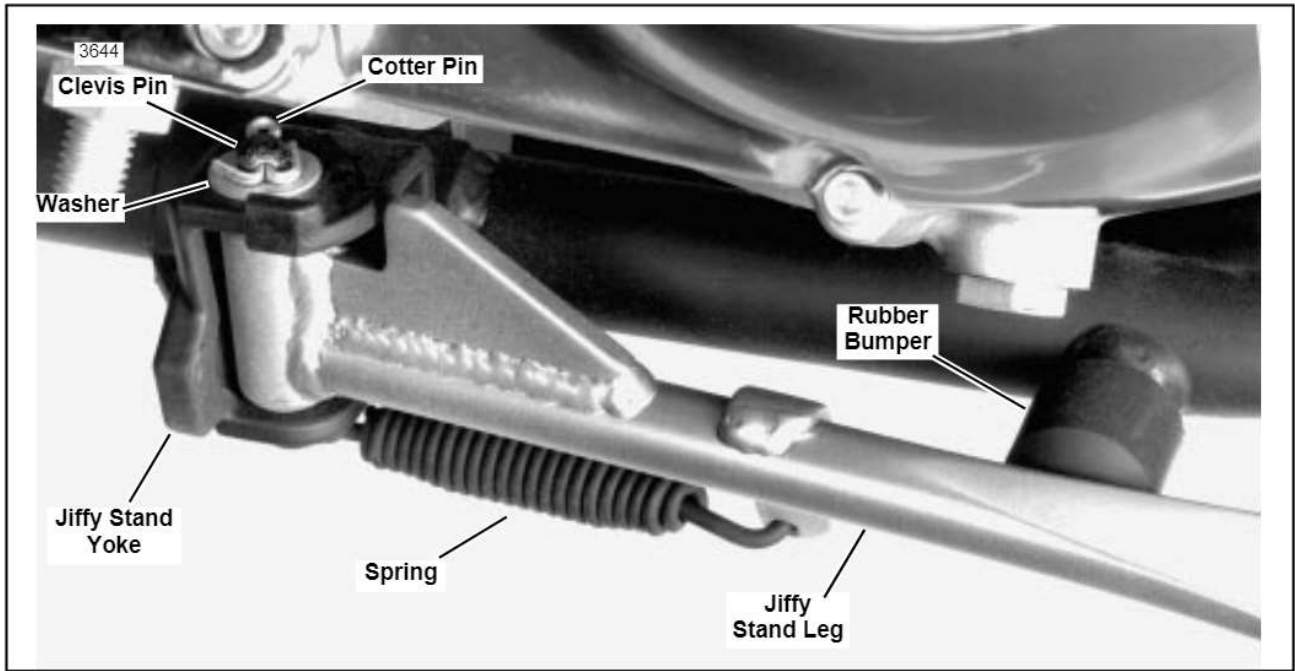

Figure 2. Jiffy Stand Assembly (Left Side View)

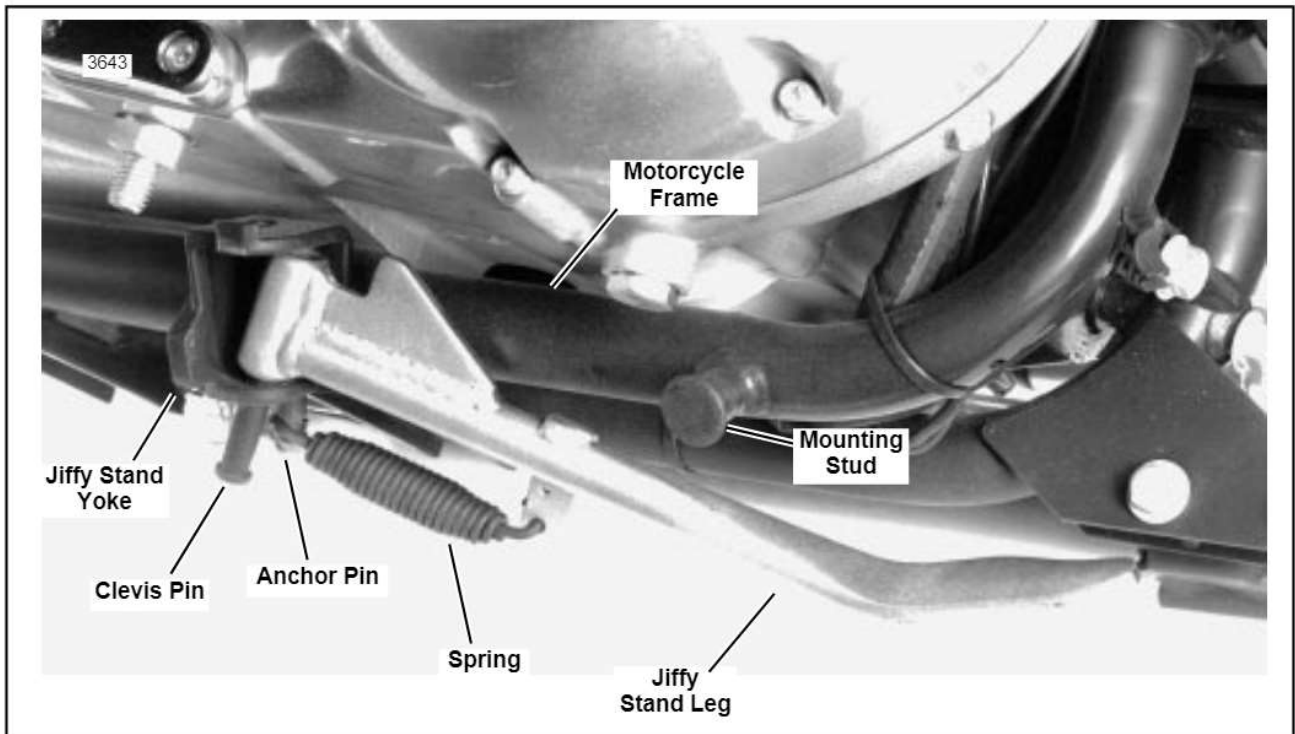

Figure 3. Jiffy Stand (Partially Installed)