



INSTRUCTIONS

-J00237

REV. 1-1-96

Kit Number 52664-96

XL PASSENGER PAD

General

This kit provides for installation of a passenger pad on all 1982 and later XL model vehicles using 52663-96 solo saddle. The Passenger Pad Kit contains the following items:

QTY.	DESCRIPTION
1	Passenger Strap
1	Plain Washer
1	TORX Button Head Screw
1	Hex Head Capscrew
2	Plain Washer
2	Lock Washer
2	Hex Head Capscrew
1	Passenger Pad

Removal

1. Remove screw, external tooth lockwasher and nylon washer to detach seat mounting bracket from rear fender.
2. Slide seat rearward to remove from frame.
3. Remove two bolts with lockwashers to free mounting bracket from bottom of stock seat.
4. If original stock seat is dual type, remove bolt and flat washer to detach passenger strap from rear fender.

Installation

1. Inspect new passenger strap. Note that one end of strap has 3 holes, while the other end has 2 holes. Loop passenger strap so that middle hole on 3-hole side and outside hole on 2-hole side are aligned with forward hole in rear fender.

2. Align hole in flat washer with those in fender and passenger strap. Install bolt and tighten to 8-13 ft-lbs (11-18 Nm). Be sure to use the fine threaded hex head capscrew on 1995 and earlier models. Use the coarse threaded TORX button head screw on 1996 and later models.
3. Using two hex head capscrews with lockwashers and flat washers (supplied in kit), fasten passenger pad to bottom of solo saddle. Tighten capscrews securely.
4. To install seat assembly, push on rear corners of passenger pad to compress foam and slide rear of pad through installed passenger strap.
5. To properly position saddle on frame, slide seat forward until tongue welded to center frame support fits snugly in groove at bottom of saddle.

⚠WARNING

Pull up on front of seat to verify that it is locked in place. If seat is loose, it could shift position during vehicle operation causing loss of control and personal injury.

6. Using original hardware, install screw, external tooth lockwasher and nylon washer to fasten seat mounting bracket to rearward hole in top of rear fender.

NOTE

Install the nylon washer between fender and seat mounting bracket to prevent damage to fender paint.

7. Pull up on seat again to verify that it is properly secured, front and rear.



Service Parts

Part No. 52664-96

Date 1/96

XL Passenger Pad Kit

sp52664

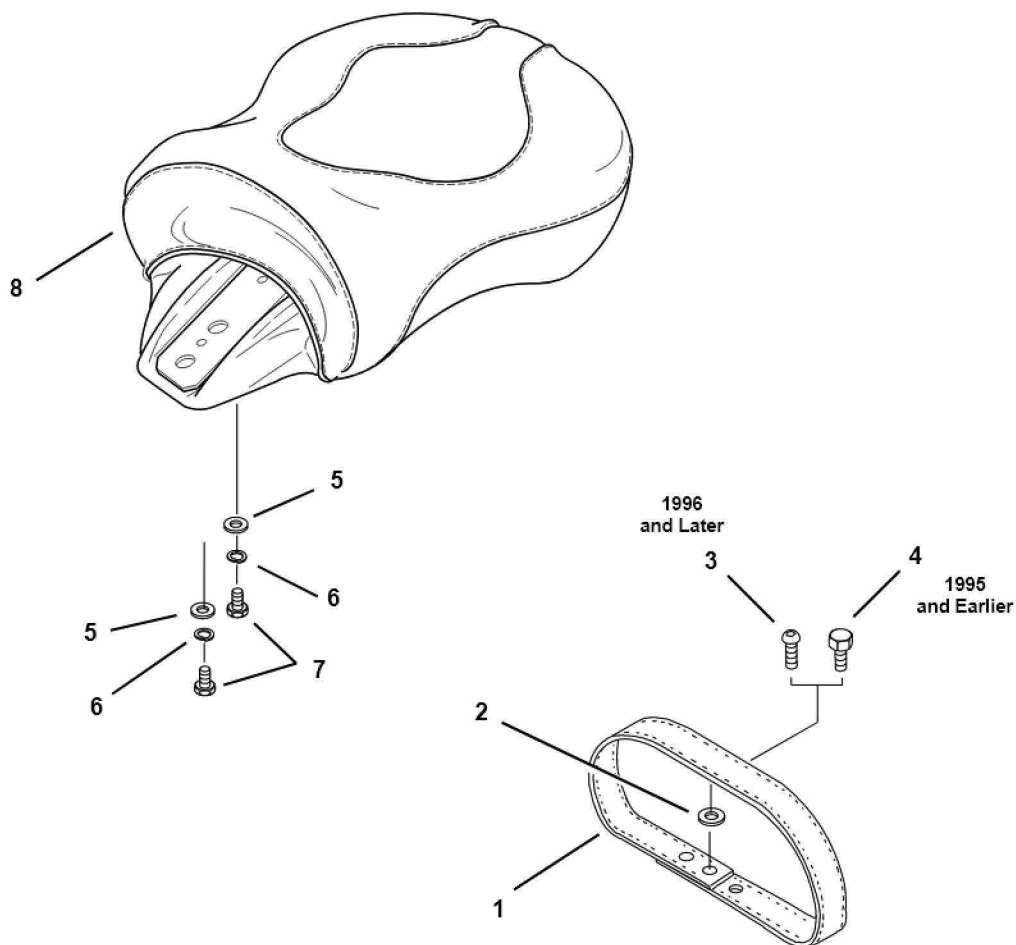

Item	Description	Part No.
1	Passenger Strap	51187-94A
2	Plain Washer	6036
3	TORX Button Head Screw	941
4	Hex Head Capscrew	3765
5	Plain Washer	6235
6	Lockwasher	7036
7	Hex Head Capscrew	2551W
8	Passenger Pad	52665-96