



INSTRUCTIONS

-J00236

REV. 1-1-96

Kit Number 52663-96

XL SOLO SADDLE

General

This kit provides for replacement of the original stock seat on all 1982 and later XL model vehicles.

NOTE

No service parts are provided. Installation requires use of original stock seat hardware.

Removal

1. See Figure 1. Remove screw, external tooth lockwasher and nylon washer to detach seat mounting bracket from rear fender.
2. Slide seat rearward to remove from frame.
3. Remove two capscrews with lockwashers to free mounting bracket from bottom of stock seat.
4. If original stock seat is dual type, remove bolt and flat washer to detach passenger strap from rear fender.

2. Position solo saddle on frame with mounting bracket at rear.
3. Slide seat forward until tongue welded to center frame support fits snugly in groove at bottom of solo saddle.

WARNING

Pull up on front of seat to verify that it is locked in place. If seat is loose, it could shift position during vehicle operation causing loss of control and personal injury.

4. Install screw, external tooth lockwasher and nylon washer to fasten seat mounting bracket to forward hole in top of rear fender.

NOTE

Install the nylon washer between fender and seat mounting bracket to prevent damage to fender paint.

5. Pull up on seat again to verify that it is properly secured, front and rear.

Installation

1. Install two capscrews with lockwashers to fasten mounting bracket to bottom of new solo saddle. Tighten capscrews securely.

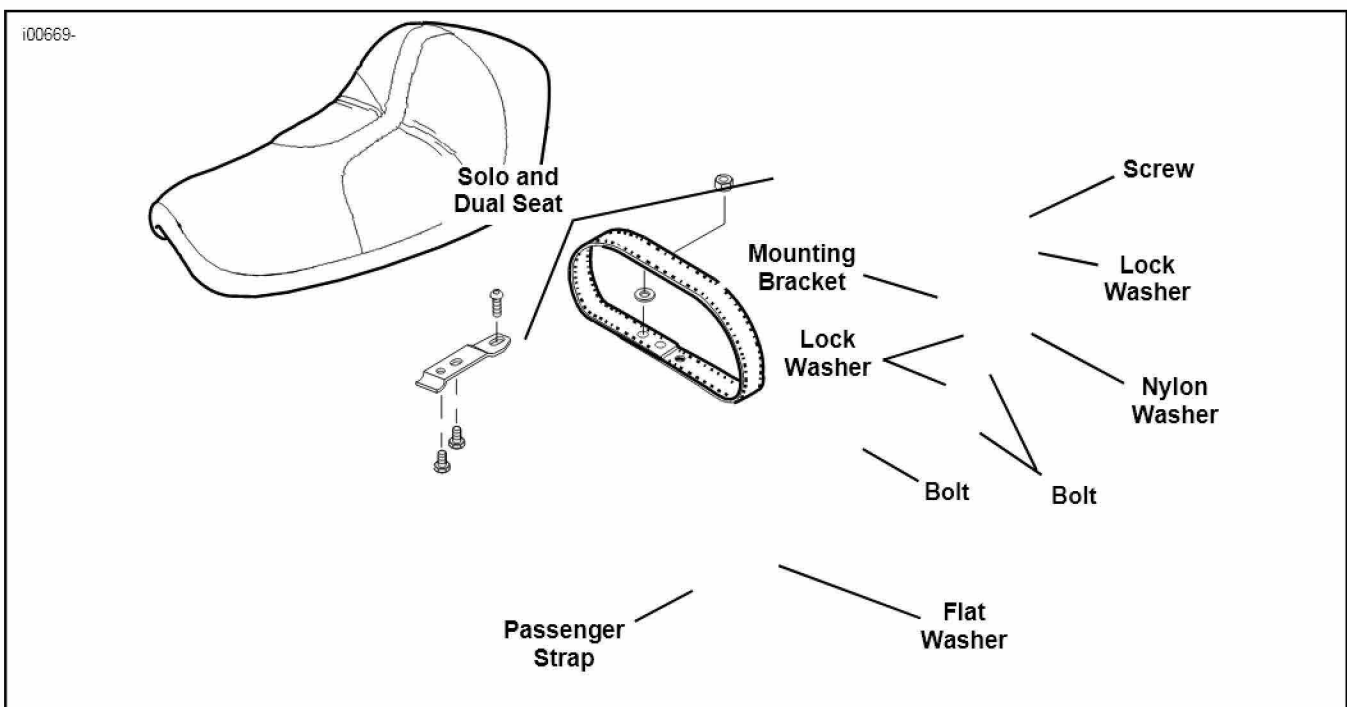

Figure 1. Original Stock Seat and Hardware