



# INSTRUCTIONS

-J00223

2013-11-01

## BADLANDER XL CUSTOM SEAT

### GENERAL

#### Kit Numbers

52296-94B, 52363-97, 52909-98

#### Models

For model fitment information, see the P&A retail catalog or the Parts and Accessories section of [www.harley-davidson.com](http://www.harley-davidson.com) (English only).

#### Kit Contents

See Figure 1 and Table 1.

### REMOVAL OF STOCK SEAT

1. Remove screw (8) to detach rear seat mounting bracket from fender.
2. Slide seat rearward to unhook front of seat from frame, then remove seat.
3. If equipped with a grab strap, remove hardware that holds it in place and remove strap.

### INSTALLATION OF SEAT KIT

For 1996 and earlier models:

#### NOTE

Make certain you select the correct kit screw in step 1. Attempting to install a coarse threaded screw in a fine threaded hole will damage threads.

1. Secure grab strap (2) to fender using washer (7) and appropriate screw (6) below:
  - a. On 1995 and earlier models use 1/4-28 (fine) screw.
  - b. On 1996 - 2003 models use 1/4-20 (coarse) screw.
2. Slide seat into position until front of seat engages frame, then secure bracket to fender with screw (8) using guide washer (3) between bracket and fender with the small washer diameter facing upwards. The guide washer will center the screw in the bracket hole and serve as a washer to protect the fender.

#### NOTE

For 1997 883 models, a retention nut and washer must be installed into the fender hole, covered with a plastic cap, where the rear seat bracket will be attached. A cable strap is included to aid in this installation.

For 1997 - 2003 models:

1. Install grab strap (see step 1 for 1996 and earlier models).
2. Remove plastic cap from hole in fender where the rear seat bracket will be attached.

3. Place retention nut (5) over cable strap (9) so wide end of nut rests on eye of cable strap. Thread cable strap up under fender and through fender hole. Pull up on cable strap to hold nut snug against underside of fender.
4. With rib on retention nut seated into notch in fender hole, slide retention washer (4) into place from the rear. This will lock the retention nut in place.
5. Slide seat into position until front seat tab engages frame, then secure rear seat bracket to fender with screw (8).

#### ▲ WARNING

After installing seat, pull upward on seat to be sure it is locked in position. While riding, a loose seat can shift causing loss of control, which could result in death or serious injury. (00070b)

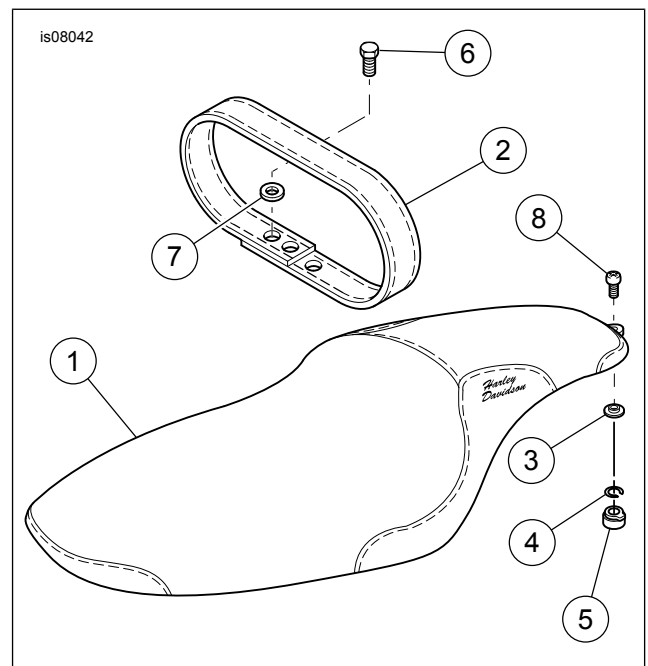

Figure 1. Service Parts

Table 1. Service Parts

Item	Description (Quantity)	Part Number
1	Seat	Not sold separately
2	Grab strap	51174-93
3	Guide washer	7487 (1996 and earlier)
4	Retention washer	7489A (1997-2003)
5	Retention nut	7488 (1997-2003)
6	Screw, 1/4-28 (fine)	3765
	Screw, 1/4-20 (coarse)	941
7	Washer	6036
8	Screw	(Stock, reuse)
9	Cable strap	(Not shown) 10039

-J00223



Many Harley-Davidson® Parts & Accessories are made of plastics and metals which can be recycled. Please dispose of materials responsibly.

1 / 1