



# INSTRUCTIONS

-J00133

2006-01-06

## HAND CONTROL LEVER KITS

### GENERAL

#### Kit Number

44994-00, 45075-96

#### Models

These kits fit 1996-2003 Sportster®, 1996 and later Dyna®, Softail® and Touring model motorcycles.

These kits **are not** compatible with a Hydraulic Clutch.

#### ▲ WARNING

**Rider and passenger safety depend upon the correct installation of this kit. Use the appropriate service manual procedures. If the procedure is not within your capabilities or you do not have the correct tools, have a Harley-Davidson dealer perform the installation. Improper installation of this kit could result in death or serious injury. (00333b)**

#### NOTE

*This instruction sheet references Service Manual information. A Service Manual for your model motorcycle is required for this installation and is available from a Harley-Davidson Dealer.*

#### Kit Contents

See Figure 1 and Table 1.

### BRAKE LEVER INSTALLATION

#### NOTE

*Do not remove the handlebar clamp or switch housing assembly to remove the brake lever.*

#### ▲ WARNING

**Wear safety glasses or goggles when removing or installing retaining rings. Retaining rings can slip from the pliers and could be propelled with enough force to cause serious eye injury. (00312a)**

1. See Figure 1 and the FRONT BRAKE MASTER CYLINDER section of the Service Manual. Remove the retaining ring (B) from the groove in the pivot pin (C). Save the retaining ring for re-use.
2. Remove the pivot pin and retain for re-use. Remove and discard the original equipment brake lever and pivot lever bushing.

#### NOTE

*Follow the instructions in Steps 4 and 5 carefully in order to prevent the actuating tab on the brake lever from damaging the rubber boot and plunger of the front stoplight switch.*

3. Insert the pivot lever bushing (2) from the kit into the new brake lever (1).
4. Gently press and hold the piston cap (A) forward with a screwdriver. Slip the brake lever into position and align the pivot pin holes.
5. Install the pivot pin and retaining ring removed in Steps 1 and 2.
6. Check the front brake for proper operation. There should be no free play in the hand lever. A slight preload is permissible.

#### ▲ WARNING

**A plugged or covered relief port can cause brake drag or lock-up, which could lead to loss of control, resulting in death or serious injury. (00288a)**

7. To verify proper operation of the master-cylinder relief port, actuate the brake lever with the reservoir cover and gasket removed. A slight spurt of fluid will break the surface if internal components are working properly.
8. Reinstall the master cylinder cover.

#### ▲ WARNING

**Be sure that all lights and switches operate properly before operating motorcycle. Low visibility of rider can result in death or serious injury. (00316a)**

9. Check that the stop light goes on when the brake lever is actuated.

### CLUTCH LEVER INSTALLATION

See the CLUTCH CONTROL section of the appropriate Service Manual for all clutch lever removal, installation and adjustment procedures.



# SERVICE PARTS

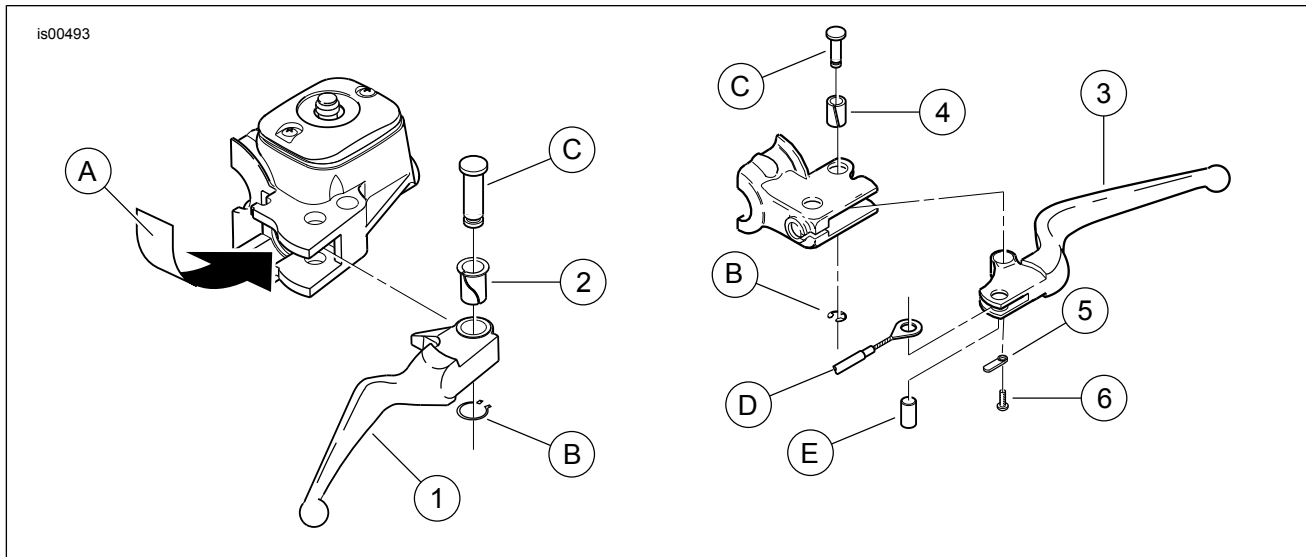

Figure 1. Service Parts: Hand Control Lever Kits

Table 1. Service Parts Table: Hand Control Lever Kits

Kit 44994-00 (Black)			Kit 45075-96 (Chrome)		
Item	Description (Quantity)	Part Number	Item	Description (Quantity)	Part Number
1	Lever assembly, front brake control (includes bushing)	44995-00	1	Lever assembly, front brake control (includes bushing)	45076-96
2	Bushing, brake lever pivot pin	45423-96	2	Bushing, brake lever pivot pin	45423-96
3	Lever assembly, clutch control (includes bushing, clip and screw)	44996-00	3	Lever assembly, clutch control (includes bushing, clip and screw)	45077-96
4	Bushing, clutch lever pivot pin	45423-92	4	Bushing, clutch lever pivot pin	45423-92
5	Clip, anti-rattle	45021-86	5	Clip, anti-rattle	45021-86
6	Screw	90770-79	6	Screw	90770-79
Items mentioned in text, but not included in kit:			Items mentioned in text, but not included in kit:		
A	Press piston cap forward		A	Press piston cap forward	
B	Stock retaining ring		B	Stock retaining ring	
C	Stock pivot pin		C	Stock pivot pin	
D	Clutch control cable (ref.)		D	Clutch control cable (ref.)	
E	Clutch cable anchor pin (ref.)		E	Clutch cable anchor pin (ref.)	