



# INSTRUCTIONS

-J00085

2013-11-01

## CLUTCH CABLE KIT

### GENERAL

#### Kit Numbers

38619-86A, 38621-86A

#### Models

For model fitment information, see the P&A retail catalog or the Parts and Accessories section of [www.harley-davidson.com](http://www.harley-davidson.com) (English only).

#### Kit Contents

See Figure 1 and Table 1.

#### ⚠ WARNING

Rider and passenger safety depend upon the correct installation of this kit. Use the appropriate service manual procedures. If the procedure is not within your capabilities or you do not have the correct tools, have a Harley-Davidson dealer perform the installation. Improper installation of this kit could result in death or serious injury. (00333b)

#### NOTE

This instruction sheet references service manual information. A service manual for your model motorcycle is required for this installation and is available from a Harley-Davidson Dealer.

### INSTALLATION

1. Remove clutch handlebar from handlebar bracket at pivot pin. Remove original clutch cable from handlebar and clutch. Retain anchor pin bushings.
2. Remove original clutch cable from primary cover. On 1986 and 1987 models, retain nut. Discard copper washer. On 1988 and later models, retain O-ring.
3. See the service manual to install clutch end of new cable to primary cover. Use copper washer only for 1986 and 1987 models. On 1988 and later models, use original O-ring.
4. See Figure 1. Install lever end of new clutch cable. Position cable eyelet in clutch lever slot. Retain with new clutch cable pin through original bushings.
5. Secure clutch lever in lever bracket with lever pivot pin and retaining ring.
6. See the service manual to adjust the clutch cable.

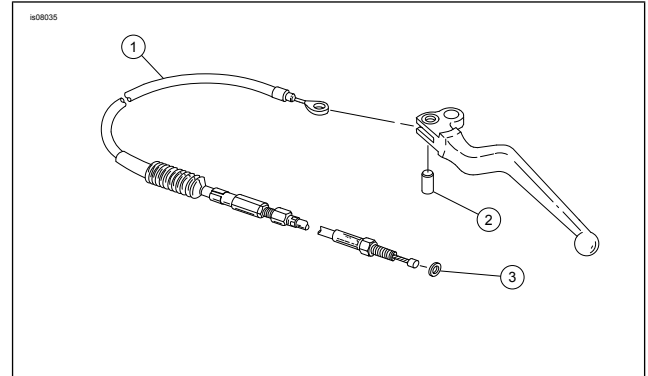

Figure 1. Service Parts

Table 1. Service Parts

Item	Description (Quantity)	Part Number
1	Clutch cable (incl. boot)	Not sold separately
2	Pin, clutch cable	45036-88
3	Washer, copper	25437-86

