

2001 M2/S3 SHIFT LINKAGE KIT

Purpose

The purpose of this bulletin is to announce the release of the **new** M2/S3 Shift Linkage Kit and to provide installation instructions.

The M2/S3 Shift Linkage Kit offers greater adjustment and reduced shift lever effort than the stock shifter assembly and has been developed in the interest of customer satisfaction. The shift linkage rod in this kit is slightly longer than stock.

Motorcycles Affected

The M2/S3 Shift Linkage Kit is intended for use on all early production 2001 Cyclone M2/M2L and Thunderbolt S3/S3T model motorcycles manufactured through March, 2001.

Affected model motorcycles shipped from the factory after March, 2001 will have the **new** shift linkage installed at the factory.

Customer Notification

Customers will not be notified of the release of this kit. It is the dealer's responsibility to make the customers of affected models aware that the kit exists.

Required Dealer Action

Order and install shift linkage kits as required. See CREDIT PROCEDURES for reimbursement instructions. See DISPOSITION OF PARTS for instructions on what to do with original shifter assemblies.

Kits will be available on or before May 15, 2001 and must be ordered as required.

The M2/S3 Shift Linkage Kit (Part No. N0618.01A1) consists of:

- Shift Linkage Rod
- Engine Lever
- (2) Bolts, #10x24x5/8 in.
- Pinch Screw, #10x24x1 in.

Removal

1. See [Figure 1](#). Remove upper and lower shift linkage rod bolts (1). Remove shift linkage rod (2) from shift lever (3) and engine lever (4).
2. Remove pinch screw (5) and engine lever (4) from splined shaft (6). Discard engine lever (4), shift linkage rod (2) and hardware (1 and 5).

Installation

1. See "A" in [Figure 3](#). Position **new** engine lever on splined shaft oriented as shown in figure (pointing just below front clutch inspection cover bolt). Lower figures "B" and "C" are examples of incorrect clamp orientation.
2. See [Figure 1](#). Apply LOCTITE THREADLOCKER 243 (Blue) to pinch screw and install in engine lever.
3. See [Figure 1](#). Tighten engine lever pinch screw to 59-66 **in-lbs** (7-8 Nm).

NOTE

Shift linkage rod length is calculated by measuring from the center of the lower shift linkage rod eye to the center of the upper shift linkage rod eye.

4. See [Figure 2](#). Shift linkage rods are preset to the factory length of 4.75 in. (121 mm). Adjust shift linkage rod length as required to suit rider preference. Maximum allowable shift linkage rod length is 4.88 in. (124 mm).
 - a. Loosen jamnut (1) and rotate top eye clockwise to shorten or counterclockwise to lengthen.
 - b. Tighten jamnut when complete.
5. Apply LOCTITE THREADLOCKER 243 (Blue) to upper and lower shift linkage rod bolts and install shift linkage rod with two bolts.
6. Tighten shift linkage rod bolts to 59-66 **in-lbs** (7-8 Nm).
7. Check for proper shift linkage/clutch operation.

ROUTING	SERVICE MANAGER	SALES MANAGER	PARTS MANAGER	LEAD TECHNICIAN	TECHNICIAN NO. 1	TECHNICIAN NO. 2	TECHNICIAN NO. 3	TECHNICIAN NO. 4	RETURN THIS TO:
INITIAL HERE									

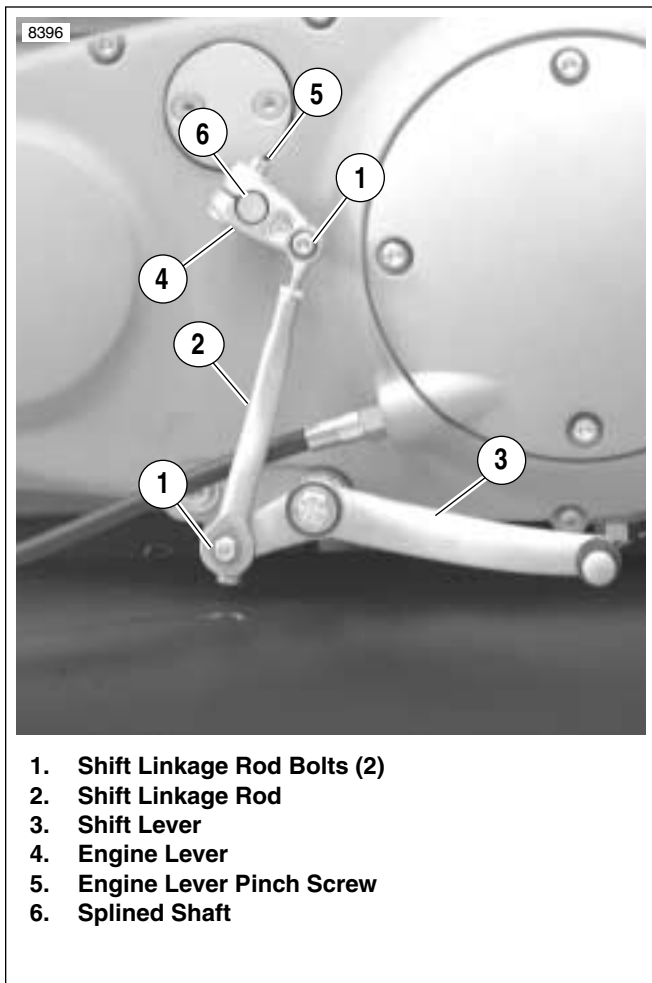

Figure 1. Shift Linkage

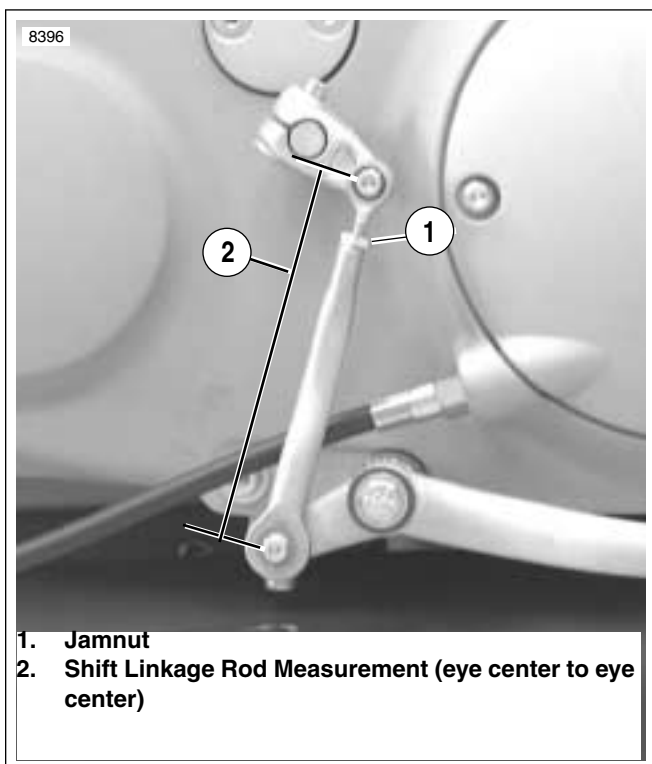
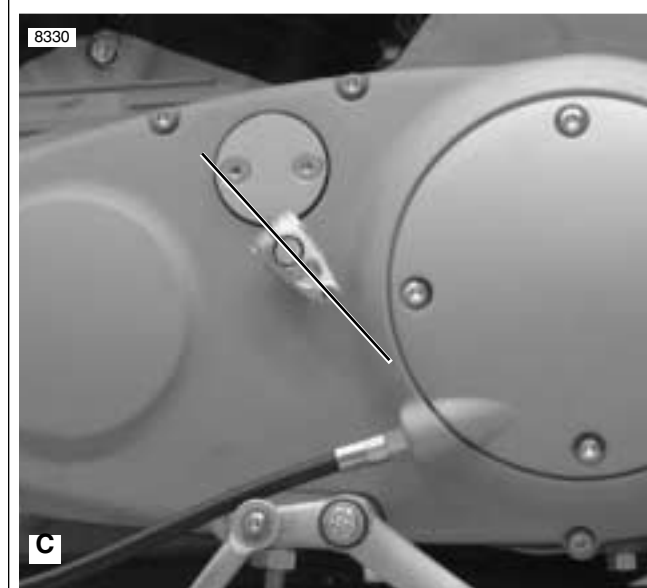
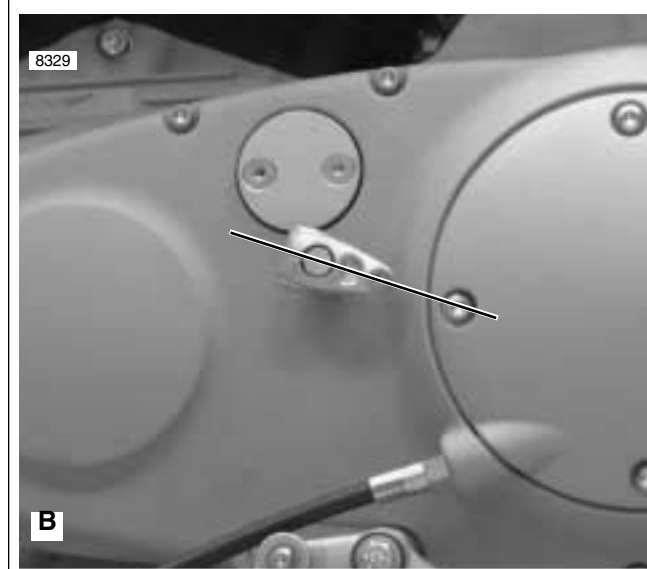

Figure 2. Shift Linkage Rod Length



- a. Correct Installation
 b. Incorrect Installation - too high
 c. Incorrect Installation - too low
 NOTE: Shift linkage rod disconnected for clarity

Figure 3. Correct and Incorrect Clamp Orientation

Credit Procedure

After servicing each vehicle, file a warranty claim referencing Service Bulletin B-039 in the "Description of Repair" or "Comments" section of the claim. Fill in the rest of the claim as follows:

Claim Type	BMC, BGW*	
Event 1	Qty 0	Problem Part No. N0617.01A1
Event 1, Additional (Replacement)	Qty 1	Problem Part No. N0618.01A1)
Part Description	M2/S3 Shift Linkage Kit	
Primary Labor Code	4333	
Time: (includes 0.1 hr administrative time and LOCTITE)	0.2 (M2/M2L Models) 0.2 (S3/S3T Models)	
Customer Concern Code	9203	
Condition Code	3101	

*Use BMC if vehicle is still within factory warranty period; use BGW if vehicle is beyond factory warranty period. Vehicles beyond factory warranty period do not require prior authorization. If using hdnet.com, put 'Per Bulletin B-039' in the authorization box.

NOTE

If additional parts such as cable straps are required, list them under Event 1, Additional Parts.

After processing of the claim form, you will be credited for the labor and parts.

Disposition Of Parts

Discard removed shift linkage rods, engine levers and hardware. There is no impact to dealer inventory of these parts as the 2001 X1 model can still use the original shift linkage rod assembly.