

SAFETY RECALL CODE 0822 - BLAST REAR SPROCKET

GENERAL

Buell Motorcycle Company has learned that certain 2000 Model Year Buell motorcycles were built with a rear sprocket that could break. This condition could cause the rider to lose power, lose control, or be struck by debris. Any of these occurrences could cause serious injury or death. Accordingly, Buell Motorcycle Company is voluntarily conducting a recall campaign to formally recall all potentially affected motorcycles.

This campaign involves all 2000 P3 Blast model Buell motorcycles manufactured between March 3, 1999 and July 6, 2000.

This condition will be remedied by replacing the rear sprocket, sprocket cover, drive belt and installing the recalibrator on all potentially affected vehicles.

DEALER ACTION, AFFECTED VEHICLES

Buell Distribution Corporation has attached a complete list of all vehicles shipped to your dealership involved in this recall. To ensure the safety of all affected riders, it is your responsibility to perform the required service on all affected vehicles, even if the motorcycle was not purchased from your dealership.

If you are not sure that a safety recall has been completed on a particular Buell motorcycle, contact the recall information line at 1-800-448-1708. Recall information is also available on TALON and hd-net.com.

IMPORTANT NOTE

Because only registered owners, as shown on the attached list, will receive notification from Buell Distribution Corporation, we request that you contact any owners of vehicles still listed as unregistered. Advise them of the safety recall and make arrangements for them to come in for recall service. We also require that you provide us with their names, addresses and V.I.N.s as soon as possible. This will enable us to mail them an owner's letter as required by National Traffic and Motor Vehicle Safety Act, as amended.

Initial shipment of recall kits will begin on or before October 27, 2000. All kits will be shipped direct from the Franklin Distribution Center, no charge, transportation paid. To order the remainder of kits that may be needed, please fill out the attached order form and send/fax it to the Warranty Department at (FAX) 414-343-8346.

Buell Distribution Corporation reserves the right to conduct wave shipments in lieu of processing orders and/or adjusting order quantities, depending on the availability of parts.

The Blast Rear Sprocket Recall Kit (Part No. 94019Y) consists of:

- 80 Tooth Rear Sprocket
- 139 Tooth Drive Belt
- Sprocket Cover
- (5) Hardened Washers
- (5) Bolts
- Speedometer Recalibrator
- (2) Cable Ties

REPLACEMENT

NOTE

Perform the following procedures according to the guidelines given in the service manual for the model being serviced.

Drive Belt and Rear Sprocket

1. Secure motorcycle on suitable lift that secures the front wheel.
2. Remove seat. See appropriate service manual, Section 2 for procedure.

WARNING

To protect against shock and accidental start-up of vehicle, disconnect the negative battery cable before proceeding. Inadequate safety precautions could result in death or serious injury.

3. Disconnect the negative battery cable from the battery.
4. Raise rear wheel off floor using REAR WHEEL SUPPORT STAND (Part No. B-41174).
5. See Figure 1. Place rod or screwdriver through axle hole. Loosen rear axle nut (metric).
6. Remove nut, lockwasher, and flat washer.
7. Pull axle out. Remove right side spacer.
8. Slide carrier with caliper off rotor.
9. Remove left side spacer.
10. Move wheel forward, disengage drive belt and remove rear wheel from motorcycle. Place wheel on clean work surface, sprocket side up.
11. See Figure 2. Remove five sprocket bolts, sprocket cover and hardened washers from rear wheel. Destroy and discard removed parts.

ROUTING	SERVICE MANAGER	SALES MANAGER	PARTS MANAGER	LEAD TECHNICIAN	TECHNICIAN NO. 1	TECHNICIAN NO. 2	TECHNICIAN NO. 3	TECHNICIAN NO. 4	RETURN THIS TO:
INITIAL HERE									

12. Remove sprocket from rear wheel. Destroy and discard sprocket.

⚠ WARNING

Always wear proper eye protection and gloves when working with compressed air. Compressed air may eject debris with enough force to cause injury. Inadequate safety precautions may result in death or serious injury.

13. Clean residual loctite from threads in wheel sprocket towers with a suitable non-flammable solvent. Dry with compressed air.
14. Remove three TORX bolts, washers and front sprocket cover from right side of motorcycle. NOTE: It may be necessary to compress suspension to gain access to front sprocket cover TORX bolt.
15. Remove two TORX screws and washers from right side of rear inner fender.
16. Carefully bend rear inner fender upwards and remove drive belt.
17. Discard drive belt.
18. Position new 139-tooth drive belt over transmission drive sprocket.
19. Install rear inner fender with two TORX screws and washers.
20. Apply LOCTITE THREADLOCKER 243 (Blue) to first few threads of front sprocket cover TORX screws.
21. Install front sprocket cover with three TORX screws and washers. Tighten screws to 30-36 in-lbs (3-4 Nm).

⚠ WARNING

Use only new P/N BA0511.2Z hardened washers between sprocket cover and sprocket. Failure to use hardened washers could cause sprocket to fail. Drive sprocket failure could lead to loss of control of vehicle which could result in death or serious injury.

22. Place sprocket on rear wheel while rear wheel assembly is lying flat on bench.
23. See Figure 3. Place **new** hardened washers on sprocket.
24. Install **new** sprocket cover over washers and sprocket.
25. Install five **new** sprocket bolts to sprocket, sprocket cover and rear wheel. Make sure washers are positively retained by mounting bolts. Tighten sprocket bolts to 28-31 ft-lbs (38-42 Nm).
26. Position wheel in mounting position. Slide axle through washer, swing arm, carrier, left side spacer and wheel assembly. Position drive belt inboard of sprocket.
- See Figure 2. Hold right side spacer in place.
 - Insert axle through right side spacer and swingarm.
 - Install flat washer, lockwasher and axle nut.
27. Place screwdriver or rod through axle hole and tighten rear axle nut to 48-52 ft-lbs (65.1-70.5 Nm).
28. Slide belt on sprocket teeth by rotating rear wheel to "walk" belt onto teeth.

29. Lower motorcycle rear wheel.

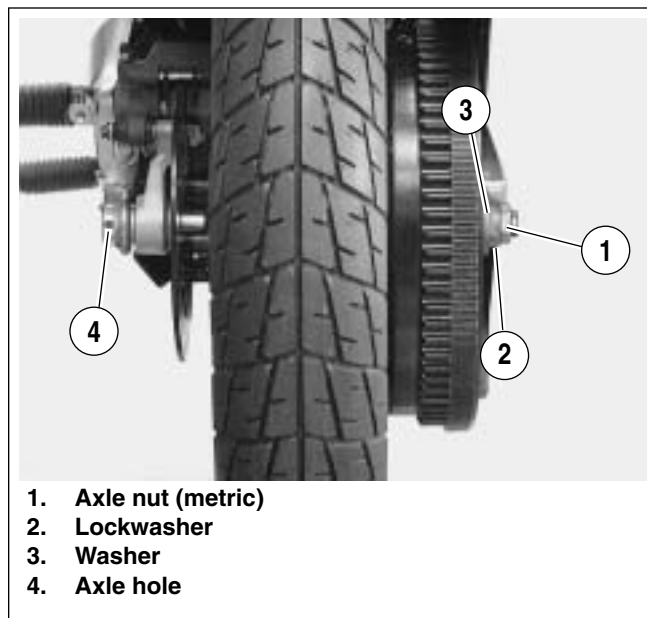

Figure 1. Rear Sprocket

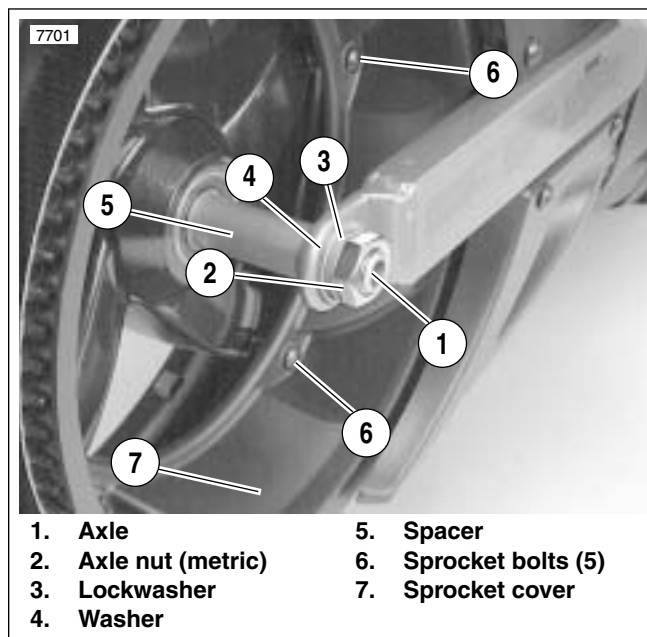

Figure 2. Rear Axle, Right Side

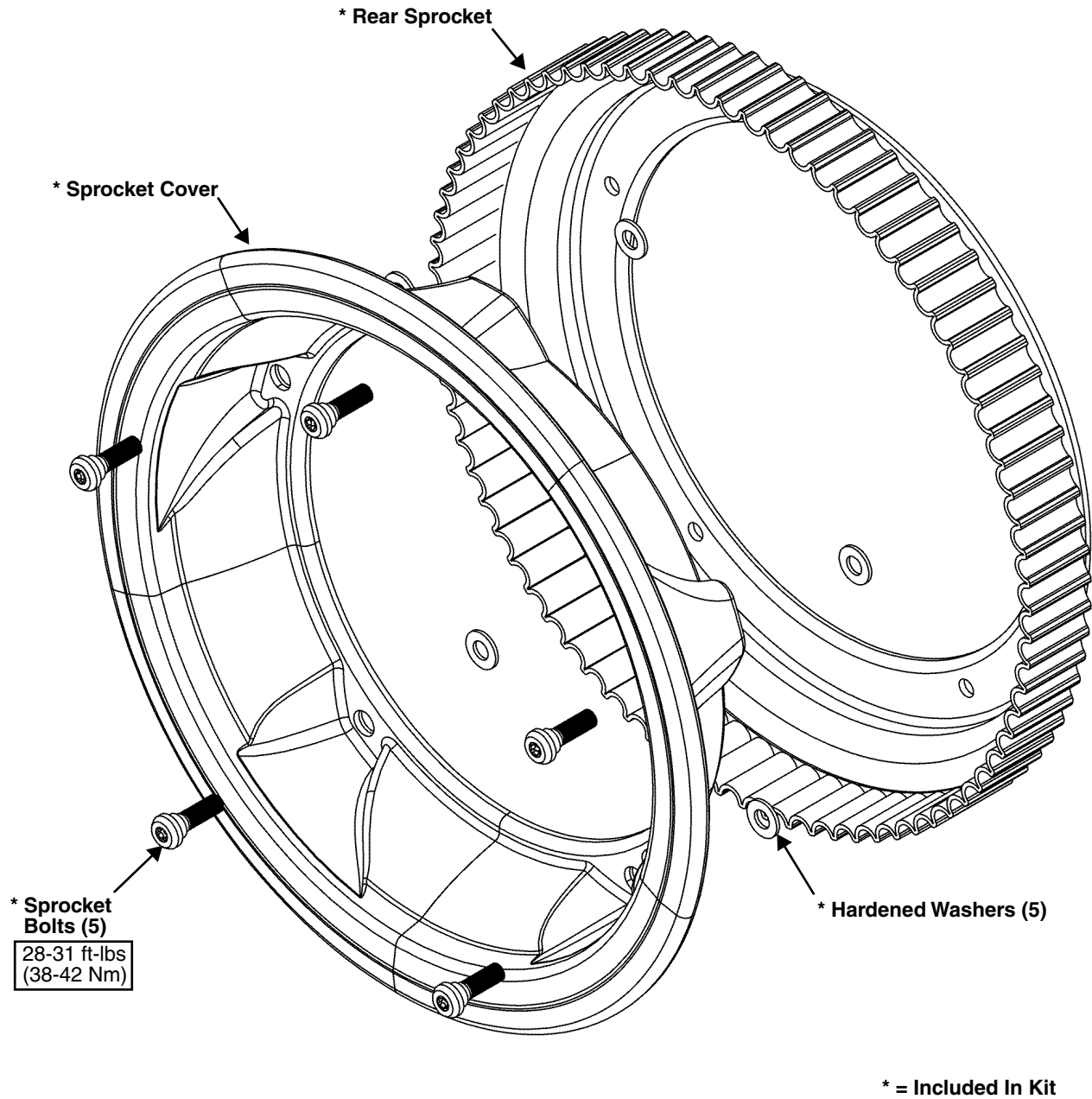

Figure 3. Rear Sprocket Assembly

Speedometer Recalibrator

WARNING

To protect against shock and accidental start-up of vehicle, disconnect the negative battery cable before proceeding. Inadequate safety precautions could result in death or serious injury.

WARNING

Always disconnect the negative battery cable first. If the positive battery should contact ground with the negative cable installed, the resulting sparks may cause a battery explosion which could result in death or serious injury.

1. Remove battery. See BATTERY, Section 7 of Service Manual.
2. Disconnect connector [65] located under seat on right side of motorcycle.
3. See Figure 4. Plug recalibrator into [65A] and [65B].
4. See Figure 5. Loop cable over backside of recalibrator making sure there is some slack in speed sensor wire harness on sensor end.
5. See Figure 6. Using cable tie provided in kit, secure speed sensor connector [65B]/recalibrator bundle to system relay wire harness in front of shock absorber.
6. Using a long nose pliers, cinch cable tie. Make sure no wires are pinched.
7. Using cable tie provided in kit, secure speed sensor/recalibrator connector [65A] to main wire harness on right hand side under seat. Make sure cable tie is located over braided loom and not directly on wires.

CAUTION

Make sure there is adequate free play in positive battery cable and speed sensor wire harness. Failure to comply may result in cable failure.

8. Verify there is adequate free play in both positive battery cable and speed sensor wire harness.
9. Tuck connector [65A] under frame on right side.

WARNING

Always connect the positive battery cable first. If the positive battery should contact ground with the negative cable installed, the resulting sparks may cause a battery explosion which could result in death or serious injury.

10. Install battery and connect battery cables, positive cable first. See BATTERY, Section 7 of Service Manual.

WARNING

After installing seat, pull upward on front of seat to be sure it is locked in position. If seat is loose, it could shift during vehicle operation and startle the rider, causing loss of control of vehicle and death or serious injury.

11. Install seat. See SEAT, Section 2 of Service Manual.
12. Test ride motorcycle to verify proper rear sprocket and speedometer operation.

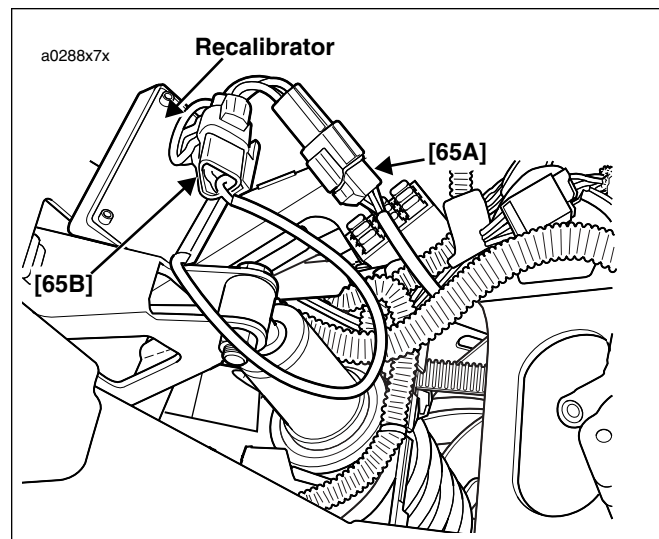

Figure 4. Connecting Recalibrator

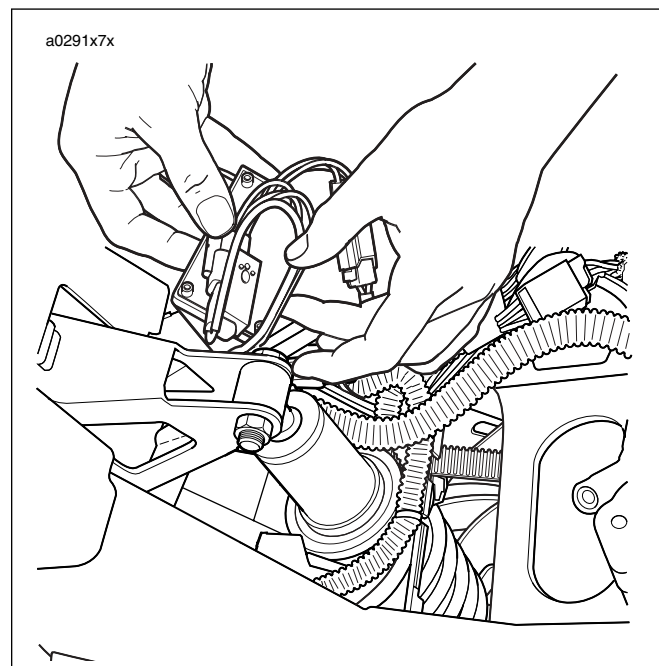

Figure 5. Looping Wire Harness

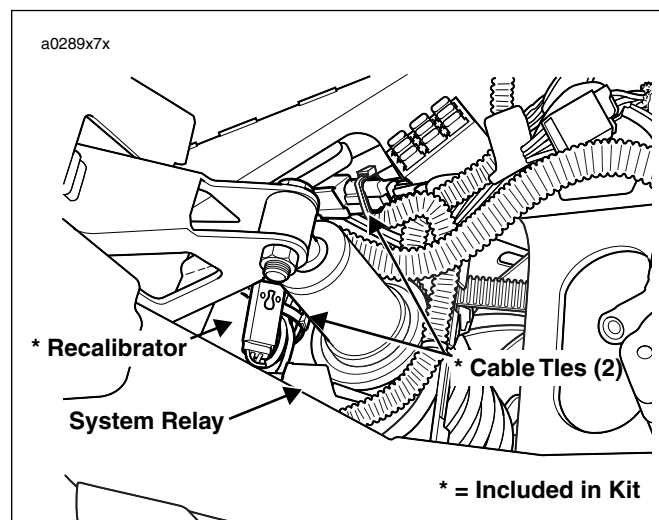

Figure 6. Securing Wire Harnesses

CREDIT PROCEDURES - VEHICLE REPAIR

For each vehicle serviced, place a "C" in the letter box on the Buell Dealer Service Card. Send the properly completed dealer service cards to Buell Distribution Corporation, 3700 W. Juneau Ave., Milwaukee, WI 53208. Upon receipt and processing of your properly completed dealer service cards, you will be credited for 1.9 hours for labor for Domestic vehicle repair and 2.0 hours labor for Canadian vehicle repair. Time includes appropriate administrative time and LOCTITE products. No credit will be issued for the kits as they were sent no charge, transportation paid.

CREDIT PROCEDURES - DEALER STOCK PARTS

Remove all affected sprockets, sprocket covers and drive belts (Part Nos. listed below) from your inventory. To receive credit, complete a regular warranty claim referencing Service Bulletin B-036 in the "Description of Repair" section. Fill in the rest of the claim as follows.

Table 1. Credit for Parts

Claim Type	BDS
Quantity	See Note Below
Event 1, Problem Part No.	G0400.T
Part Description	Rear Sprocket
Event 2, Problem Part No.	G0556.T
Part Description	Sprocket Cover
Event 4, Problem Part No.	G0500.T
Part Description	135-Tooth Drive Belt
Customer Concern Code	9205
Condition Code	9111

NOTE

"Quantity" may vary depending upon what you have in stock.

Upon receipt of properly completed claim for parts in dealer stock, you will receive the appropriate credit for parts. Buell Distribution Corporation advises ordering standard 2001 Model Year belts, rear sprockets and sprocket covers to replenish your stock. **Do not order the recall kits to restock your inventory!**



BUELL DISTRIBUTION CORPORATION
P.O. BOX 594, MILWAUKEE, WI U.S.A 53201
PARTS & ACCESSORY ORDER

B-036

S
O L D T O

NAME _____

ADDRESS _____

CITY/STATE/ZIP _____

S
H
I
P

T
O

NAME _____
ADDRESS **SAME** _____
CITY/STATE/ZIP _____

TYPE CODE	ORDER TYPE	VEHICLE IDENTIFICATION NUMBER
R	REGULAR	
P	POLICE	
D	DOWN VEHICLE	
W	WARRANTY	

DEALER ORDER	
ORDER DATE	
DEALER NO.	
ORDER TYPE	D-W
WARRANTY CLAIM NO.	

FOR OFFICE USE ONLY	
ACCT.	111-632.5
FRT. ACCT.	111-632.5

[illegible]

**PLEASE USE PART NUMBERS
DO NOT USE FOR
CORRESPONDENCE**

F-1040

ALL ORDERS SUBJECT TO ACCEPTANCE AT MILWAUKEE, WI 53201

All goods covered by this order, including goods banded, will be billed at prices current at the time of shipment. Goods are purchased for resale and delivery is made to purchaser F.O.B. factory, Milwaukee, Wisconsin or other point of origin. If accepted, this order as accepted shall be subject to availability of goods to seller for delivery to purchaser. Any delay in shipment shall not relieve purchaser of responsibility for his accepted order and seller shall not be liable for any loss or damage due to delay in shipment or failure to deliver. Any request for cancellation of this order or any part thereof must be received by seller prior to the date of shipment, and in case of reconignment or return of goods to seller, purchaser shall pay the entire cost connected therewith, plus zero, ten or twenty-five percent of selling price, as determined by Company policy from time to time, as liquidated damages for loss of sale. Purchaser will be responsible for collection and payment of all Federal, State and local taxes that apply on the retail sales.

**PLEASE USE PART NUMBERS
DO NOT USE FOR
CORRESPONDENCE**

PRINTED
IN U.S.A