



**2020-04-30**

[illegible]

- *Scheduled service*
- *Customer notices low transmission fluid level*

5. Check fluid levels when vehicle returns.
6. If primary oil is high and transmission oil is low, measure fluid levels.
  - a. Write the mileage and the amount of measured fluid transfer in the service records.
7. If Vehicle's oil transfer is equal to or greater than the stated amount, go to Installation of Service Kit.

#### NOTE

*Before performing the vent kit installation or filing a claim, have the recorded mileage and measured fluid transfer available upon request.*

### Installation of Service Kit

#### NOTE

- *This informs dealers of an update to the installation of service kit (Part No. 26500027) for 2017 and 2018 vehicles.*
- *Verify that the most current version of the instruction sheet is used. It is available at: [www.harley-davidson.com/isheets](http://www.harley-davidson.com/isheets)*

1. See Figure 1. Check for vent tube (1).
  - a. If vent tube is present **STOP**, this service procedure has already been performed.
  - b. If vent tube is not present, go to 2.
2. Install Inner Primary Vent Service Kit (Part No. 26500027) per the instructions included in the kit.
3. **2017 - 2018 Models: STOP** kit installation is completed.
4. **2019 Models:** Remove oil deflector.
  - a. Remove transmission inner side cover. See the service manual.

- b. Remove mainshaft transmission oil deflector (Part No. 36300026).
- c. Install transmission side covers. See service manual.

### Credit Procedure

#### NOTE

- *Enter bulletin number into comment section of claim.*
- *All claims submitted after September 8, 2019, will be paid at the labor time shown in Table 3.*

#### The claim will not be processed without the following information added to the comment section:

1. The initial adjustment that the primary and transmission fluids were adjusted to (manufacturers recommended levels).
  - Primary and transmission fluid adjustment levels noted in Verification of Oil Transfer - Steps 1b and 2b along with date and mileage at time of initial adjustment.
2. Verification that supports the installation of the vent kit.
  - Mileage:
  - Transmission fluid level measurement:
  - Primary fluid level measurement:

For vehicles currently under warranty, submit a warranty claim per Table 3.

**Table 3.**

ITEM	DATA
Claim Type	MC/Standard
Problem Part Number	26500027
Quantity	1
Primary Labor Code	4313
Time	2017 and 2018 models - 1.4 h 2019 models - 2.1 h
Customer Concern Code	3102
Condition Code	9106

### Return Parts

Hold all claimed parts for 60 d from date of credit issued for possible field inspection and/or request to return to factory. After 60 d, destroy and discard the parts.

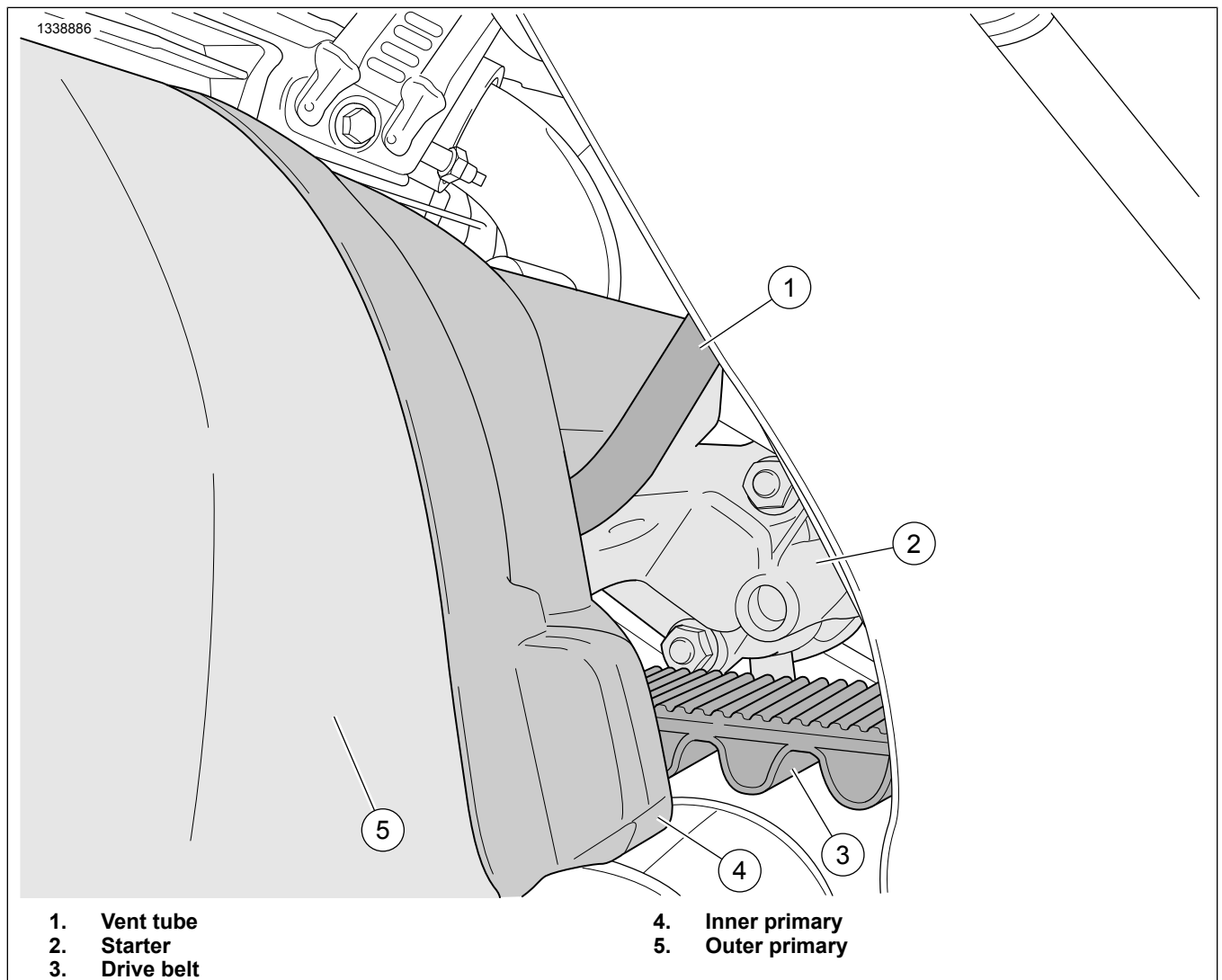

Figure 1. Inner Primary Vent Tube