

SERVICE BULLETIN



M-1375

August 24, 2014

2015 ROAD GLIDE HANDLEBAR ADJUSTMENT AT PDI

Purpose

This bulletin is to inform dealers that an additional procedure is needed during PDI on certain 2015 Road Glide models. To help provide a great initial experience for potential customers, the handlebars on all 2015 Road Glide models are to be adjusted fully forward.

Motorcycles Affected

This information applies to all 2015 FLTRX, FLTRXS and FLTRUSE models built before August 12, 2014. All models built after August 12, 2014 will have the handlebar adjusted during assembly. At the time of delivery, the handlebars can be adjusted to the riders preference, within the limits of the adjustment range.

Markets Affected

All markets are affected.

Required Dealer Action

1. Remove the main fuse.
2. Remove instrument bezel:
 - a. **FLTRX, FLTRXS:** Remove ignition switch knob. See the service manual.
 - b. See Figure 1. Lift the rear of the ignition switch cover (3). Remove cover.
 - c. Remove screws (1) on each side of instrument bezel.
 - d. Lift instrument bezel (2) to remove.
 - e. Disconnect instrument connector. Disconnect accessory switch connectors. Remove bezel assembly.
3. Loosen rear screws on the upper handlebar clamp.

NOTE

The handlebars on 2015 Road Glide models have limit pins incorporated into the handlebar mount.

4. Position handlebars as far forward as limit pins will allow.
5. Snug upper handlebar clamp screws.

6. Tighten the upper handlebar clamp screws to 16-20 ft-lbs (21.7-27.1 Nm).
7. Install instrument bezel:
 - a. Connect accessory switch connectors.
 - b. Connect instrument connector.
 - c. Lower instrument bezel assembly (2) into place. Engage pins on rear of the bezel into holes in nacelle.
 - d. Install screws (1) on each side of bezel. Tighten to 10-15 **in-lbs** (1.1-1.7 Nm).
 - e. Engage tabs of switch cover (3). Press down on rear to secure.
 - f. **FLTRX, FLTRXS:** Install ignition switch knob. See the service manual.
8. Install the main fuse.

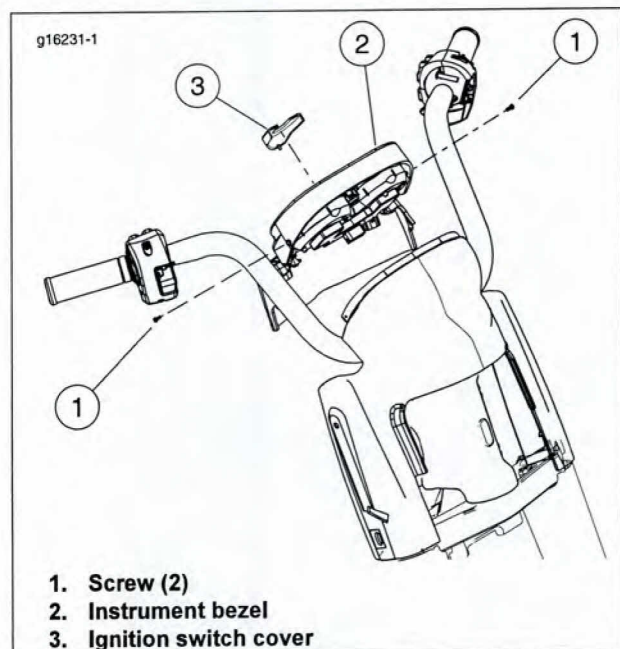

Figure 1. Instrument Bezel

NOTE

In the interest of preserving customer safety and satisfaction, always check for outstanding recalls whenever any motorcycle is brought into your dealership for either maintenance or service.

ROUTING	SERVICE MANAGER	SALES MANAGER	PARTS MANAGER	WARRANTY PROCESS MANAGER	LEAD TECHNICIAN	TECHNICIAN NO. 1	TECHNICIAN NO. 2	TECHNICIAN NO. 3	RETURN THIS TO
INITIAL HERE									

© 2014 H-D