

[illegible]

2. See Figure 2. Hold secondary clutch actuator upright. Install copper washer (Part No. 12300027) in the actuator cavity. Allow copper washer to self-center.
3. Tighten the clutch line flare nut to initial torque.
Torque: 10.9–16.3 N·m (96–144 **in-lbs**) *Clutch line flare nut - initial torque*
4. Install secondary clutch actuator. See service manual.
5. If leak still persists increase torque to secondary torque.
Torque: 16.3–22.6 N·m (144–200 **in-lbs**) *Clutch line flare nut - secondary torque*
6. If a leak is still present, replace the secondary clutch actuator (Part No. 37200023).
7. Verify proper clutch operation.

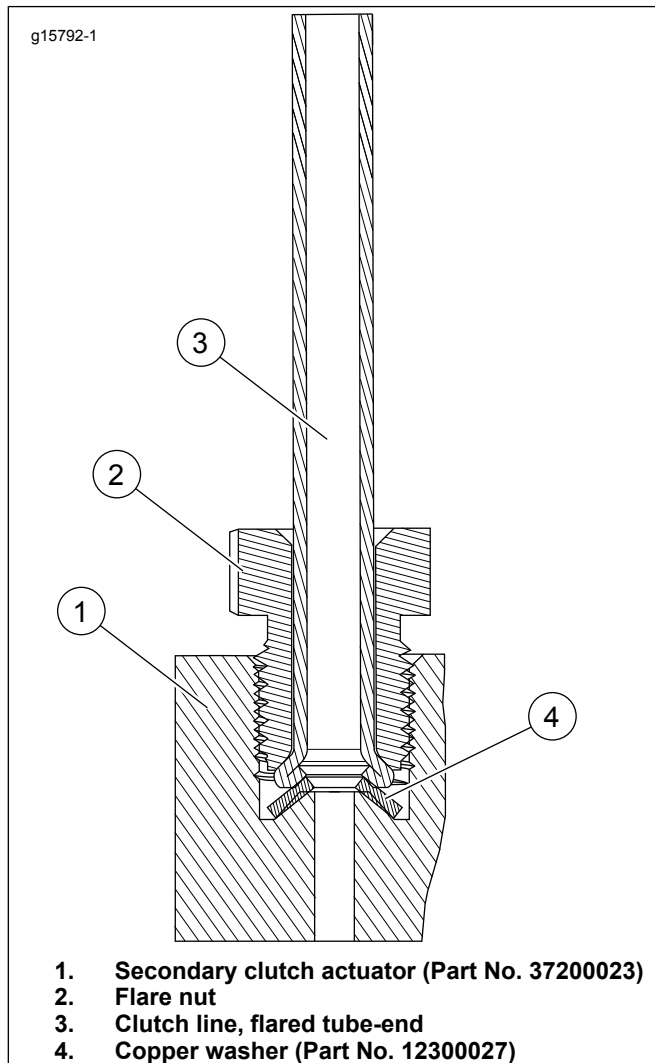

Figure 2. Copper Washer Orientation