

SERVICE BULLETIN



M-1230A

October 29, 2008

2009 TRI GLIDE SERVICE INFORMATION

Purpose

Please note that this revised bulletin contains updates to the **Uncrating and Reverse Motor Circuit Breaker** sections. This bulletin also includes a new **Pallet Return** section.

This service bulletin is to inform dealers of service and tool information for 2009 FLHTCUTG Models.

Motorcycles Affected

All 2009 Tri Glide Models.

Required Dealer Action

Uncrating

Tri Glide pallets must be moved with a forklift utilizing 54" (1372 mm) or longer forks. This requirement has not changed since the introduction of the returnable pallets. Shorter length forks could cause pallet to bend which could cause pallet/vehicle damage.

NOTE

*Vehicle damage can occur during removal from pallet.
Plywood must be secured to pallet during vehicle removal.
Follow instructions below to prevent damage to vehicle.*

See Figure 1. When removing the Tri Glide from the pallet, **do not remove eye bolts** (1) and screws (3) securing plywood (2) to pallet. The plywood overhangs the back of the pallet. Place wood or other suitable material under overhang to support (5). Verify that plywood is secured to pallet before backing vehicle off. If eyebolts and screws are removed before removing vehicle from pallet, plywood may shift and cause damage to vehicle. It is acceptable to roll rear wheels over eye bolts.

Pallet Return

Tri Glide pallets can be returned in the same manner as other returnable pallets. Before pallets can be returned, all lumber affixed to pallet must be removed. Lumber does not need to be returned.

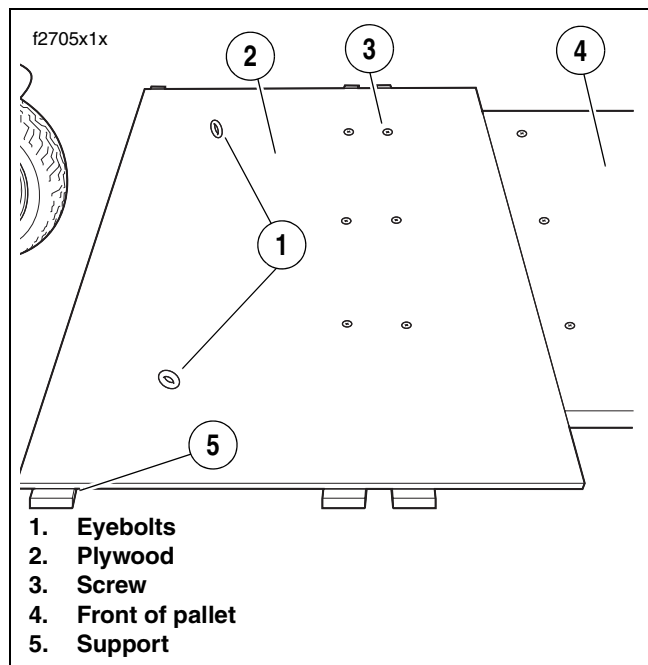

Figure 1. Eye Bolts

IMPORTANT NOTE

In the interest of preserving customer safety and satisfaction, always check for outstanding recalls whenever any motorcycle is brought into your dealership for either maintenance or service.

ROUTING	SERVICE MANAGER	SALES MANAGER	PARTS MANAGER	WARRANTY PROCESS MANAGER	LEAD TECHNICIAN	TECHNICIAN NO.1	TECHNICIAN NO. 2	TECHNICIAN NO. 3	RETURN THIS TO
INITIAL HERE									

©2008 H-D

Rear Axle Grease Fitting

See Figure 2. The Tri Glide rear axle assembly (1) contains a grease fitting (2). The rear axle assembly is lubricated during assembly and does not require any additional grease. Do not apply any grease to this fitting. The additional grease may not be compatible with the existing lubricant, which can cause damage to the rear axle assembly.

Reverse Motor Circuit Breaker

The reverse motor circuit breaker will open if attempting to engage reverse when parking brake is applied. The circuit breaker will also open if front or rear brakes are applied while pushing reverse switch.

To prevent reverse motor circuit breaker from being tripped, be sure parking, front and rear brakes are disengaged before attempting to back up. In addition, to prevent tripping of breaker, release reverse switch before applying front or rear brakes.

If reverse motor circuit breaker is tripped, follow instructions below or refer to the TRI GLIDE MODEL OWNER'S MANUAL to reset breaker.

1. See Figure 3. The circuit breaker is located under the passenger seat. This manually resettable circuit breaker has a trip push button (2) and a reset switch (1). To manually trip the circuit breaker, push down on the trip push button (which causes the reset switch to extend out).
2. If the reset switch is extended as shown, the reverse circuit is open/tripped. Push the reset switch into the center of the circuit breaker body until an audible click is heard to reset.

NOTE

The reverse enable lamp in the hand control housing will illuminate even if the circuit breaker is tripped/open.

Predelivery and Set-Up Manual

The printed copy of the 2009 PREDELIVERY AND SET-UP MANUAL did not contain information on Tri Glide vehicles. The Tri Glide set-up instructions may be found on the service section of h-d.net. The path to the manual is: h-d.net.com/Departments/Service/Literature & Publications/Product Literature & Catalogs/Pre-Delivery & Set-Up Information.

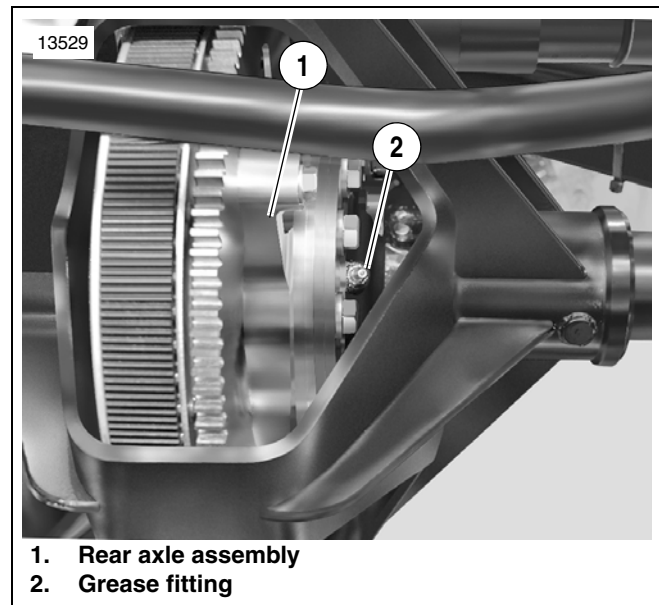

Figure 2. Rear Axle Grease Fitting

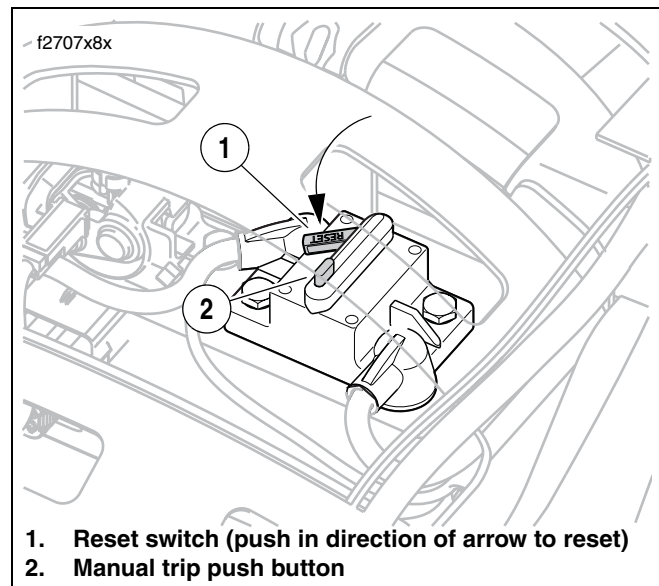

Figure 3. Reverse Motor Circuit Breaker

Tools

The Tri Glide's running weight is 1174 lbs (533 kg). Any lift used must be rated above this weight. Use a lift such as the Handy model number 14472, which has a 1500 lb (680 kg) capacity. A trike extension (Handy model number 14475) is available for this lift.

Many of the special tools needed to service FLHTCUTG models are already in dealer inventory. Additional common special tools will be needed to service the Tri Glide. For tool information, refer to Table 1.

Table 1. Tri Glide Special Tools

PART NUMBER	TOOL DESCRIPTION
HD-43644	Camshaft Remover and Installer (used for differential disassembly)
HD-95635-46	All-Purpose Claw Puller
HD-35316-12	Installer Cup (used to install differential carrier bearings)
HD-34634	Fork Bushing and Seal Installer (used to install axle bearing)
HD-45327	Swingarm Bearing Installer (A 4.507" spacer will need to be used with tool)
HD-48219	Primary Drive Locking Tool
HD-49303 or equivalent	Axle Puller (may be required for higher mileage vehicles)
HD-95770-69 (#5 hammer) and HD-95771-69 (Shaft)	Slide Hammer (5/8-18 UNF thread pattern)
HD-49762 or equivalent	Harmonic Balancer Puller (used to service differential)
	25 ton adjustable I-beam press (used to remove and install axle bearings)
	Fish Scale or Digital Force Gauge-capable of measuring up to 50 lbs (used to set parking brake lever force)
Coats 700	Tire machine that can statically balance rear wheel when used with accessory B cone
Handy 14472	Lift
Handy 14475	Trike Extension
	Magnetic Base Laser or Long Straight Edge (used for axle alignment)