

SERVICE BULLETIN



M-1109

January 23, 2001

JIFFY STAND LEG FOR 2001 MODEL DYNA LOW RIDER (FXDL) (PRODUCT PROGRAM NO. PP7)

Purpose

The jiffy stand legs on some FXDL motorcycles may not fully lock in the down or forward position. This could allow the motorcycle to fall over. Harley-Davidson has elected to replace all suspect jiffy stand legs.

Motorcycles Affected

The motorcycles requiring jiffy stand leg replacement are identified in the DEALER COMMUNICATIONS letter attached to this bulletin. The letter lists the Vehicle Identification Numbers (VIN) of the motorcycles shipped to your Dealership.

Replacement Jiffy Stand Legs

The replacement jiffy stand leg Part No. is: **49729-95A**.

Customer Notification

Because only registered owner's, as shown on the attached list, will receive notification from us, we request that you contact owners of vehicles still listed as unregistered, advise them of this Service Bulletin and make arrangements with them to come in for the required service.

Required Dealer Action

(1) CHECK ATTACHED VIN LIST

Check VIN list for motorcycles that were shipped to or sold by your dealership. If your dealership has in stock or has sold any of the motorcycles on the VIN list, perform all actions required by this Bulletin.

(2) REMOVAL OF STOCK JIFFY STAND LEG

1. Raise and block motorcycle underneath frame so both wheels are raised off the ground.
2. See Figure 1. Remove cotter pin and washer (1) from pin (2). Discard cotter pin.
3. Detach spring (3) from jiffy stand leg (4) and anchor plate (5).
4. Pull pin (2) from frame crossmember. Lower and pull jiffy stand leg and pivot block components outboard to disengage forked end of pivot block (6) from tubular section of threaded spacer (7).

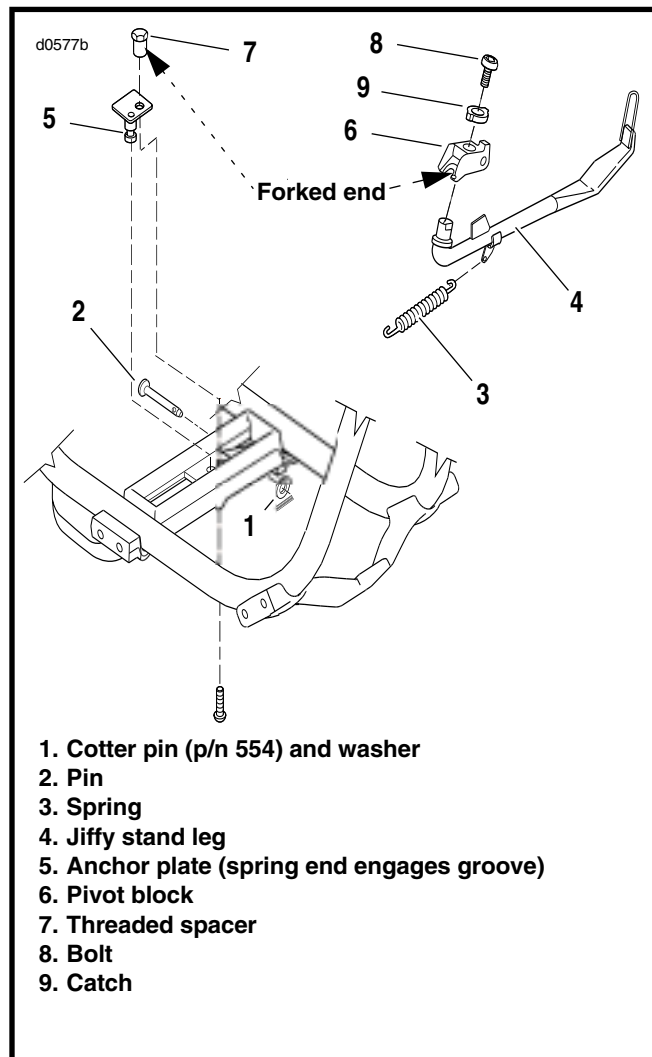

Figure 1. Jiffy Stand

5. Place jiffy stand leg in vise fitted with soft metal jaw protectors and remove bolt (8), catch (9) and pivot block (6) from jiffy stand leg.

(3) CLEANING, LUBING AND ASSEMBLING

1. Clean catch (9) and pivot block (6) mating surface.
2. Spray LOCTITE AEROSOL ANTI-SEIZE on shaft of new jiffy stand leg to lubricate the mating surface between leg and pivot block (6).

ROUTING	SERVICE MANAGER	SALES MANAGER	PARTS MANAGER	LEAD TECHNICIAN	TECHNICIAN NO.1	TECHNICIAN NO. 2	TECHNICIAN NO. 3	TECHNICIAN NO. 4	RETURN THIS TO
INITIAL HERE									

3. Spray LOCTITE AEROSOL ANTI-SEIZE on the catch (9) and on the mating surface on pivot block (6).
4. Place catch (9) so it engages the flats on the shaft of the jiffy stand leg and secure with bolt (8).
5. Place jiffy stand leg in vise fitted with soft metal jaw protectors and tighten bolt (8) to 19 ft-lbs (25.8 Nm).

(4) INSTALLING JIFFY STAND LEG ASSEMBLY

NOTE

Position jiffy stand leg at about the midpoint between the up and down position. This will position lugs on catch (9) so they do not extend beyond sides of pivot block (6) and catch on opening in frame crossmember.

1. See Figure 1. Insert pivot block (6) and jiffy stand (4) assembly through opening in frame crossmember and engage forked end of pivot block (6) on tubular section of threaded spacer (7).
2. Spray LOCTITE AEROSOL ANTI-SEIZE on pin (2) and insert the pin from direction shown through frame crossmember and hole in pivot block (6). Secure with washer and a **new** cotter pin, Part No. 554, from your stock.
3. Attach spring (3) to anchor plate (5) and jiffy stand leg. When properly installed, hook on spring end connected to jiffy stand leg faces upward.
4. Check that jiffy stand operates correctly before using.

Credit Procedure

After servicing each vehicle, complete a regular warranty claim referencing Service Bulletin M-1109 in the "Description of Repair" section of the claim. Fill in the rest of the claim as follows:

CLAIM TYPE	PP7
QUANTITY	0
PROBLEM PART NO.	49729-95
PART DESCRIPTION	jiffy stand leg
ADDITIONAL PART NO., QTY. & DESCRIPTION	(1) 49729-95A - jiffy stand leg (1) 554- cotter pin
PRIMARY LABOR CODE	2396
TIME	0.3 HOUR
CUSTOMER CONCERN CODE	9203
CONDITION CODE	9111

Upon receipt and processing of claim, you will receive appropriate credit for parts and labor.

Disposition Of Part No. 49729-95 Legs in Dealer Stock

Follow normal defective stock claim procedures. Upon receipt of a properly completed claim, you will receive a bar coded label to return the jiffy stand legs. Upon timely receipt of the parts, you will receive appropriate parts and return postage credit.