

SERVICE BULLETIN

M-1084

May 1, 1999



SOFTAIL AND DYNA GLIDE CARBURETOR UPDATE

General

The purpose of this bulletin is to inform you of the release of a kit to address drivability issues relating to Softail and Dyna Glide model motorcycles, specifically those equipped with carburetor Part No. 27492-96.

On certain Softail and Dyna Glide model motorcycles, in stock configuration, the fuel mixture may be too lean and cause the bike to run rough. This condition can be corrected by installation of the carburetor update kit, Part No. 27365-98. The kit is available to customers experiencing this drivability issue on the affected models. See Credit Procedures.

The Carburetor Update Kit, Part No. 27365-98 consists of:

Jet Needle Part No. 27255-96

Main Jet Part No. 27114-88 (Size 180)

Float Chamber Assembly Part No. 27287-98

The kit may be used on 1996, 1997, 1998, or 1999 Softail 49 State motorcycles and Canadian and Japanese HDI versions. All 1999 Softails built prior to January 15, 1999 have the old carburetor and may be updated with this kit. All 1999 Softails built after January 15, 1999 will already have the new carburetor installed (Part No. 27492-96A).

The update kit may also may be used on 1996, 1997 or 1998 Dyna Glide 49 State motorcycles and Canadian and Japanese HDI versions. The kit is scheduled to be available on May 1, 1999.

Service Procedures

Installing Carburetor Update Kit

Carburetor Removal



Gasoline is extremely flammable and highly explosive. Always stop the engine when refueling or servicing the fuel system. Do not smoke or allow open flame or sparks near the work site. Inadequate safety precautions could result in death or serious injury.

1. Make sure fuel supply valve is in OFF position.
2. Disconnect and plug the fuel supply line.

3. Remove air cleaner and backplate. See Air Cleaner, Removal in Section 4 of Service Manual.
4. Disconnect the throttle cables from carburetor. See Throttle Control in Section 2 of Service Manual.
5. Slide enrichener and cable out from slot in bracket on left side of motorcycle.
6. Remove vacuum hose from the carburetor. Pull carburetor free of seal ring and manifold and place in clean work area.

Replacing Main Jet and Float Chamber

1. See Figure 1. Turn carburetor upside down and remove four phillips head screws with captive washers and float chamber assembly from carburetor body.
2. Hold flats of needle jet holder with an 8 mm open end wrench and remove main jet with a thin bladed flat tip screwdriver by turning counterclockwise.
3. Install **new** main jet to needle jet holder with a flat tip screwdriver.
4. Install **new** float chamber assembly to carburetor body with four phillips head screws with captive washers.

Replacing Jet Needle

1. See Figure 1. Turn carburetor upright. Remove two screws and one washer that mount throttle cable bracket to carburetor body and top. Rotate throttle cable bracket clockwise, away from cover.
2. Remove three top screws and washers from top. Remove top.
3. Remove diaphragm and vacuum piston assembly. Inspect diaphragm for pinholes, tears or other damage. Replace if damaged.
4. Remove spring and spring seat. Holding hand over upper opening of carburetor, flip carburetor upside down to allow jet needle to fall free.
5. Install **new** jet needle and install spring seat and spring.

NOTE

Diaphragm expands when in contact with fuel. If diaphragm is difficult to seat in groove because of this condition, allow diaphragm to dry before attempting to install.

ROUTING	SERVICE MANAGER	SALES MANAGER	PARTS MANAGER	LEAD TECHNICIAN	TECHNICIAN NO. 1	TECHNICIAN NO. 2	TECHNICIAN NO. 3	TECHNICIAN NO. 4	RETURN THIS TO:
INITIAL HERE									

1999 Harley-Davidson® Inc.

6. Install diaphragm and vacuum piston assembly. Check to make sure diaphragm is seated in groove.
7. Install top and throttle cable bracket with four screws. Make sure diaphragm is not pinched under top.
8. Install throttle bracket to carburetor body with screw.
9. Make sure accelerator pump boot is snug over float chamber.
10. Check for proper diaphragm seal by pushing up on vacuum piston and releasing (from intake side). Very slight resistance should be felt when pushing up and piston should be slow to extend if diaphragm is sealed correctly.

Installing Carburetor

1. See Figure 1. Mate carburetor outlet to seal ring on manifold. Make sure carburetor is in a true vertical position. Misalignment could damage manifold seal ring.
2. Connect throttle cables and vacuum hose to carburetor. Install enrichener cable in mounting bracket and adjust. See Adjustments, Section 4 of Service Manual.
3. Unplug and install fuel supply line to carburetor.
4. Install air cleaner backplate and air cleaner. See Air Cleaner, Installation in Section 4 of Service Manual.
5. Route the float bowl overflow line between the rear cylinder push rods, behind the neutral switch and oil line, then down between crankcase.
6. Turn fuel valve to ON position and inspect fuel lines for leaks.

WARNING

Gasoline is extremely flammable and highly explosive. Always stop the engine when refueling or servicing the fuel system. Do not smoke or allow open flame or sparks near the work site. Inadequate safety precautions could result in death or serious injury.

7. Start motorcycle and inspect for fuel leaks.
8. Test ride motorcycle and check for proper cable function.

Credit Procedures

To receive credit, complete a regular Warranty Claim referencing Service Bulletin M-1084 in the "Description of Repair" section. Fill in the rest of the claim as follows:

*CLAIM TYPE	*MC or PRD or **GDW
QTY.	0
EVENT PROBLEM PART NO.	27492-96
PART DESCRIPTION	Carburetor
PRIMARY LABOR CODE	3520
EVENT ADDITIONAL PROBLEM PART NO. AND QTY.	27492-96A QTY 1
TIME	0.6 hr
CUSTOMER CONCERN	9203
CONDITION CODE	1105

* Use "MC" if motorcycle has been sold. Use "PRD" if motorcycle is in your inventory.

** If vehicle is out of warranty and experiences a drivability issue relative to this condition, submit a request for a policy adjustment. If policy adjustment is granted, use GDW claim type and include the authorization number.

Send a properly completed claim to Harley-Davidson for each vehicle serviced. After processing of the claim, you will be credited for the labor.

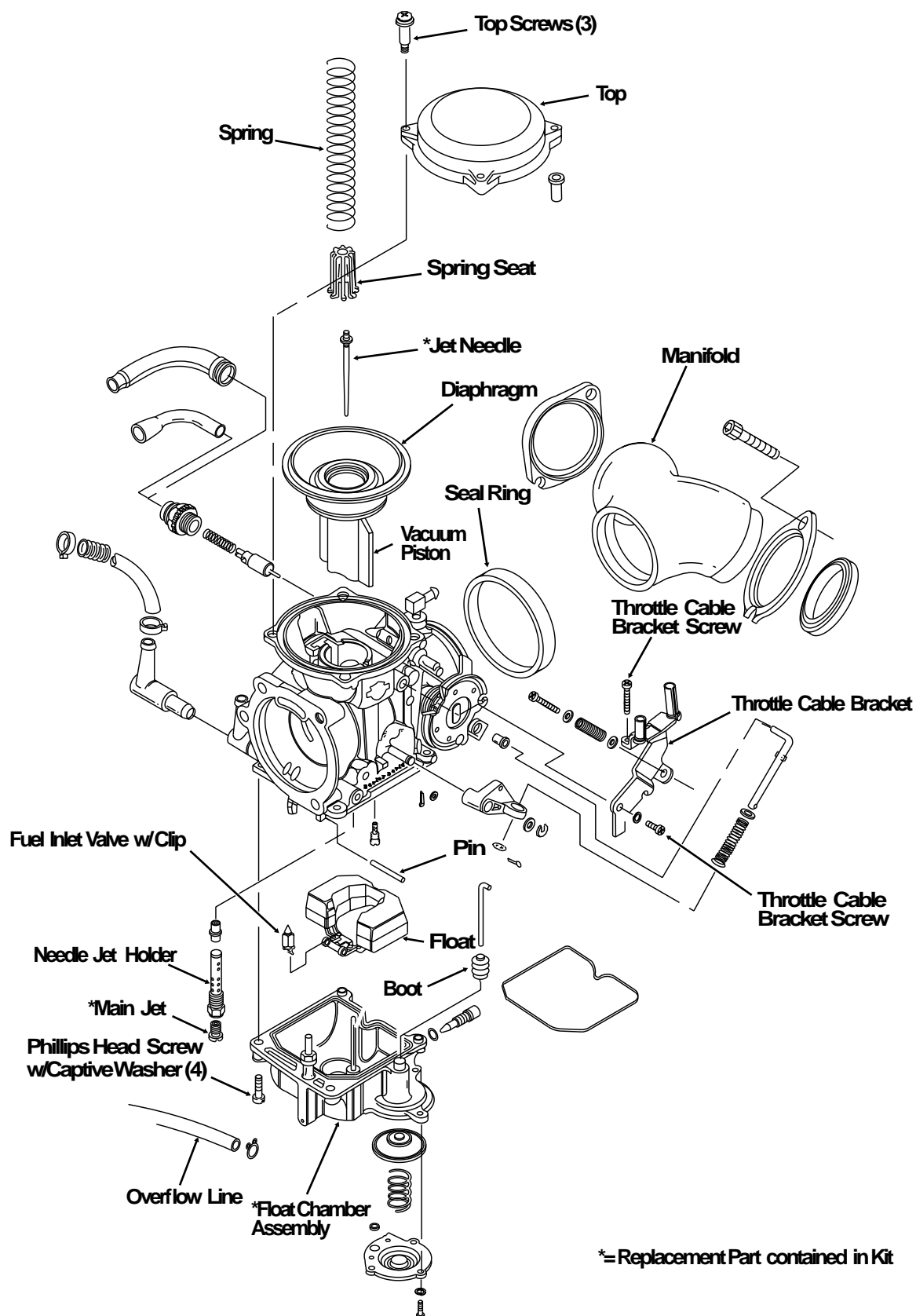

Figure 1. Carburetor