

# SERVICE BULLETIN



M-1070

Safety Recall Code 090

December 12, 1997

## 1998 FL TOURING/FL SOFTAIL REAR BRAKE PEDAL ASSEMBLY

### General

### IMPORTANT NOTE

As recently advised in ML-350, Harley-Davidson has decided that a defect that relates to motor vehicle safety exists with the rear brake pedal assembly in certain 1998 FL Touring/FL Softail model motorcycles. Harley-Davidson has determined the rear brake pedal assembly may have an inadequate weld. This condition could allow the lever hub to separate from the master cylinder lever thus affecting rear brake performance. This condition could occur without warning. Front brake performance is not affected.

As a precautionary measure, Harley-Davidson has elected to initiate a voluntary recall campaign in the interest of motor vehicle safety and customer satisfaction. This voluntary recall applies to all 1998 FL Touring/FL Softail models motorcycles that were manufactured at our York, PA facility from November 3, 1997 through November 18, 1997, and shipped within the same period. All potentially affected vehicles are being recalled to have the rear brake pedal assembly replaced.

Attached is a list which contains:

- the vehicle identification numbers (VIN) of all vehicles that were delivered to your dealership and are involved in this recall campaign.

To ensure rider safety, it is your responsibility to perform the required service on all affected vehicles even if the motorcycle was not purchased from your dealership. You will be required to perform the required service on all affected vehicles in your dealership inventory prior to selling or leasing those vehicles.

If you are not sure that a safety recall has been completed on a particular motorcycle, contact the Harley-Davidson Recall Information Line at 1-800-448-1708 for a computer check of our recall records.

Because only registered owners will receive notification from us, we request that you contact any owners of vehicles that your records show as unregistered. Advise them of the safety recall and make arrangements for them to come in for recall service. We also require that you provide us with their names, addresses and VIN's as soon as possible to enable us to mail them an owner's letter, as required by the National Traffic and Motor Vehicle Safety Act (as amended).

A shipment of Recall Code 090 Kits (Part Number 93825) will contain all of your total estimated kit requirements and will begin on or around December 18, 1997. All kits will be shipped no charge, transportation paid. If additional kits are needed, please contact Sarah Ottallah at telephone (414) 343-4358. Be prepared to provide a VIN for each kit requested.

The Safety Recall Kit contains the following items.

Qty.	Description
1	Rear Foot Brake Lever
1	Brake Lever Pad
1	Cotter Pin
1	Lock Nut

### NOTE

The procedure on the following page applies to FLT's. For Softail procedure see p. 3.

The procedure in this bulletin is a variation of the procedure found in the Service Manual. This procedure does not require breaking the brake lines and bleeding the system.

ROUTING	SERVICE MANAGER	SALES MANAGER	PARTS MANAGER	LEAD TECHNICIAN	TECHNICIAN NO. 1	TECHNICIAN NO. 2	TECHNICIAN NO. 3	TECHNICIAN NO. 4	RETURN THIS TO:
INITIAL HERE									

1997 Harley-Davidson® Inc.

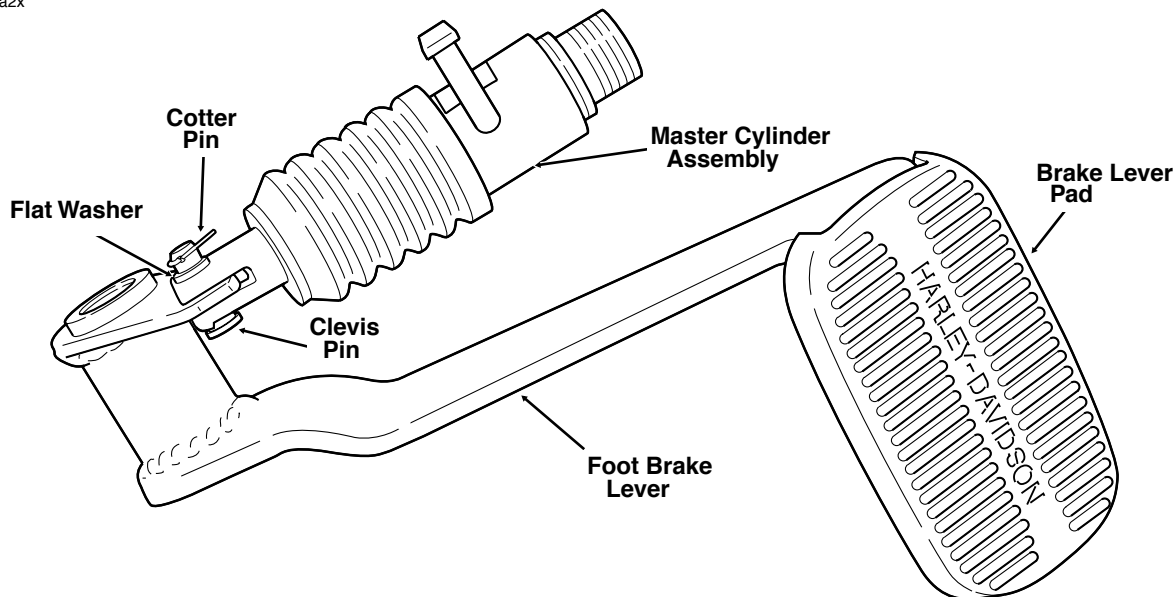

Figure 1. Rear Foot Brake Lever - FLT Models

## BRAKE LEVER REPLACEMENT (FLT MODELS)

### NOTE

- The clevis pin has an interference fit in the clevis on FLT models.
- The procedure in this bulletin is a variation of the procedure found in the Service Manual. This procedure does not require breaking the brake lines and bleeding the system.

## Brake Pedal Removal

### ⚠ CAUTION

On motorcycles equipped with lower fairings, cover lower fairing with protective tape to prevent cosmetic damage.

### NOTE

In some cases it may be necessary to loosen the 3 clamps and remove the front cylinder exhaust heat shield to allow clearance for brake pedal removal.

1. Fold right front footboard up and remove two shoulder allen head bolts with flange nuts. Remove right footboard from vehicle. Loosen two allen bolts and flange nuts and move footboard mounts to allow exhaust heat shield removal if required.
2. See Figure 1. Remove cotter pin and flat washer from clevis pin. Pry out clevis pin using a 12 in. pry bar (Snap On Part No. SPB12) using a sharp tap from a hammer if required. Remove brake pedal from master cylinder assembly.
3. Remove lock nut and flat washer to free brake pedal from pedal shaft. Discard lock nut.

## Brake Pedal Installation

1. Install **new** brake pedal to stud in full forward position. When pedal is on stud, move pedal lever counterclockwise to full rearward position to bring pedal clevis close to master cylinder clevis. Move master cylinder clevis to insert pedal clevis.

### NOTE

- Clevis pin has raised bumps that create an interference fit and leave a groove in inner diameter of clevis. Make sure clevis pin is rotated slightly so it will have an interference fit when reinstalled. Make sure hole in clevis pin will be visible when installed to allow cotter pin to be inserted.
  - If access to clevis is restricted, use large screwdriver to hold alignment of clevis holes and small screwdriver (inserted between master cylinder clevis) to keep pedal clevis from moving forward. Pedal may have to be moved forward to insert clevis pin in some cases.
2. Push brake pedal forward, if required to allow access to clevis hole, while assistant taps in clevis pin using a brass drift and hammer.
  3. Install flat washer and **new** cotter pin to clevis pin using a needle nose pliers. Bend cotter pin to secure in place. See Figure 1.
  4. Install brake pedal on pedal shaft with flat washer and **new** lock nut. Tighten lock nut to 15-18 ft-lbs (20-24 Nm).
  5. Grease zerk fitting with Wheel Bearing Grease, Part No. 99856-92 until a small amount of grease is visible around edges of brake lever.
  6. Install exhaust heat shield if removed.
  7. Install foot boards.
  8. With the Ignition/Light Key Switch turned to IGNITION, actuate the rear brake pedal to verify operation of the brake lamp.

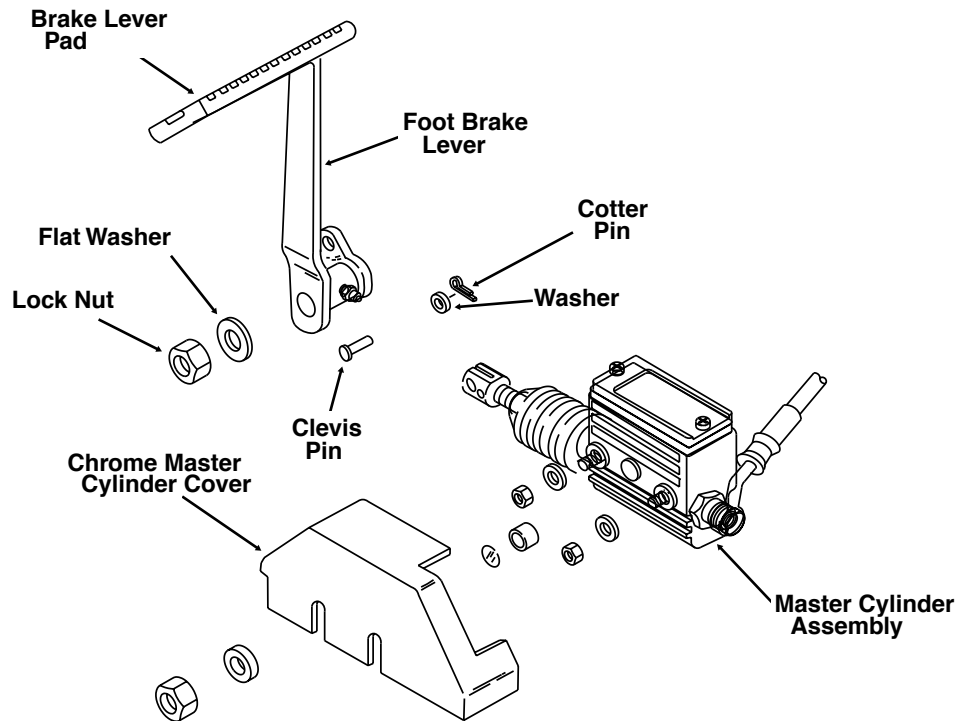

Figure 2. Rear Foot Brake Lever - FL Softail Models

## BRAKE LEVER REPLACEMENT (SOFTAIL FLSTC/F/S MODELS)

### NOTE

The procedure in this bulletin is a variation of the procedure found in the Service Manual. This procedure does not require breaking the brake lines and bleeding the system.

## Brake Pedal Removal

### NOTE

In some cases it may be necessary to loosen the 3 clamps and remove the front cylinder exhaust heat shield to allow clearance for brake pedal removal.

1. Fold right front footboard up and remove two shoulder allen head bolts with flange nuts. Remove right footboard from vehicle.
2. See Figure 2. Loosen two locknuts and washers and remove chrome master cylinder cover.
3. Remove cotter pin and washer from clevis pin. Discard cotter pin.

### NOTE

Clevis pins on Softail models do not have an interference fit and may be pulled out by hand.

4. Remove clevis pin.
5. Remove lock nut and washer. Discard lock nut.
6. Remove brake pedal by bringing full forward to disengage clevis and then full rearward to clear exhaust while pulling brake pedal off stud.

## Brake Pedal Installation

### NOTE

New foot brake lever comes with pad, bushings and zerk fitting installed.

1. Install **new** brake pedal to stud, positioning pedal full rearward to clear exhaust, and then full forward to engage clevis.
2. Align clevis holes and insert clevis pin.
3. Install washer and insert **new** cotter pin to clevis pin.
4. Install flat washer and **new** lock nut. Tighten lock nut to 15-18 ft-lbs (20-24 Nm).
5. Grease zerk fitting with Wheel Bearing Grease, Part No. 99856-92 until a small amount of grease is visible around edges of brake lever.
6. Install chrome master cylinder cover and tighten two lock nuts. Make sure washers are between nut and chrome cover.
7. Install right footboard.
8. With the Ignition/Light Key Switch turned to IGNITION, actuate the rear brake pedal to verify operation of the brake lamp.

## Credit Procedures

For each vehicle repaired, completely fill out a Dealer Service Card. Place a "C" in the letter box. If using the new bar-coded card supplied to the customer with the notification, affix your bar-coded dealer label in the appropriate box. Labels are included with this bulletin. If using the old style Dealer Service Card, be sure you supply all necessary information, including VIN, your dealer number and dealership name and address. Package the replaced rear brake pedal assembly with the card. Affix the return address P-Label, Form Number 1248, to the outside of the package.

When Harley-Davidson receives your properly completed Dealer Service Card and replaced rear brake pedal, you will be credited for 0.4 hour of labor for performing the procedures outlined in this bulletin, which includes 0.1 hour for dealer administration time. You will also be credited for postage.