

SERVICE BULLETIN



M-1014

August 26, 1991

SPORTSTER GAS TANK HARDWARE

General

This Service Bulletin is being issued to make service technicians aware of a situation they may encounter when removing and installing stock 1991 Sportster gas tanks. Additional washers will need to be used to install Sportster gas tanks that have the number "1" stamped on the front mounting tab. Without these additional washers, the gas tank will not mount properly, possibly resulting in gas tank rattling or paint chipping, or damage to mounting brackets.

See Figure 1. To identify this situation, locate the front mounting tab of 1991 XL 883 and 1200 model vehicles. If the number "1" is stamped on the outside of the front mounting tab, additional washers will need to be used on this installation. The additional washers are to be positioned between mounting tabs on the gas tank and coil mounting bracket.

For 1991, XL 883 models with "1" stamped on front mounting tab, use the following hardware components:

QTY	DESCRIPTION	PART NO.
1	Bolt	4100HW (Coarse)
2	Washer	6400HB
2	Washer	6702 (Additional)
1	Nut	7531 (Coarse)

For 1991, XL 1200 models with "1" stamped on front mounting tab, use the following hardware components:

QTY	DESCRIPTION	PART NO.
1	Bolt	3409 (Fine)
2	Washer	6400HB
2	Washer	6702 (Additional)
1	Nut	7577 (Fine)

If there is no number stamped on the outside of the front mounting tab, standard mounting hardware should be used.

For 1991, XL 883 and 1200 models with no number stamped on front mounting tab, use the following hardware components:

QTY	DESCRIPTION	PART NO.
1	Bolt	4100HW
2	Washer	6400HB
1	Nut	7531

ROUTING	SERVICE MANAGER	SALES MANAGER	PARTS MANAGER	LEAD TECHNICIAN	TECHNICIAN NO. 1	TECHNICIAN NO. 2	TECHNICIAN NO. 3	TECHNICIAN NO. 4	RETURN THIS TO
INITIAL HERE									

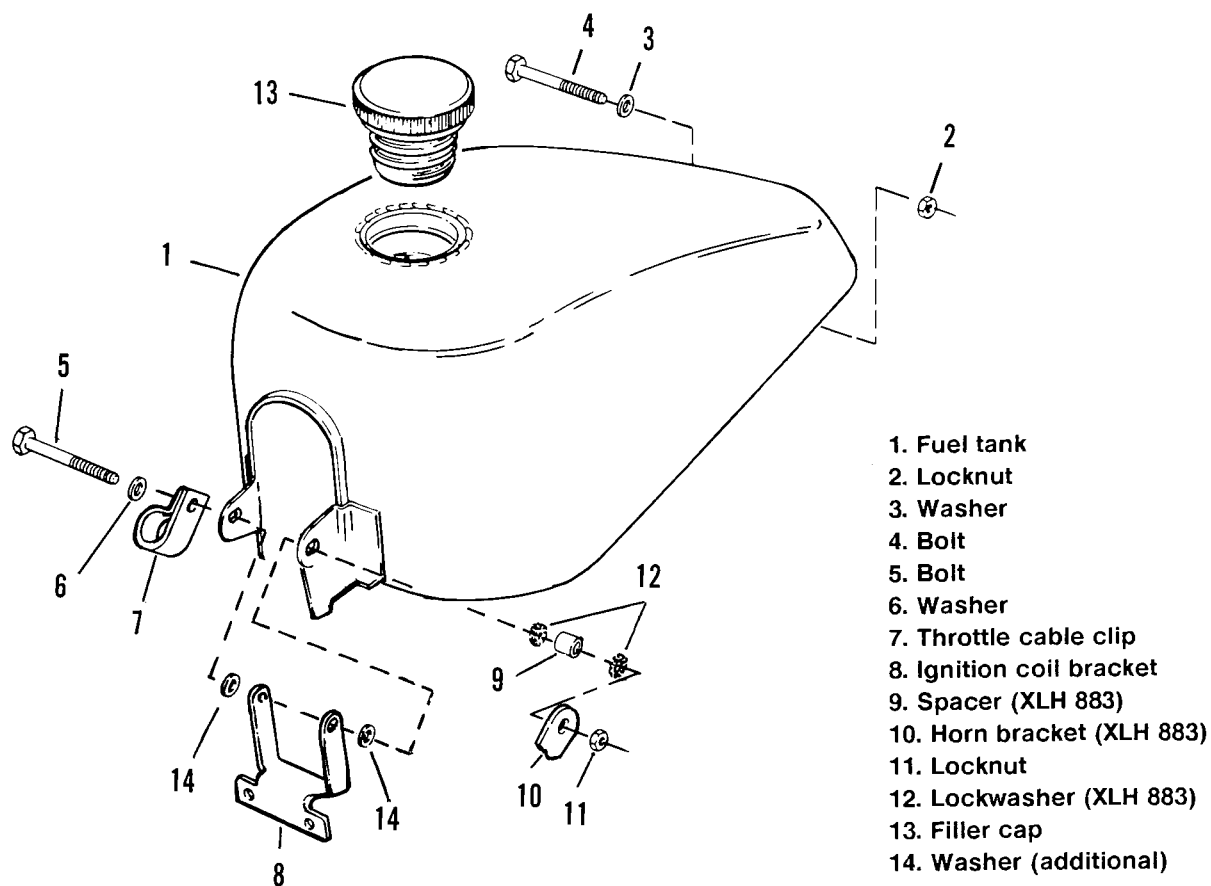

Figure 1. Installation for Tanks With "1" On Tab