

FRONT BRAKE SIDE PLATE RETAINER 1973 MODEL Z-90.

1973 Model Z-90 motorcycles from VIN 3D 10000 H3 to VIN 3D 12607 H3 were produced with an anchor tab for the front brake sideplate which can allow the brake sideplate to disengage under severe braking conditions.

This condition allows the brake sideplate to rotate with the wheel, pull on the control cable and apply the front wheel brake.

The resulting sudden brake application could lock the front wheel, cause the operator to lose control of the vehicle, possibly causing an accident and personal injury.

In compliance with the National Motor Vehicle Safety Act, this has been declared a safety defect and will require that you install a special sideplate retainer on Z-90 motorcycles within the range of vehicle identification numbers listed above.

Note: Subsequent production of Model Z-90 motorcycles (above VIN 3D 12607H3) have a longer anchor tab, and it is relocated higher to prevent accidental disengagement; therefore these motorcycles will not require the retainer. See Service Bulletin No. 640A.

All 1973 Model Z-90 motorcycles up to the above serial number will require the retainer. This includes all affected motorcycles previously delivered to you or your customers and those which will be delivered to you out of warehouses. A list of registered owners and a list of undelivered vehicles involved in this campaign which have been delivered to your dealership are included with this bulletin. It is your responsibility to contact owners of motorcycles sold but which are not listed on the enclosed notification.

We will begin notification of registered owners in your dealership to contact you for this service immediately.

We are sending five part No. 44145-73 retainers along with this bulletin for your immediate use. Included also are 10 washers, part No. 43564-73P which may be required to adjust wheel spacing. Additional quantities can be ordered if required. Installation instructions are at the end of this bulletin.

We urge you to immediately contact each of the owners, as well as any other owners of the involved vehicles in your area that are not listed, and make arrangements to install the retainer. A copy of the letter to the owners is enclosed for your information.

Each letter to the owners will include special service card No. 019 which must be completed, signed by the customer and you, the dealer, at the time service is performed. Extra service cards for undelivered motorcycles are enclosed with this bulletin. If required, additional cards should be ordered from the Service Department stating quantity and defect Code No. 019.

Immediately after service is performed, return completed service cards in an envelope to Harley-Davidson Motor Co., Inc., Attention: Service Department, Milwaukee, Wisconsin 53201.

INSTALLATION INSTRUCTIONS

The sideplate retainer is a special T-shaped cotter pin which should be installed through the top of the fork slider anchor tab. Bend ends open as shown in the illustration so that sideplate cannot disengage from anchor tab.

If cotter pin cannot be installed through anchor tab, check wheel axle spacer installation for correct sequence of parts as shown in diagram below. Note: 1/8" thick washers (Items 4 and 15) are included with this bulletin. Note that original 1/4" thick spacer is replaced by 1/8" thick washer (4) between sideplate and nut (3). Also, a 1/8" thick washer is added between spacer (14) and axle clip on fork side.

This combination of parts will move brake sideplate 1/8" closer to fork side to allow insertion of retainer through the hole in the anchor tab.

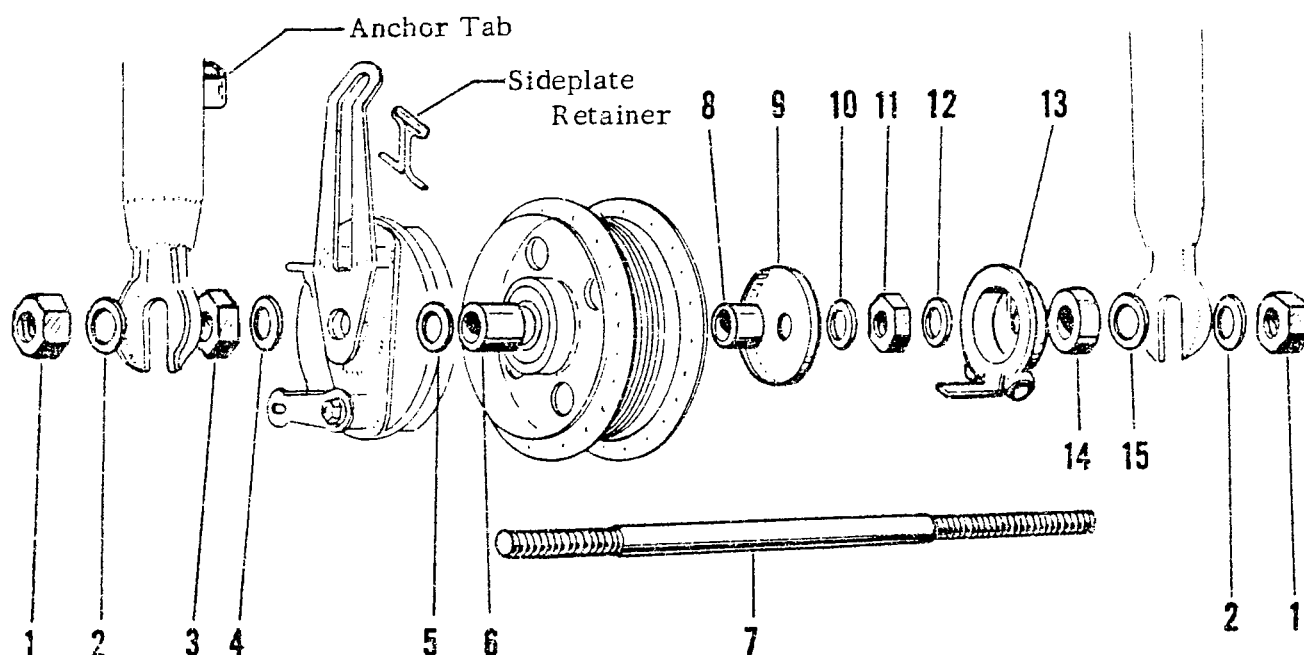

- | | |
|---|--|
| 1. NUT, 3/8" thick x 17 mm HEX. | 8. SPACER, 11/32" thick x 5/8 O.D. x 1/2 I.D. |
| 2. WASHER, 1/8" thick x 7/8 O.D. x 7/16 I.D. | 9. DUST COVER |
| 3. NUT, 1/4" thick x 19 mm HEX. | 10. WASHER, 1/8" thick x 3/4 O.D. x 7/16 I.D. |
| 4. WASHER, 1/8" thick x 15/16" O.D. x 29/64" I.D. | 11. NUT, 1/4" thick x 17 mm HEX. |
| 5. WASHER, .040 thick x 3/4 O.D. x 15/32 I.D. | 12. WASHER, .080 thick x 23/32 O.D. x 7/16 I.D. |
| 6. SPACER, 21/32" thick x 5/8 O.D. x 1/2 I.D. | 13. SPEEDOMETER DRIVE |
| 7. AXLE | 14. SPACER, 1/4" thick x 25/32 O.D. x 29/64 I.D. |
| | 15. WASHER, 1/8" thick x 15/16 O.D. x 29/64 I.D. |

NOTE: If an extra thin shim washer (5) is included with the parts, it should be placed between (5 and 6).