

FRONT AXLE ASSEMBLY / 1973 MODEL Z-90

This bulletin will clarify the correct assembly for the late 1973 Model Z-90 front wheel and axle. This applies above VIN 3D12607 H3 only. For early 1973 models see Service Bulletin No. 648.

The motorcycle front axle and wheel are removed from the front fork for shipment. Axle washers, spacers and nuts will be found reassembled to the axle and boxed separately with the brake sideplate.

Follow the predelivery and setting up instruction sheet included with the crated motorcycle except for installing the front axle and wheel to the front fork. The correct installation is shown below. Parts are numbered in assembly sequence.

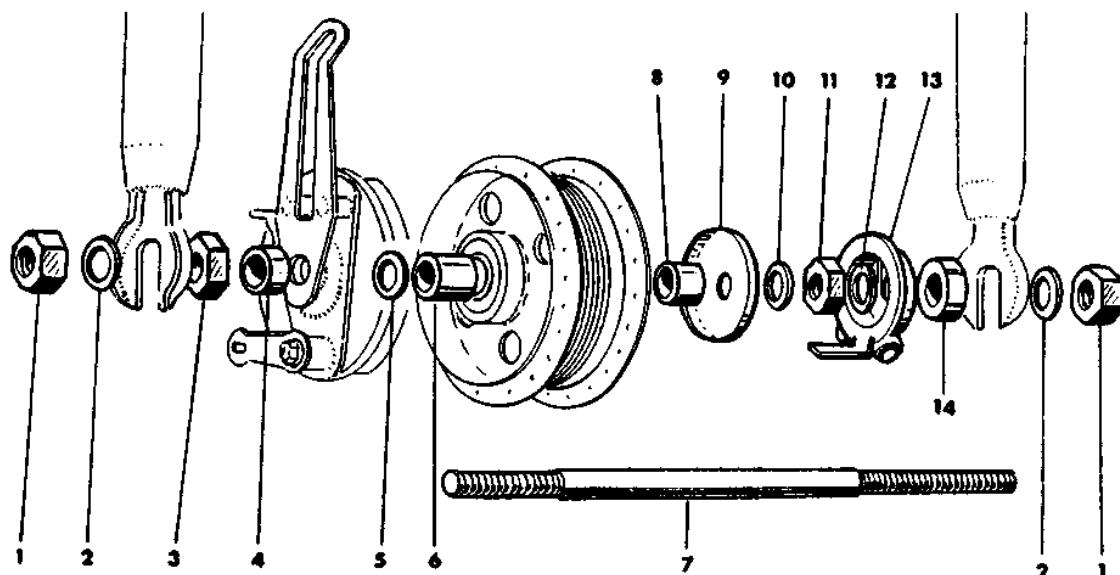

1. NUT, 3/8" thick x 17 mm HEX.
2. SPACER, 1/8" thick x 7/8 O.D. x 7/16 I.D.
3. NUT, 1/4" thick x 19 mm HEX.
4. SPACER, 1/4" thick x 5/8 O.D. x 29/64 I.D.
5. SPACER, .040 thick x 3/4 O.D. x 15/32 I.D.
6. SPACER, 21/32" thick x 5/8 O.D. x 1/2 I.D.
7. AXLE

8. SPACER, 11/32" thick x 5/8 O.D. x 1/2 I.D.
9. DUST COVER
10. WASHER, 1/8" thick x 3/4 O.D. x 7/16 I.D.
11. NUT, 1/4" thick x 17 mm HEX.
12. SPACER, .080 thick x 23/32 O.D. x 7/16 I.D.
13. SPEEDOMETER DRIVE
14. SPACER, 1/4" thick x 25/32 O.D. x 29/64 I.D.

NOTE: If an extra thin shim washer (5) is included with the parts, it should be placed between (5 and 6).

HARLEY-DAVIDSON MOTOR CO., INC.