

# Parts & Accessories Bulletin

Sept. 11, 1989



PAB #432

## CHROME LOWER BELT GUARD

P/N 60366-89

Attached to this bulletin is an instruction sheet that covers the installation of Chrome Lower Belt Guard, P/N 60366-89, on all 1985-later Softail® models equipped with a 70-tooth rear sprocket.

Our original intention was not to include an instruction sheet with this product because its installation was simply removing the stock production lower belt guard and replace it with the Chrome Lower Belt Guard, using the attaching hardware already on the motorcycle.

However, because of the new location of the emission cannister on 1990 California model Softail's, an instruction sheet will be included which covers the installation procedure. For your convenience, the instruction sheet also covers step-by-step instructions on all other non-California Softail models.

In the near future, this instruction sheet will be included in all shipments of this product from Harley-Davidson®. However, please keep the attached for reference should you need to install a Chrome Lower Belt Guard from your stock that does not have an instruction sheet included.

Thank you.



FILE IN ACCESSORY GUIDE FOR FUTURE REFERENCE



# INSTRUCTIONS

60366-89

ORIG. AUGUST, 1989

## FX SOFTAIL CHROME LOWER BELT GUARD

### General

This kit is designed for installation on 1985 and later FXST,FXSTC,FLST,FXSTS, FLSTC and FLSTF vehicles equipped with 70 tooth rear sprocket. This kit will not fit on vehicles equipped with 61 tooth rear sprocket.

This kit contains one Chrome Lower Belt Guard.

### Preparation 1990 and Later California Vehicles Only

1. Block motorcycle underneath frame until rear wheel is raised off the floor.
2. See Figure 2. At upper belt guard, remove bolts (2), washers (3), Acorn nuts (6) allen screw (4) and washer (5). Remove upper belt guard (1).
3. Remove the cotter pin axle nut, lockwasher, and washer. Discard cotter pin.

4. Pull axle out from left side of motorcycle (right side 1990 Fat Boy models) and let the wheel drop down. Remove the spacer.
5. Lift the belt off the rear wheel sprocket and move the wheel assembly backward.
6. See Figure 1. Remove the 4 hex bolts (1) and washers (2) that attach splash guard (3) to swing arm (4). Move splash guard to the rear as far as wires permit. Proceed to the instructions under All Vehicles.

### All Vehicles

#### NOTE

All attaching hardware used to mount the plastic belt guard will also be used to mount the chrome belt guard and all parts are returned to their original location during installation.

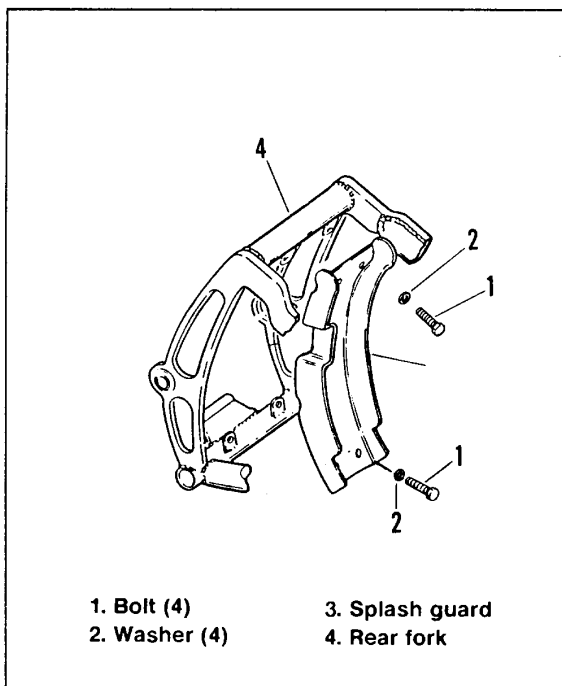

- |               |                 |
|---------------|-----------------|
| 1. Bolt (4)   | 3. Splash guard |
| 2. Washer (4) | 4. Rear fork    |

Figure 1. Splash Guard Mounting

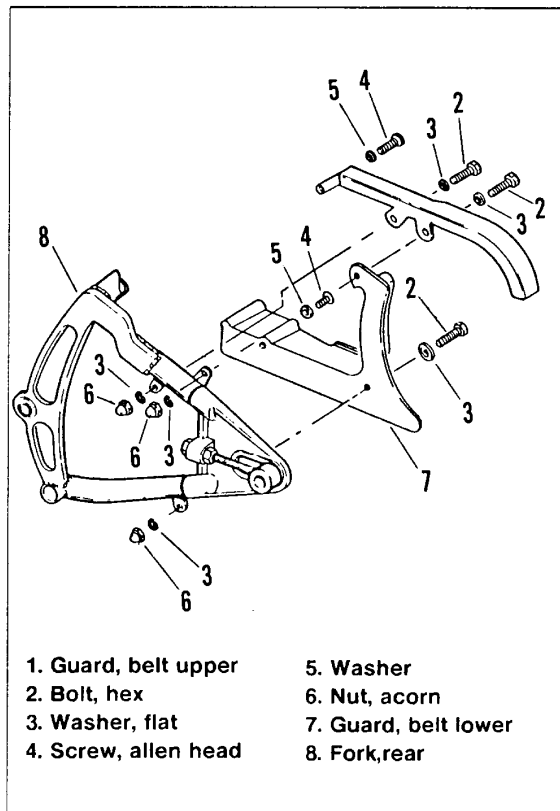

- |                      |                      |
|----------------------|----------------------|
| 1. Guard, belt upper | 5. Washer            |
| 2. Bolt, hex         | 6. Nut, acorn        |
| 3. Washer, flat      | 7. Guard, belt lower |
| 4. Screw, allen head | 8. Fork, rear        |

Figure 2. Belt Guard Mounting

#### NOTE

*The allen head screw in the lower belt guard is removed by reaching through from the right side of the vehicle with an allen head socket driver coupled to a socket extension or flex handle. On 1990 and later California vehicles reach between the splash guard and the rear fork. On all other vehicles reach through the opening between the front of the rear fork and the frame.*

1. Remove the hex head bolts (2), washers (3) and acorn nuts (6) attaching plastic belt guard to rear fork. With allen head socket and long extension or flex handle remove allen head screw (4) at forward end of belt guard. Remove plastic belt guard.
2. Position chrome belt guard, from kit, over belt. Align the holes in guard with mounting lugs on rear fork. Install two hex head bolts (2), washers (3) and acorn nuts (6) to hold guard in position while installing allen screw in forward end. Do not tighten hex bolts at this time.

#### NOTE

*The allen head screw in the lower belt guard is installed by reaching through from the right side of the vehicle with an allen head socket driver coupled to a socket extension or flex handle. On 1990 and later California vehicles reach between the splash guard and the rear fork. On all other vehicles reach through the opening between the front of the rear fork and the frame.*

3. Align forward hole in guard (7) with tapped hole in rear fork (8). Place allen head screw onto end of allen head socket coupled to long extension. From right side of vehicle install allen head screw (4) and washer (5).

#### NOTE

*On 1990 California vehicles install the rear wheel before installing the upper belt guard. See installation 1990 and Later California vehicles only.*

4. At upper belt guard install forward hex bolt (2) washers (3), acorn nut (6) through upper guard (1) and mounting lug on rear fork. Tighten bolts (2) to 19 ft-lbs torque and screws (4) to 12 ft-lbs torque.

### Installation 1990 and Later California Vehicles Only

1. See Figure 1. On 1990 California vehicles place splash guard (3) in position with holes in guard aligned with holes in mounting lugs. Insert four hex head bolts (1) with washers (2) through guard and thread into speed nuts on mounting lugs.
2. Position the wheel between the rear swing arm being sure brake disc is between friction pads. Place belt onto the sprocket.
3. Coat axle with Loctite ANTI-SEIZE. Install axle through left side (right side 1990 Fat boy models) of swing arm, spacer, wheel, rear bracket and right side of swing arm.
4. Install the washer, lockwasher and nut.
5. Tighten the axle nut to 60 ft-lbs torque and install new cotter pin. If required, tighten axle nut further, to align axle nut slot and cotter pin hole. Do not exceed 65 ft-lbs torque.
6. Adjust belt tension before operation.
7. Remove upper bolt (2), washers (3) and acorn nut (6) in lower belt guard (7). Place upper belt guard (1) in position with holes in guard aligned with mounting lugs on rear fork. Install the rear hex head bolt (2) washers (3), and acorn nut (6) through upper belt guard (1) lower guard (7) and mounting lug on rear fork. Install forward hex bolt (2) washers (3), acorn nut (6) through upper guard (1) and mounting lug on rear fork. Place allen head screw (4) with washer (5) onto end of allen head socket driver. From right side of vehicle reach through between rear wheel spokes and thread screw (4) with washer (5) into tapped hole in rear fork. Tighten bolts (2) to 19 ft-lbs torque and screws (4) to 12 ft-lbs torque.