

Buell[®]

AMERICAN MOTORCYCLES

BUELL

BYTES

COMPUTER GENERATED
TECHNICAL UPDATES & INFORMATION
FOR BUELL MOTORCYCLES

ISSUE #5

APRIL 1996

TABLE OF CONTENTS

<u>PAGE</u>	<u>TOPIC</u>
1	New Parts
2	VIN Changes/Literature
3	New Service Tools

Remote Idle Adjuster

A remote idle adjuster now allows carburetor idle adjustments to be made without removing the air cleaner, lowers, or fuel tank. The kit is a stock item on 1996 S1-Lightnings starting with VIN **161-** 49 state and **079-** Calif.

Retrofit kits, part number **27347-96Y**, will be available soon. The kit fits all 1995-96 Thunderbolt, Touring, and Lightning models. The adjusting cable replaces the original idle adjusting screw in the carburetor bracket. A cable strap secures the cable to a frame section.

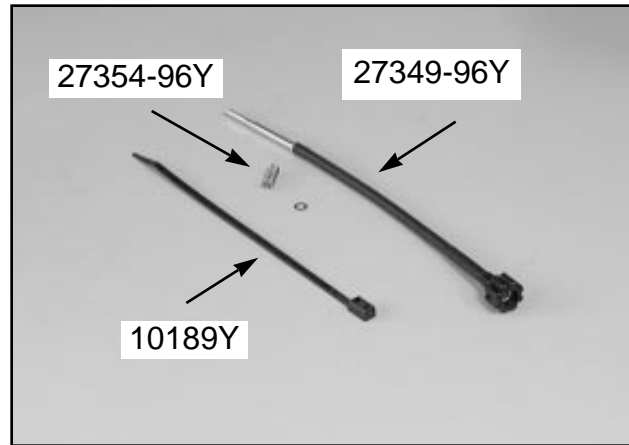

S2-T Tail Section Mounting Hardware

There was a change to the fiberglass tail section mounting hardware on all S2-T models built after December 1995. The parts changes are shown in the figure below.

- | <u>OLD</u> | <u>NEW</u> |
|-------------------------|---------------------------------|
| 1. 2860Y - Screw | 1. 2510Y - Screw (longer) |
| 2. 58235-94Y - Clip Nut | 2. 7524Y - Nut & 6735Y - Washer |

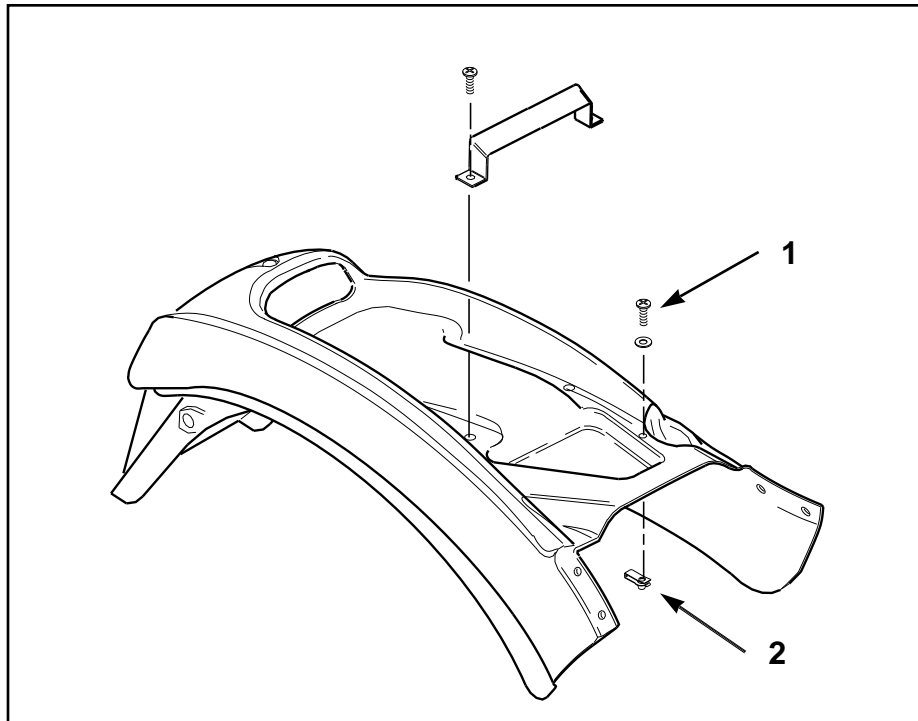

VIN Changes

In preparation for expanding World markets, the following changes to the VIN numbering sequence have been implemented.

	<u>S2-Thunderbolt</u>	<u>S2-T</u>	<u>S1-Lightning</u>
World model	001- 019	100-119	200-219
California model	020- 024	220-224	220-224



EXAMPLE: 4MZRT11H*T3 **000 0**37

Literature Update

The S1-Lightning Owner's Manual has been updated and reprinted. Copies can be ordered using part number 99477-96YB.

Front Caliper Piston Removal Tool

A newly released service tool makes it safe and easy to remove all six brake pistons when servicing front brake calipers.

Part number, B-42079, is available through Kent-Moore Tool. The cost is \$56.50.



Rear Suspension Compressing Tool

A new rear shock compressing tool has been released for both S2 and S1 models. The part number is B-41178A.

